

OUTLANDER LIFTS

FULL
DE
XL
TM

OWNER'S MANUAL & WARRANTY INFORMATION

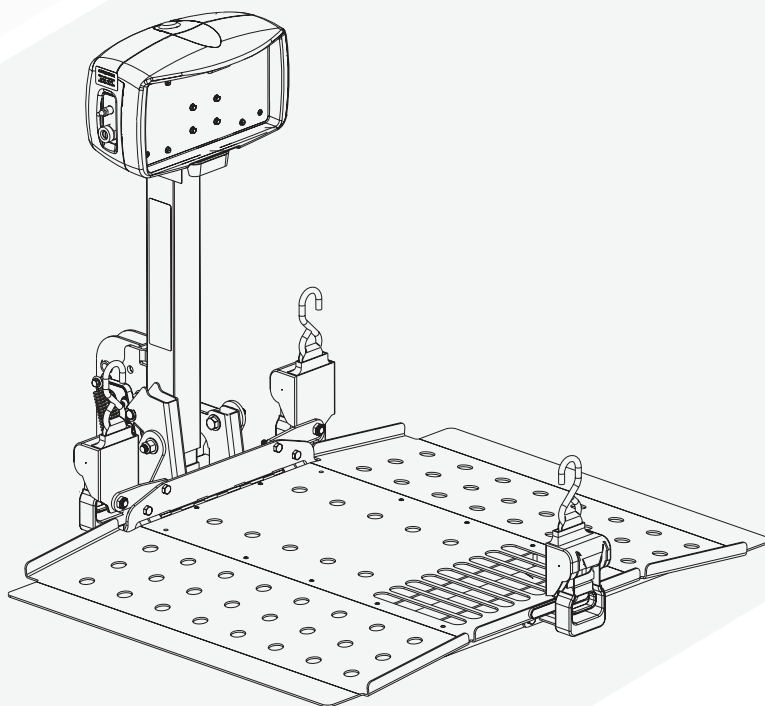

Outlander Full with
retractable strap
option pictured

PARAGON
from  HARMAR

THANK YOU

From all of us at Harmar, thank you for placing your trust in our products and allowing us to be a part of your journey.

For more than 20 years we have been committed to building products that help you maintain independence. With a drive to empower people to live as they choose, Harmar Lifts Lives.

Beyond vehicle lifts, like the one you've purchased, Harmar designs and manufactures Vertical Platform Lifts, award-winning Stair Lifts, and more.

We strive to be the leading provider of lift-assisting technology in your home and on the road.

Visit [harmar.com](https://www.harmar.com) or speak to your dealer about the other solutions available from Harmar.

Table of Contents

INTRODUCTION 4
 Device Name: Paragon Outlander Vehicle Lift 4
 Read and Understand 4
 Purchasing Information 4
 Technical Specifications 4
 General Information 4

SAFETY 6
 Safety Definitions 6

OPERATION 7
 Special Cautions 7
 Lowering the Lift 8
 Positioning the Mobility Device onto the Platform 8
 Securing the Mobility Device Outlander Full 9
 Raising the Lift 9
 Unloading the Chair 10
 Stowing the Platform 10
 Swing-Away 10
 Opening the Swing-Away 11
 Closing the Swing-Away 12

MAINTENANCE 13

TROUBLESHOOTING 14
 Manual Override 14

**MOTOR COVERING
WIRING SCHEMATIC 15**

WARRANTY..... 16

Section 1

Introduction

DEVICE NAME: PARAGON OUTLANDER VEHICLE LIFTS

Indications of Use: The intended use of Paragon Outlander vehicle lifts is to lift a mobility device for patients or mobility-impaired persons on and off a vehicle.

READ AND UNDERSTAND

This manual provides instructions for proper use and maintenance of your outside vehicle lift. Please refer to this owner's manual for operating instructions. Any alterations to the equipment without written authorization by the manufacturer will void the warranty.

PURCHASING INFORMATION

If you have questions concerning the operation and maintenance of your Paragon Outlander vehicle lift, please contact your dealer.

Please ensure that you fill out the separate warranty form and return it within ten (10) days of purchase to register your lift.

TECHNICAL SPECIFICATIONS

Visit harmar.com for specifications on your lift model.

GENERAL INFORMATION

This lift is meant to transport a wheelchair, power chair or scooter (also referred to as a mobility device or chair) on and off a vehicle for a mobility-impaired person. Operation outside the intended use will void the warranty.

Consider the following general information when using your lift. Specifics may vary based on your chair model and lift combination.

- Always make certain your lift is fully deployed and flush with the ground prior to loading your mobility device.
- Ensure you have positioned the chair properly on the platform and that it is secured on the lift before transport.
- Always verify wheels are captured by cradles or aligned evenly on the platform. Also ensure the securement device is fully engaged (hold-down foot, straps, or hold-down arm. Please consult your dealer on the specifics of your application if you have questions.
- Always drive slowly over rough terrain such as potholes, unpaved roads, railroad tracks, speed bumps or other uneven surfaces. Excessive loads and rough driving will damage your lift and will not be covered by the warranty.
- Stop using the lift immediately if you notice any damage. Do not attempt to transport a mobility device with a compromised lift. Damage to your chair, lift and/or vehicle may occur. Contact your dealer and ask for an evaluation of the lift prior to further use.
- Always check to make sure nobody is in the process of getting on or off the mobility device before operating the lift.
- Always verify the mobility device is held firmly in place prior to transport.
- Never attempt to move the vehicle without the lift being in the full upright or stowed position, as this may damage the lift.

Section 2

Safety

SAFETY DEFINITIONS



This safety alert symbol appears with safety statements. It means attention, become alert, your safety is involved! Please read and abide by the message that follows the safety alert symbol.

WARNING

Indicates a hazardous situation that, if not avoided, could result in death or serious injury.

CAUTION

Indicates a hazardous situation that, if not avoided, could result in minor or moderate injury.

NOTICE

Indicates a situation which can cause damage to the lift and/or the environment, or cause the lift to operate improperly.

NOTE: Indicates a condition that should be followed in order for the lift to function in the manner intended.

Section 3 Operation

WARNING

This lift is **NOT** meant for human transportation. Any use other than the intended use identified will **VOID** the warranty and could result in personal injury. The chair or scooter **MUST** be unoccupied before operating the lift. Each lift is designed to transport a specific chair only. **DO NOT** attempt to move any mobility devices, objects, people, animals or materials other than those for which the lift was designed.

Drive with **EXTREME CARE** while transporting your chair or scooter on the lift to avoid personal injury.

CAUTION

You must hand wash or use touchless automatic car wash to prevent lift damage.



Figure 3-1

SPECIAL CAUTIONS



Pay attention to the following special cautions while operating your chair or scooter.

- **Return the hold-down arm to a side position before folding the platform for model SSES1011: Outlander Full.** Failure to do so will damage your lift.
- **Beware of pinch points.** These are areas of moving parts that can catch extremities or clothing. Do not place fingers, extremities, clothing or jewelry near pinch points.
- **Keep hands, feet and objects away** from the platform as it lowers.
- **Keep the chair tires properly inflated.** Improper inflation will change how the chair fits and secures on the platform and will change the securement pressure.
- **Secure the chair firmly before driving.** Double-check to confirm that the chair is secured properly before you transport it.
- **Inspect the lift condition often.** If ANY parts are worn or damaged, **DO NOT USE THE LIFT.** Immediately contact the dealer that you purchased the lift from to schedule repairs.
- **Do not enter steep driveways straight on.** Enter and leave at an angle to the street so that the lift does not drag on the ground.
- **Do not move the vehicle with the platform down.** If you move the vehicle with the platform in the DOWN position, you will damage the lift and vehicle.
- **Hand-wash or use a touch-less automatic car wash only on the lift.** To prevent lift damage **DO NOT** use automatic wash systems.

OUTLANDER VEHICLE LIFTS: SECTION 3

OPERATION

LOWERING THE LIFT

1. Insert the key and turn the switch to the ON position.
2. Press DOWN on the toggle switch. The platform will unfold, as the lift is lowered.
3. Continue to lower the platform until it reaches the ground and becomes level. *See Figure 3-2.*

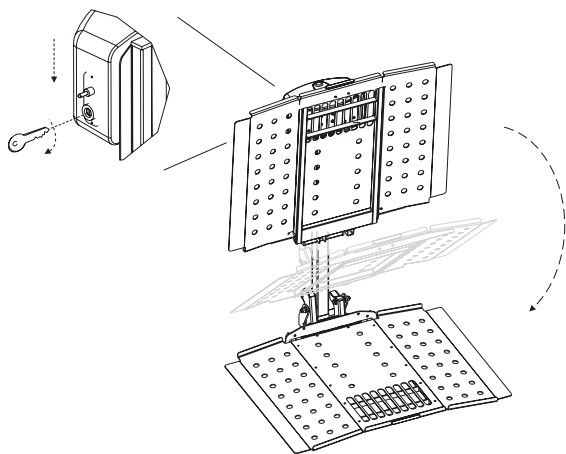

Figure 3-2

NOTICE

DO NOT over-lower the platform to the point where the vehicle begins to rise. This will damage the lift.

POSITIONING THE MOBILITY DEVICE ONTO THE PLATFORM

1. Position your mobility device slowly.
2. Stop positioning when the drive wheels fall between the wheel cradles or wheel chocks on the side or center, depending on the lift and chair model. *See Figure 3-3.*

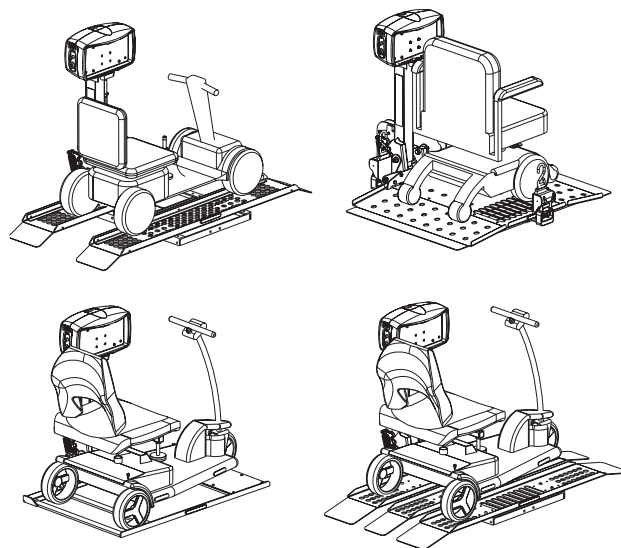

Figure 3-3

IMPORTANT: Positioning the mobility device properly on the platform is critical to ensuring the device is properly locked onto the lift. Always verify that the wheels are captured by wheel cradles or wheel chocks. Please consult your dealer on the specifics of your application.

SECURING THE MOBILITY DEVICE OUTLANDER FULL

For the Outlander Full, the type of securement device it uses, you may wish to raise the platform halfway by using the UP toggle switch. If you raise the platform, you won't have to bend over while you attach straps or flip the chair's armrest out of the way of the hold-down arm. See Figure 3-4.

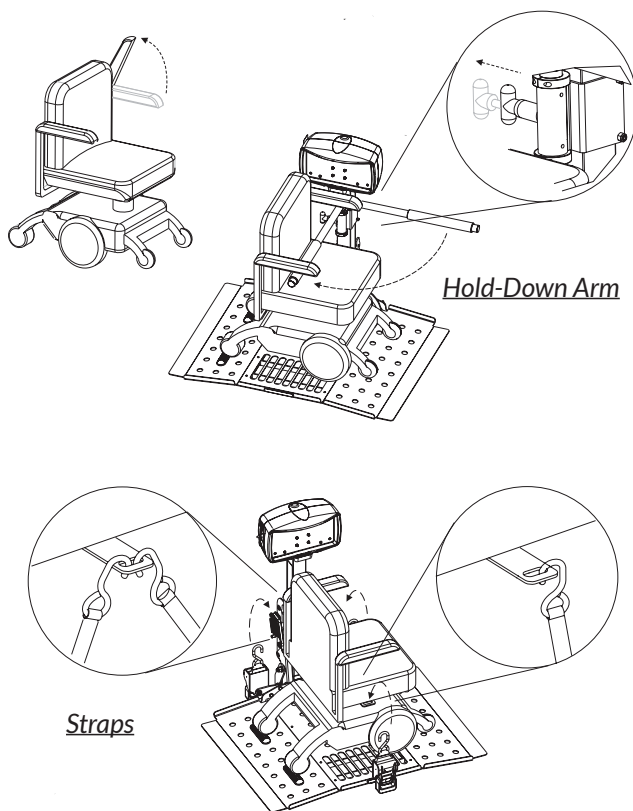

Figure 3-4

NOTICE

Ensure that the securement system (whether it's a hold-down arm, hold-down foot or straps) has enough tension to secure the device.

Notes for scooter lifts with a hold-down foot assembly

On some scooters, it may be necessary to temporarily move the steering tiller forward to clear the hold-down foot as it lowers into the lock-down position.

NOTICE

Some scooters have pneumatic (air-inflated) tires. If your scooter has this type of tire, be sure the tires are properly inflated. Improper inflation will change the deck height of the scooter and therefore change the amount of clamping force the hold-down arm places on the scooter. The scooter can fall off the lift if not properly secured.

RAISING THE LIFT

1. When the mobility device is secure, use the UP toggle switch to continue raising the lift.
2. Stop raising the lift when it reaches the top of travel and when you hear the clicking or ratcheting sound.
3. Remove the key. See Figure 3-5.

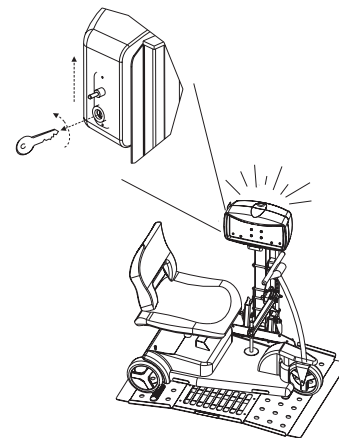

Figure 3-5

OUTLANDER VEHICLE LIFTS: SECTION 3

OPERATION

UNLOADING THE CHAIR

1. Insert the key and turn the switch to the ON position.
2. Press DOWN on the toggle switch to lower the lift.
3. Release/move the hold-down devices that are not automatic.

NOTE: Make sure any automatic securement devices are fully disengaged prior to removing the chair from the platform.

4. Guide the chair off the platform carefully.

NOTE: Always drive the scooter off the platform in REVERSE. When the scooter is clear of the platform, press the UP toggle switch to raise the platform.

STOWING THE PLATFORM

When the mobility device is unloaded, press UP on the toggle switch and the platform will automatically fold. See Figure 3-6.

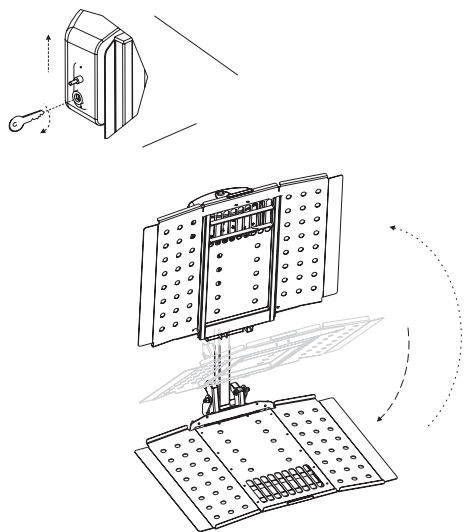

Figure 3-6

NOTICE

DO NOT leave the lift platform on the ground. Keep the platform in its stowed position when not in use or when leaving the vehicle.

SWING-AWAY

The swing-away allows you to easily swing the installed auto lift away from the back of the vehicle for convenient access to the trunk/cargo area. If your device does not have a swing-away, you may purchase this option from an authorized dealer and have it added at any time.

NOTICE

NEVER open the swing-away with the chair on the lift. You will damage the swing-away and the lift and will potentially damage the vehicle and the mobility device. Any of these actions will VOID your warranty. See Figure 3-7.

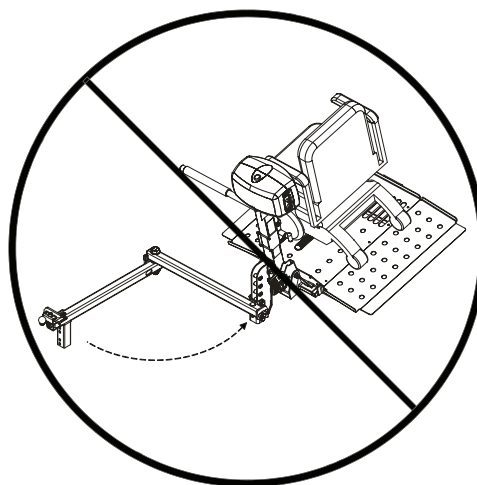

Figure 3-7

WARNING

ONLY open the swing-away on level ground. Failure to open the swing-away on level ground may result in losing control of the lift, resulting in personal injury or damage to property. See Figure 3-8.

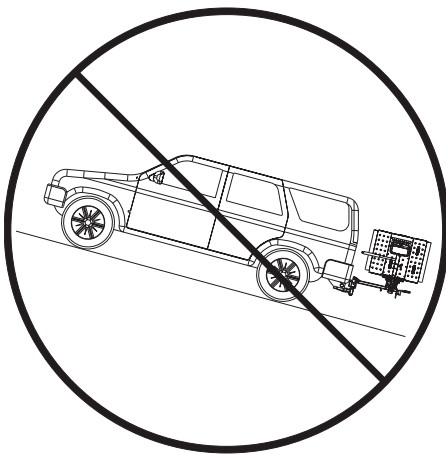

Figure 3-8

OPENING THE SWING-AWAY

1. Remove the safety pin. See Figure 3-9.

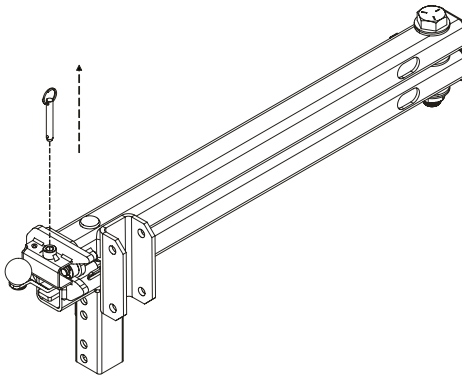

Figure 3-9

2. Push red latch ball. See Figure 3-10.

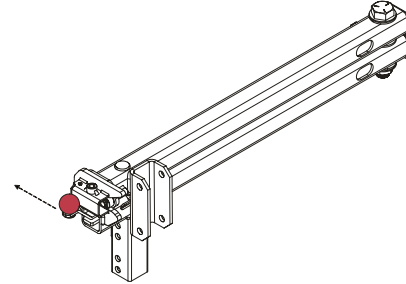

Figure 3-10

3. Grasp the lift firmly and swing it out, away from the vehicle. The swing-away opens up to allow full access to the vehicle's cargo area. See Figure 3-11.

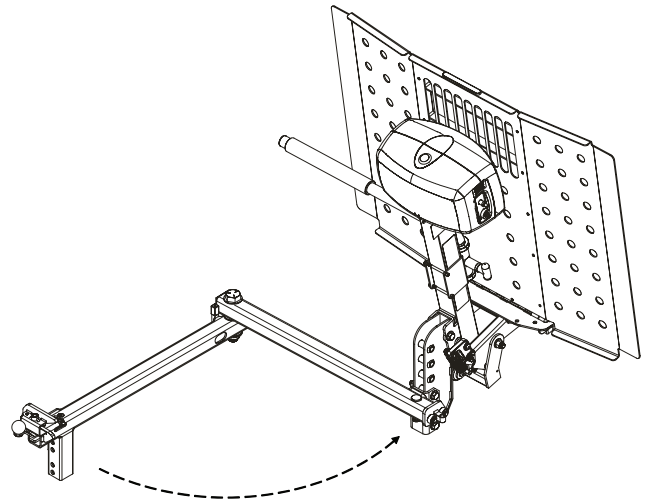

Figure 3-11

OUTLANDER VEHICLE LIFTS: SECTION 3 OPERATION

CLOSING THE SWING-AWAY

Close the swing-away by returning it to the stowed position. *See Figure 3-12.*

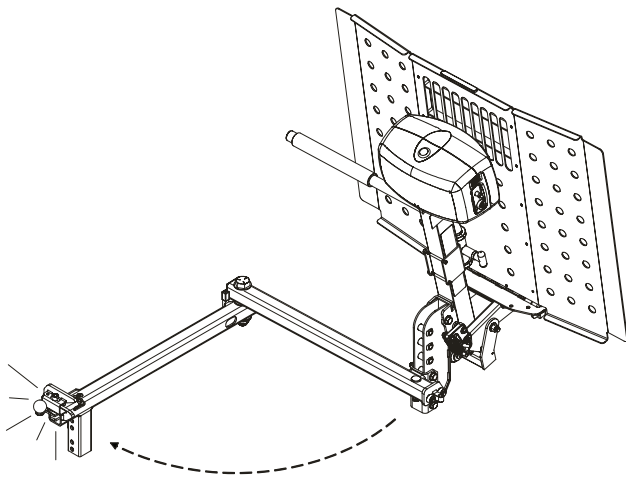

Figure 3-12

1. The swing-away will latch itself when closed. When properly latched the ball will move forward. *See Figure 3-13.*

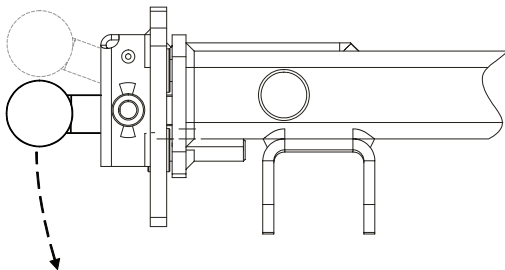

Figure 3-13

WARNING

Verify that the swing-away is properly latched by trying to reopen the swing-away without unlatching a few times.

2. Install the safety pin. Be sure that the safety pin is fully inserted to the ring. *See Figures 3-14 and 3-15.*

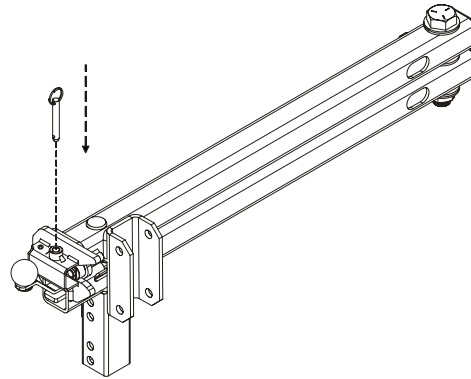

Figure 3-14

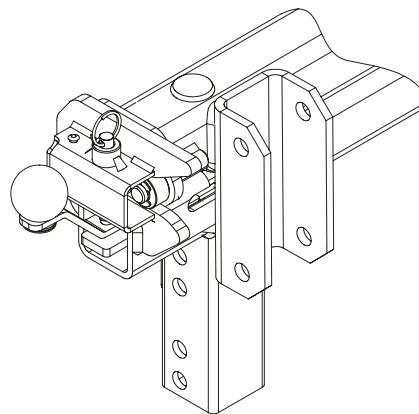

Figure 3-15

WARNING

Be sure to stay clear, keeping fingers, hands and clothing away from the latching mechanism to avoid personal injury. *See Figure 3-12.*

Safety pin must be installed before transit to avoid damage and injury. *See Figure 3-14.*

Section 4 Maintenance

This outside vehicle lift is designed to be as trouble free as possible. However, some basic maintenance will ensure that it continues to offer reliable use for years to come.

- Oil pivot points on all moving parts every Six (6) months.
- Grease the inside vertical square tube once a year (every six [6] months under hard conditions or extreme weather). Lower the platform to the ground and clean the tube with mineral spirits, WD-40® or a good solvent. When clean, grease the square vertical tube shaft with high-grade water-resistant grease such as boat trailer wheel-bearing grease. **See Figure 4-1.**

NOTICE

Some scooters have pneumatic (air-inflated) tires. If your scooter has this type of tire, ensure the tires are properly inflated. Improper inflation will change the deck height of the scooter and therefore change the amount of clamping force the hold-down arm places on the scooter. The scooter can fall off the lift if not properly secured.

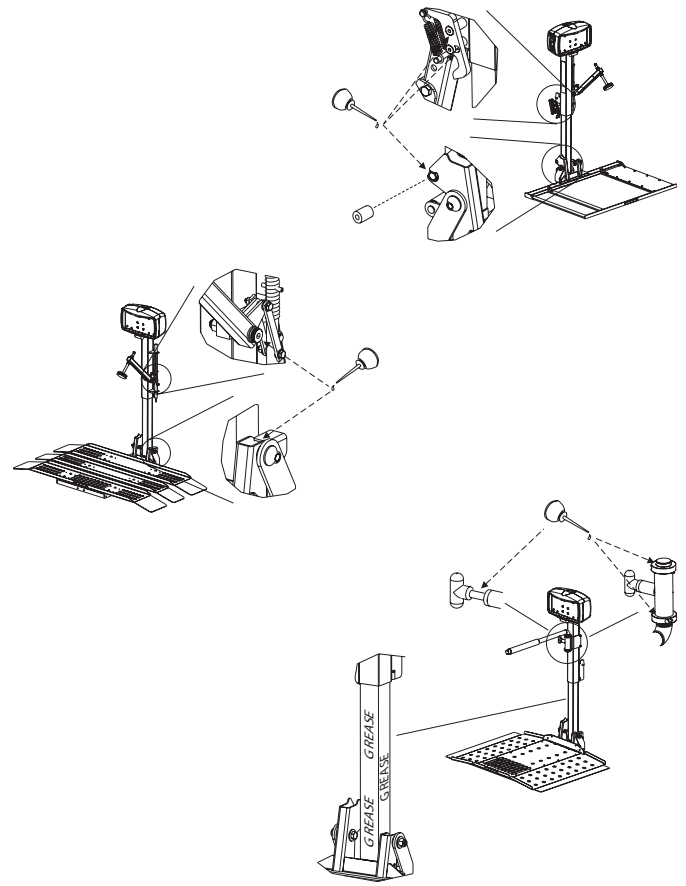

Figure 4-1

- Check for paint chips and touch up bare metal. Use a good black enamel or lacquer to inhibit rust. You may need to do this more frequently if your lift is subject to salty air or road salt in the winter.

Section 5

Troubleshooting

If the lift doesn't have power when you turn the key on:

- Make sure the lift harness and vehicle harness are connected.
- Make sure the self-resettable circuit breaker on the red wire by the battery is good.
- Try starting the car to see if the battery is weak.

If the lift makes a ratcheting noise as you are raising it:

- Unplug the lift, take the round black plug off the top of the motor cover and use a 3/8" socket to manually lower the lift. (See manual override instructions below.)
- If the actuator just spins and doesn't move down or up, take the lift to a dealer.

NOTE: Before changing mobility device, check with the dealer to make sure the scooter is compatible with the lift and vehicle.

MANUAL OVERRIDE

In the event of a power failure (for example, if your car battery dies), you can still lift or lower the lift using the manual override system.



WARNING

Always disconnect the power from the lift by unplugging the two connector plugs before attempting to use the manual override to avoid electrical shock.

1. Unplug power to the lift. *See Figure 5-1.*

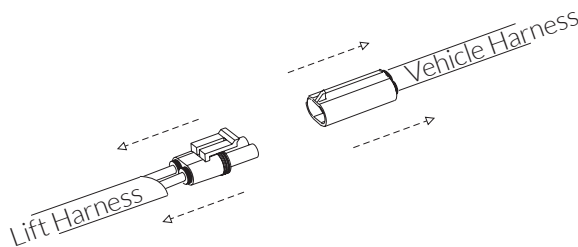

Figure 5-1

2. Using a coin or key, remove the cap on the top of the motor cover. *See Figure 5-2.*

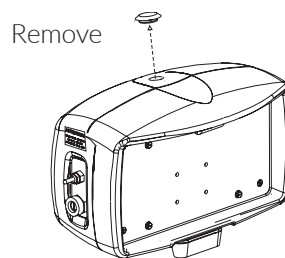

Figure 5-2

3. Insert a 3/8" socket wrench into the actuator and rotate the hex shaft. *See Figure 5-3.*

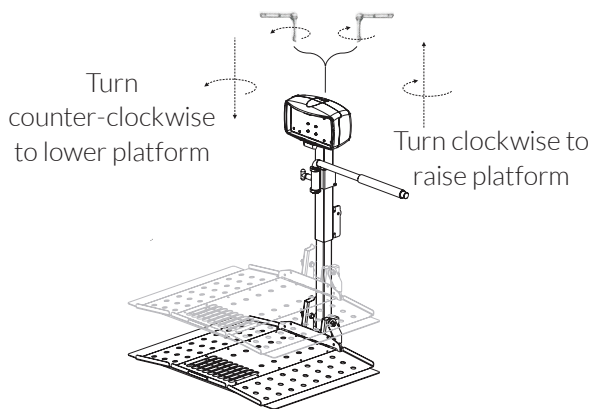
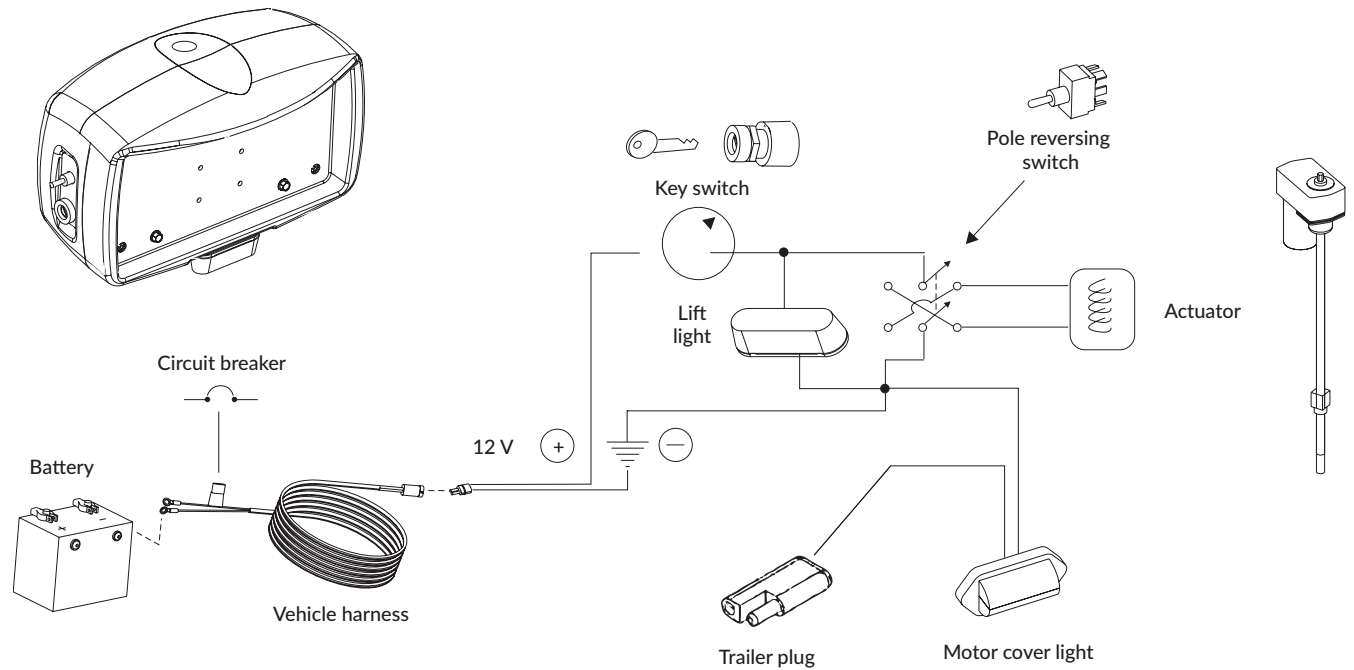

Figure 5-3

- Turn the hex shaft **counterclockwise** to **lower** the platform.
- Turn the hex shaft **clockwise** to **raise** the platform.

Section 6

Motor Cover Wiring Schematic



Section 7

3-Year Transferable Warranty

Your lift came with a separate warranty page. You must turn this page in within ten (10) days of purchase to register your lift.

Mail your completed form to:

Harmar
2075 47th Street
Sarasota, FL 34234

This warranty policy page must remain in your owner's manual for your records. Do not tear out this page.

Dealer/Installer Name: _____

Address: _____

Phone: _____

E-Mail: _____

If you need service or warranty work, your dealer will require the information below to receive factory information or order parts for your Paragon Outlander vehicle lifts.

Date Purchased: _____

Serial # of the Lift: _____

Harmar Mobility warrants its lift products against defects in material, mechanical and electrical component (parts), excluding labor costs, batteries, paint and covers, for a period of three (3) years from date of retail purchase, provided that the products have been installed, maintained and operated properly. This warranty does not cover defects in vehicles on which Harmar products are installed or defects in Harmar products caused by defects in any part of the vehicle upon which the product is installed. This warranty does not cover maintenance or adjustments. Harmar will not be charged for labor, consequential damage or repair expenses. Harmar will not, under any circumstances, be liable for the loss of the use of its products or loss of time. This warranty becomes null and void if the product has been lost, damaged by accident, over stressed, misused and/or neglected, or if the product has been modified in any way. Defective parts must be returned, prepaid, to Harmar at the address listed above, for inspection prior to credit, repair or replacement, at Harmar's option. Harmar's sole obligation and the exclusive remedy under this warranty is limited to such credit, repair or replacement.

THIS EXPRESS WARRANTY IS IN LIEU OF ALL OTHER WARRANTIES OR CONDITIONS, INCLUDING ALL IMPLIED WARRANTIES OR MERCHANTABILITY OR FITNESS FOR A PARTICULAR PURPOSE, AND THERE ARE NO WARRANTIES THAT EXTEND BEYOND THE DESCRIPTION OF THE LIMITED WARRANTY DESCRIBED HEREIN. THIS WARRANTY GIVES YOU SPECIFIC LEGAL RIGHTS AND YOU MAY ALSO HAVE OTHER LEGAL RIGHTS WHICH VARY FROM STATE TO STATE.

OUTLANDER VEHICLE LIFTS: SECTION 7

WARRANTY

PRODUCT INFORMATION

Model: _____

Serial Number: _____

Purchase Date: _____

INSTALLER INFORMATION

Company Name: _____

Contact Name: _____

Address: _____

Phone: _____

Fax: _____

Email: _____

APPLICATION INFORMATION

☐ Scooter ☐ Power Chair ☐ Wheelchair

Year: _____

Manufacturer: _____

Model: _____

PURCHASER INFORMATION

Name: _____

Address: _____

Phone: _____

Email: _____

ADDITIONAL INFORMATION

How did you hear about Harmar?

☐ Harmar Dealer

☐ Internet

☐ Magazine

Which _____

☐ Friend or Acquaintance

☐ Saw Harmar product somewhere

☐ Other _____

I purchased my Harmar lift because of

☐ Style/Appearance

☐ Harmar Representative

☐ Previous Experience

☐ Ease of Use

☐ Recommendation

☐ Price/Value

OUTLANDER VEHICLE LIFTS: SECTION 7

WARRANTY

This page intentionally left blank

PARAGON
from  HARMAR

2075 47th Street | Sarasota, FL 34234
800.833.0478
harmar.com