

**SMART
TRANSFER**
Range

T-MPL

User & Installation Manual



Safety Guidelines



WARNING! - Authorized technicians & installers are to complete the initial set up of this device. All Installation instructions must be followed.

The following symbols are used to identify warnings and important details throughout this manual. Please read them and ensure you are aware of their meaning.



WARNING! - These symbols denote a potentially dangerous situation. Failure to carry out the specified procedures may result in injury or damage to the device.



MANDATORY! - The indicated actions must be carried out as specified. Failure to perform the specified actions may result in injury or damage to the device.



PROHIBITED! - Do not carry out the indicated actions. They should not be performed at any time, under any circumstances. Carrying out a prohibited action may result in injury or damage to the unit.

Please fill out the following details for quick reference:

Authorized Dealer: _____

Address: _____

Phone Number: _____ **Purchase Date:** _____

Serial Number: _____ **Order Number:** _____

NOTE: This owner's manual is compiled from the latest specifications and product information available at the time of publication. We reserve the right to make changes as they become necessary. Any changes to our products may cause slight variations between the illustrations and explanations in this manual and the product you have purchased.

NOTE: This product is compliant with WEEE, RoHS, and REACH directives and requirements.



Copyright © 2018
Autochair Ltd.
1214296 Rev. B

Manufactured By:

Autochair Ltd
Wood Street North
Meadow Lane Industrial Estate
Alfreton
Derbyshire
DE55 7JR

Distributed By:

Mobility Innovations LLC.
51277 Celeste
Shelby Township
MI 48315



USER MANUAL



1. INTRODUCTION	4
2. SAFETY	5
3. TECHNICAL	8
4. OPERATION	11
5. ACCESSORIES	16
6. TROUBLESHOOTING	18
7. CARE & MAINTENANCE	20
8. WARRANTY	21

INSTALLATION MANUAL



9. COMPONENTS	24
10. INSTALLING	26
11. CILL BRACKET	31
12. WIRING	34
13. NOTES	35



1. Introduction

Congratulations on the purchase of your new Person Lift manufactured by Autochair.

Please read through these instructions thoroughly before operating this product.

These instructions were produced for your benefit. Your understanding of these instructions is essential for the safe operation of your new lift system.

Autochair is not liable for damage to property or personal injury arising out of the unsafe use of a lift system. Autochair is also not liable for any property damage or personal injury arising out of the failure of any person and/or user to follow the instructions and recommendations set forth in this manual or any other instructions or recommendations contained in other lift system related literature issued by Autochair or contained on the lift system itself.

Please note that your Person Lift comes complete with a warranty as detailed in your contract. This warranty covers the replacement of any faulty parts and the labor for replacing those parts. The warranty does not cover travel costs.

THIRD PARTY AND PRIVATE PURCHASES

If you purchased your product from a seller not affiliated with Autochair or from a previous owner and require any information about the safe use and maintenance of your Person Lift, please contact your Authorized Dealer.

END-USER'S AGREEMENT

By accepting delivery of the Person Lift, you agree that you will not modify, change or alter this Person Lift or remove or render inoperable or unsafe any guards, shields, or other safety features of this product; fail, refuse, or neglect to install any retrofit kits from time to time provided by Autochair to enhance or preserve the safe use of this product.

DELIVERY AND SHIPPING

Before using or operating your Person Lift make sure your delivery is complete. Some components may be individually packaged. If you do not receive a complete delivery or if any damage has occurred to the Person Lift or packaging whilst in transit, please contact your Authorized Dealer. Upon delivery of your new Person Lift; your Authorized Dealer should provide a demonstration on the correct use of the product.

FEEDBACK AND SUGGESTIONS

We want to hear your questions, comments, and suggestions about this manual. We would also like to hear about the safety and reliability of your new Person Lift and about the service you received from your Authorized Dealer.

Please notify us of any change of address, so we can keep you apprised of important information about safety, new products, and new options that could improve your ability to use and enjoy your lift system. Please feel free to contact us at the address below:

Distributed By:

Mobility Innovations LLC.
51277 Celeste
Shelby Township
MI 48315



1 800 488 7688



service@mobilityinnovators.com



www.mobilityinnovators.com

2. Safety



Product Safety Symbols

Please study the symbols below to ensure you understand them completely. They are used on the Person Lift and in the manual to identify warnings and mandatory or prohibited actions.



Read and follow all directions in this manual.



Maximum user weight. Maximum lifting capacity at its minimum extension. See table on page 8 for lifting capacity for all extensions.



Pinch/Crush points on the Person Lift. Keep hands and fingers away from moving components and crush points when operating the Person Lift.



Battery posts, terminals and related accessories contain lead and lead compounds. Wear goggles and gloves when handling batteries and wash hands after handling.



Disposal and recycling. Contact your Authorized Dealer for information on proper disposal of your Person Lift and its packaging.





2. Safety

WEIGHT LIMITATIONS

The lift system is designed to lift a maximum user weight of 330lb (150kg). Depending on the way the lift system is set up for the vehicle, this maximum weight limit may be reduced. Please refer to the specification table to check the maximum capacity for your specific installation. Keep in mind that the maximum weight capacity includes the combined weight of the user and any accessories mounted to the lift arm.

INSTALLATION

	MANDATORY! Stay within the specified weight capacity of the lift system. Exceeding the weight capacity voids your warranty. Autochair will not be held responsible for injuries and/or property damage resulting from failure to observe weight limitations.
	WARNING! This Person Lift is only intended to be installed by an Authorized Dealer or qualified technician. Read and fully understand the manual prior to installation.

NON-AUTOCHAIR PRODUCTS

Use only the sling provided with the Person Lift. Additional/specialist slings can be purchase from an Authorized Dealer. Other slings by different manufacturers may have a different balance point, different attachment points and will not be suitable for use with this type of device. Autochair accepts no liability for damage or injury caused by the use of inappropriate slings.

PRE-LIFT INSPECTION

There should be no sharp edges on either the Person Lift or the fitting kit. If you find any sharp edges, please contact your Authorized Dealer before use.

Please make sure that you are completely happy with the operation of the Person Lift before operating it yourself. Misuse of the product could result in injury.

Inspect the sling and straps before every use for twisting, fraying or signs of wear. If signs of wear become evident, have the sling replaced by your Authorized Dealer. Check that the buckles have not moved and that the positioning of the person being lifted is correct at the start of the lift. Refer to the technical section for the correct method of threading the straps through the buckles to avoid slipping.

	WARNING! A frayed or worn strap can snap, resulting in injury to the person being lifted and/or the operator. Do not use a damaged sling.
---	--

2. Safety



OPERATOR POSITIONING

Keep hands clear of the lift arms during motion. The Person Lift is only doing the lifting, control the lateral movement using the handle on the back of the sling. Stand close to the person being lifted to be able to safely control their movement, refer to the operating instructions for detailed guidance.

KEY SAFETY POINTS



WARNING! The purpose of this product is to transfer a person simply, safely and with a degree of comfort, from a wheelchair or powerchair to a vehicle or other seat and vice versa. It must not be used for any other purpose.



WARNING! Ensure all straps are set correctly. All metal clips are positively located on their lugs before lifting. Do not lift/lower at the same time as transferring the person into and out of the vehicle.



WARNING! Note the position of all pinch point warning labels stating “Keep Clear”. Never place your hands in these locations when the Person Lift is in operation.



WARNING! Keep hands, clothing and electrical cord of hand control clear of all moving parts during lifting/lowering operations. The handset can be placed on top of the lift arm when not in use. Do not use the handset whilst it is attached to the body of the lift.



WARNING! Avoid catching the handset cord in the car door or moving parts, resulting in damage to the cord and loss of hoist function.



WARNING! During wet weather avoid getting the electrical connection and vicinity wet.



WARNING! Never use a system that has signs of damage.



WARNING! Do not exceed maximum lifting capacity.

Your Person Lift should be inspected at least every year by a qualified person.

If any of the above safety hazards occur please contact your Authorized Dealer as soon as possible

Remember: The Person Lift is only doing the lifting, it does not control the lateral movement of the lift. The operator **MUST ALWAYS** keep a hand on the lift to control the lateral movement of the person being transferred. Failure to do so may result in injury.



3. Technical

PRODUCT SPECIFICATIONS

Weight of the lifting arm:	18.7lb (8.5kg)
Maximum lifting capacity:	330lb (150kg)
Maximum range of lift:	21"
Power supply:	12v DC
Maximum current draw:	20 Amps
Product materials:	Aluminum & Mild/Stainless Steel
Material Finish:	Powder coated - Carbon Grey
Slings:	Standard - XS, S, M, L, XL Double Amputee - S, M, L Fleece Lined - M, L Net - S, M, L
Sling Material:	Polyester

Extension Setting	Lift (inch)	Lift (mm)	Max User Weight (lb)	Max User Weight (kg)	Stone
Maximum Extension	24.06	611	260	118	18.5
5 Holes Visible	22.83	580	269	122	19.2
4 Holes Visible	21.57	548	280	127	20
3 Holes Visible	20.35	517	291	132	20.8
2 Holes Visible	19.13	486	304	138	21.7
1 Hole Visible	17.91	455	317	144	22.6
Minimum Extension	16.69	424	330	150	23.8

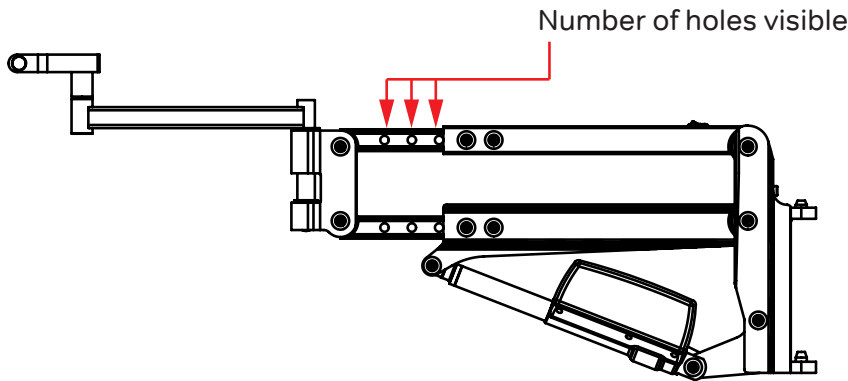

3. Technical



SLINGS

The slings come in various sizes, all rated at 385lb (175kg) weight capacity, which are color coded on the sling edges as follows;

Extra Small	- White
Small	- Yellow
Medium	- Green
Large	- Red
Extra Large	- Blue



The lifting straps of the sling should be adjusted so that each strap is as short as possible, giving the best lift and the most maneuverability for the person.

The correctly adjusted sling should lift the person, in a seated position at lower chest height and not above the shoulder height or at waist height. If there is a lot of slack in the straps when the sling is connected to the 'spreader bar', they should be shortened. The slacker the straps are when connected, the less the range of lift that can be achieved and the sling will also not offer as much support.

The sling supplied with the Person Lift is determined during your initial assessment. However, if it does not suit, or you have not had an assessment, please consult your Authorized Dealer.

When you wash your Person Lift Sling, you must remove the buckles and the webbing anchors – failure to do so may result in damage to your washing machine. Your sling can be washed at up to 167°F (75°C).

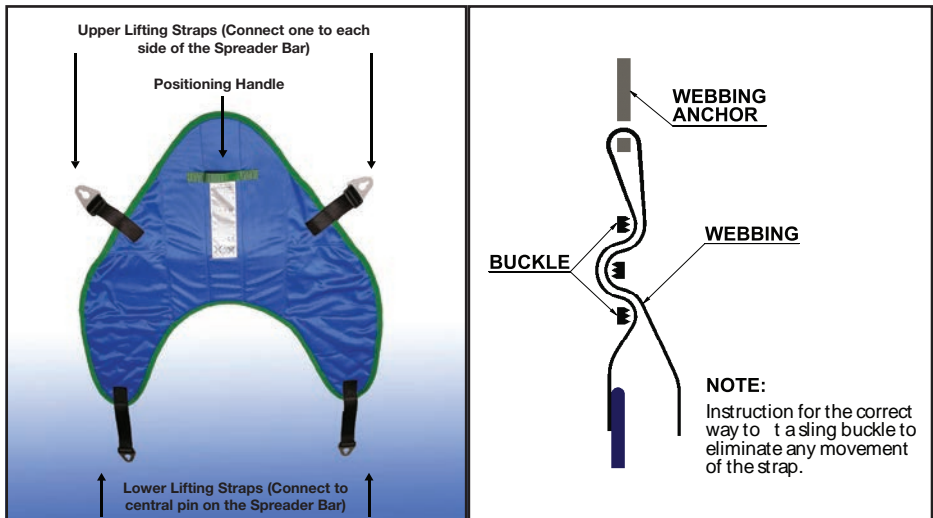



3. Technical

COMPONENT DESCRIPTION

SOCKET

The Standard Person Lift power socket is located at the side of the mounting post (shown fitted into a vehicle). The cord on the lift should be directly connected.



HANDSET

The Handset is simple and easy to use, with one button for Up and one for Down. Releasing the button stops lifting or lowering.



ARM

Once the person is seated, remove the spreader bar, extension arm and lift arm and place in the storage bag for use upon arrival at your destination.



STORAGE BAG

The large carry bag is supplied with the Person Lift to store the lift arm, extension arm, spreader bar and sling when not in use.



4. Operation - Entering



ENTERING THE VEHICLE

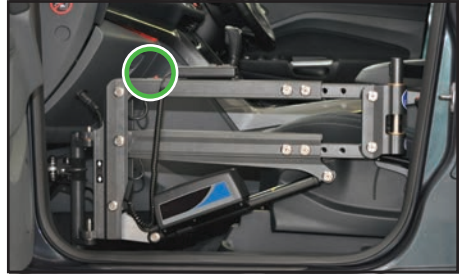

1. Mount the lift arm, extension arm and spreader bar. Rest the lower mounting lug on the longer lower pin before aligning the top pin.* The arm should slide into place smoothly. Switch the lift on.



***WARNING!** Ensure that both pins are engaged and the lift arm rotates freely.



2. Position the lift arm and the person being lifted.



3. A) Connect the leg straps first.



3. B) Then connect the side straps.



4. Operation - Entering



4. Raise the person off the seat (remember to keep lateral control when lifting).



5. Using the handle on the back of the sling, maneuver the person closer to the vehicle.



6. Position their legs over the door sill as shown.



7. Begin to guide the person into the vehicle, knees first.



8. If necessary, lower the lift until the person rests against the edge of the seat; this may help them to duck their head into the vehicle.



9. Lift again until the person being moved is free of the seat. (Do not lift too high when inside the vehicle, as this could cause injury).

4. Operation - Entering



10. Once inside the vehicle, position the person comfortably in the seat.



11. Lower the lift arm until the sling straps are slack then disconnect the straps in the reverse order to connecting.



12. Remove the Person Lift and store it securely in the boot of the vehicle.



4. Operation - Exiting

EXITING THE VEHICLE



1. Mount the lift arm, extension arm and spreader bar.



2. Connect the sling straps. First connect the leg straps (A), then the side straps (B).



3. Begin to slowly raise the person up out of the seat.



4. Begin to move them over the edge of the seat. It may be necessary to lower them slightly as they are coming out of the vehicle.



5. Continue to move the person completely out of the vehicle.



6. Take their feet out from over the sill.

4. Operation - Exiting



WARNING! It may be necessary to help the person's feet from the vehicle depending on the height of the user, lift setting and vehicle door sill. Be careful to avoid any strain on the person, equipment or you. Lifting the person higher than appears necessary at this stage helps when moving their feet out of the vehicle



7. Lower onto the wheelchair. Lift up on the rear sling strap to help get the person into a good sitting position.

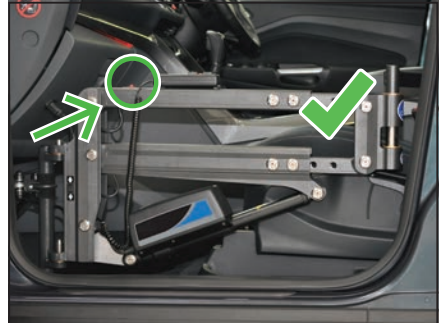

8. Switch the Person Lift off and store in the boot if necessary*.



***WARNING!** Never travel with the lift arm in place!



5. Accessories

PERSON LIFT ACCESSORIES

This Person Lift is available with a range of accessories to make it even more versatile and suitable for use around the home, office or even on holiday. If you'd like to extend the usefulness of your Person Lift with any of our available Accessories; please get in touch with your Authorized Dealer and ask them about their available range.

The T-SB

A versatile mobile base unit for the Person Lift

The T-SB is a mobile base unit that enables the Person Lift to be used in the home, at work or even on holiday. The T-SB unit is collapsible and easily transportable system that allows simple transfers from one sitting position to another whenever and wherever you like.

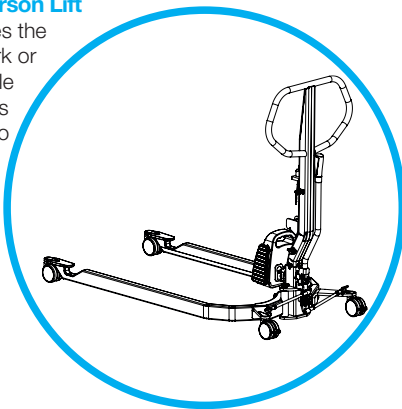

Wall Bracket

Sturdy mounting system for the Person Lift

The Wall Bracket allows seated transfers from one point to another whilst in the home. Securely mounted to the wall studs; the Wall Bracket enables transfers in and around the home such as in bathrooms and bedrooms.

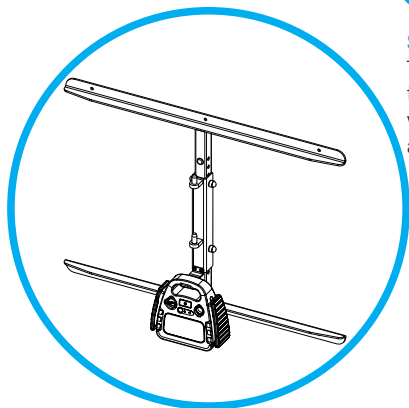

5. Accessories



Person Lift Sling Options

Sling sizes and options for any requirements

The Person Lift is available with a wide range of sling sizes and arrangements making it suitable for the requirements of almost any user. Slings come in sizes from X-Small to X-Large and are available in a range of materials such as standard polyester, fleece lined for extra comfort and net for greater breathability.

Slings are even available in amputee and double amputee layouts for greater comfort and safety when lifting & transferring.



Multiple Person Lift Installs & Set Ups

Use your Person Lift in as many cars as you require

Your Person Lift is not specific to one car. That means if you have a second car or need to be lifted into another vehicle, all that's required is a mounting post installed in your second (or third, fourth, fifth etc.) vehicle and you can swap your Person Lift between them at your discretion.

Available with the Person Lift are a range of extensions & drop arms to make the Person Lift suitable for use in an even greater range of vehicles. Combinations of extensions and drop arms can be used to give the Person Lift the necessary reach for use in even larger 4x4s and people carriers as well as sports cars and convertibles.



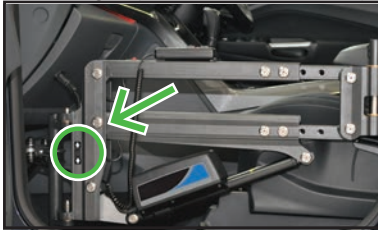

6. Troubleshooting

Problem	Solution
Will not lift high enough	<ul style="list-style-type: none">• Is the lifting arm extended to the correct length?<ul style="list-style-type: none">- This should only be done by a qualified person.• Are the straps on the sling set to the correct length?<ul style="list-style-type: none">- They should be set as short as possible.
The unit will not lift	<ul style="list-style-type: none">• Is the handset light on? If no, is the unit switched on?• Unit is switched on, but no light?• Is it plugged in and switched on, but still does not work?• Is the battery dead?• Is a fuse blown? (The fuse is next to the battery)• Fuse has not blown but still no power – A visible check of all connections and wires to make sure that a wire has not been cut, crushed or come loose.
The handset does not work	<ul style="list-style-type: none">• Has the handset connector come out? If so, reconnect it.• If not, has the connector at the other end of the handset cord come out of the socket?<ul style="list-style-type: none">- If so, replace.• Has the cord to the handset been damaged?<ul style="list-style-type: none">- If yes, use the emergency Up/Down buttons to operate:- Emergency buttons are indicated by the arrow below; 
Person is uncomfortable when lifted	<ul style="list-style-type: none">• Confirm that the sling is correctly positioned and not twisted under their legs.• If all material is even, then adjusting the straps may alleviate discomfort.
Person Lift is lifting very slowly	<ul style="list-style-type: none">• Is the person too heavy for the lift? 330lb (150kg) is the maximum safe working load. (See page 8 or 21)• If the Person Lift is extended; refer to the technical section to check the lift capacity for the setting.• Is the vehicle's battery charged?
What servicing is available?	<ul style="list-style-type: none">• We recommend yearly servicing to ensure your Person Lift is safe and reliable
What if we have an accident?	<ul style="list-style-type: none">• If you think that your Person Lift has been damaged in any way please call your Authorized Dealer to arrange an inspection and safety test.

If you can't find a solution to your problem, before operating the Person Lift please contact your Authorized Dealer as soon as possible. Their details will be written on the inside cover and the back page of this manual. If you do not have their contact details, get in touch with us and we'll let you know who your Accredited Dealer is and how to get in touch with them.

6. Troubleshooting



WARNING! The orientation of the person should be as shown in the instructions at all times during lift operation. **The following images show the CORRECT and INCORRECT** sling settings. A poorly set up sling could cause discomfort to the person being lifted. It will also be difficult to use the lift properly and get the person seated correctly. If this occurs, lower the person back into their seat and adjust the sling ensuring the sling and straps are correctly positioned.



This sling has been adjusted incorrectly. The leg straps are too short causing the person to be positioned away from the spreader bar. To correct this, lower the person to a safe position, check that the leg supports of the sling are positioned correctly and adjust the leg and side straps as necessary.



This sling has not been pushed far enough down the person's back before attaching the leg straps. This provides less support for the person being lifted and the leg straps will be uncomfortably tight. To correct this, lower the person to a safe position, pull the sling lower at the back before repositioning the leg supports checking that they are spread evenly under the thigh.



The **CORRECT** sling setting



7. Care and Maintenance

Care and Maintenance

The following routine maintenance should be performed at the indicated intervals. Failure to perform the maintenance procedures at the required intervals may void Autochair's product warranty.

Perform prior to daily use:

- Inspect slings, buckles and straps and replace if necessary.
- Inspect the sling and lift for damage and replace if necessary.
- Check electrical cords and connections for signs of damage.

Perform at least every 6 months:

Inspect all mounting hardware and lift pivots for defects and a secure fit. Any hardware found to be loose should be tightened or replaced if necessary. If in doubt contact your Authorized Dealer.

Perform every 12 months:

- It is recommended that the Person Lift is serviced every year by your Authorized Dealer.

Cleaning:

The slings can be washed in a washing machine. (See page 9 or Care Instructions on Sling Label)

If required the Person Lift can be cleaned with a damp cloth and detergent. Ensure the unit is disconnected before cleaning.

Do not immerse the Person Lift in water, do not allow water to run into the electrical connectors or control box and allow to dry before use.

8. Warranty



Product Warranty

The warranty period for your Person Lift is detailed in your contract.

This warranty **will cover** any **defects of workmanship or function**.

The warranty **does not cover** any incorrectly installed Person Lifts or one with damaged mechanical or electrical components due to incorrect use or damage.

The warranty does not cover consequential loss, unless regional law requires it.

The warranty is invalidated if the seal on either the actuator or control box is broken. These contain no user replaceable components. No alteration should be made to the Person Lift by anyone other than a qualified person, as defined by an Authorized Dealer.

In the event of damage or defects in the actuator, the Person Lift should be returned to your Authorized Dealer for evaluation.

No wires must be cut as they are fitted with connectors that must be correctly removed before repair. In the event of any malfunction of the electrical circuit box or handset which require replacement, they should be removed and returned as a set.

Please ask your Installer to fill in this section

Please keep a note of the following:

Serial Number: _____

Date Supplied: _____

Details of the Supplier: _____

Postcode: _____

Telephone: _____

Holes Shown	Max (lb)	Tick Setting Used
0	330	
1	317	
2	304	
3	291	
4	280	
5	269	
6	260	

User Weight: _____ Signed: _____

If this changes, please check with your Authorized Dealer

Installation Manual



The following section is for Authorized Dealers.

It contains information relevant to the installation of your Person Lift.

ANY MODIFICATIONS OR ADJUSTMENTS TO YOUR PERSON LIFT MUST BE CARRIED OUT BY AN AUTHORIZED DEALER ONLY. DO NOT ATTEMPT TO ADJUST THE PERSON LIFT BY YOURSELF.

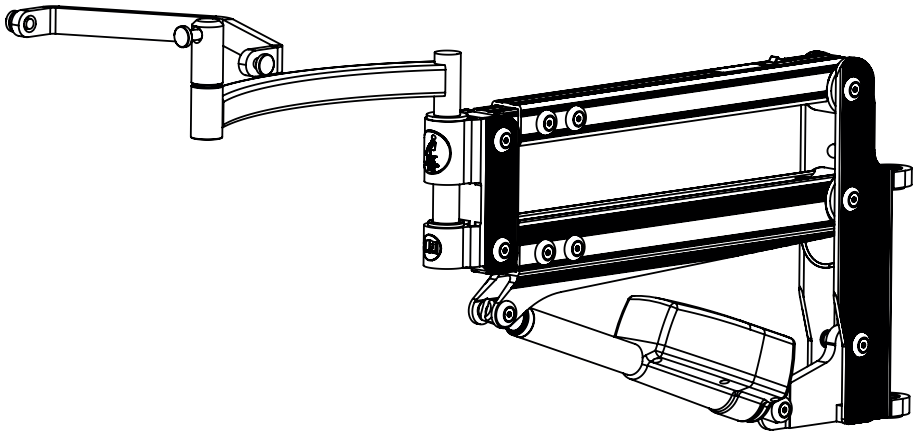

**SMART
TRANSFER**
Range

T-MPL

Installation Manual



9. Components

FITTING KIT PART ID

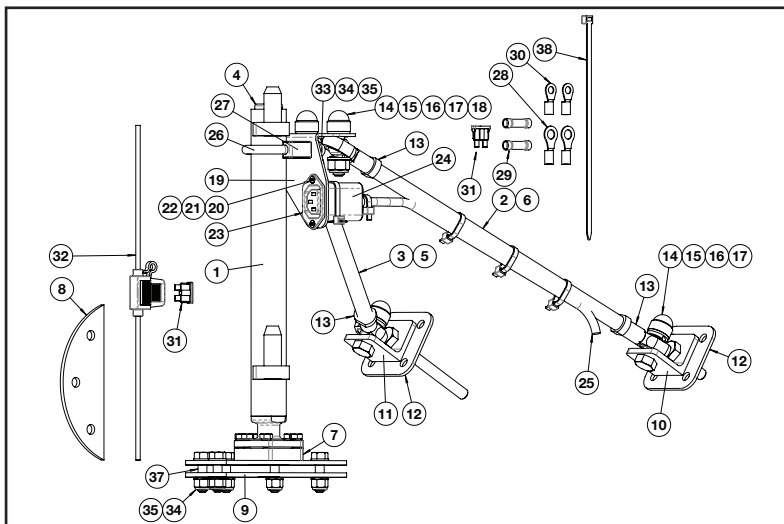

NO.	ITEM DESCRIPTION
1	MPL Mounting Post
2	Sleeve 27.56" (700mm)
3	Sleeve 11.81" (300mm)
4	Tube Insert
5	M10 Allthread 11.81" (300mm)
6	M10 Allthread 27.56" (700mm)
7	Mounting Post Base
8	Small Mounting Plate
9	Large Mounting Plate
10	Bulkhead Bracket
11	Bulkhead Bracket (Long Setscrew)
12	5 Hole Clamp Plate
13	M10 Rod End
14	M10 Nut Cap
15	M10 Spring Washer
16	M10 Flat Washer
17	M10 Nyloc Nut
18	M10x40 Hexagon Head Screw
19	RH Socket Mounting Plate

NO.	ITEM DESCRIPTION
20	M3x12 Countersunk Screw
21	M3 Flat Washer
22	M3 Nyloc Nut
23	Kettle Plug
24	Rubber Boot
25	Cable
26	Exhaust Clamp 1.26" (32mm)
27	Saddle Block
28	Large Yellow Ring Connector
29	Yellow Straight Connector
30	Small Yellow Ring Connector
31	25amp Fuse
32	Splashproof Fuse Holder
33	M8 Nut Cap
34	M8 Flat Washer
35	M8 Nyloc Nut
36	M8x50 Hex Head Screw
37	M8x30 Hex Head Screw
38	Cable Tie

9. Components



PERSON LIFT PART ID

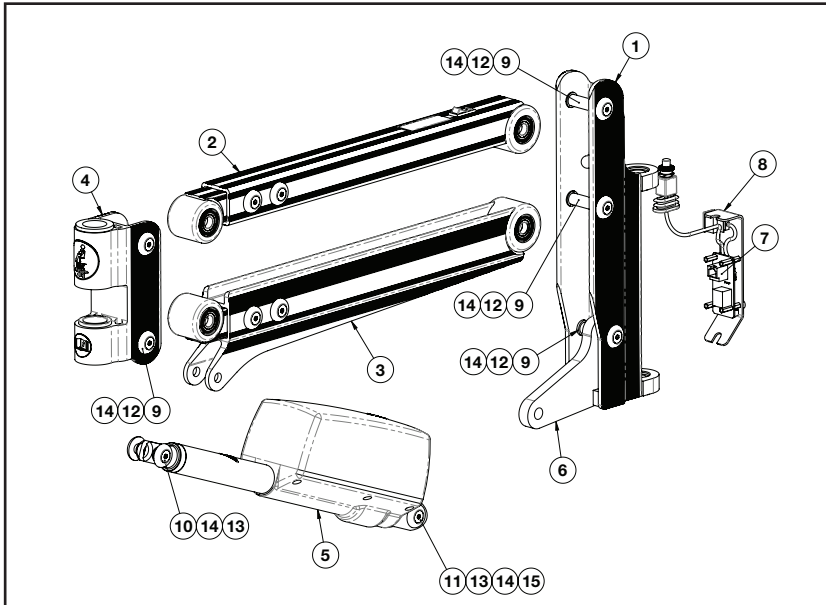

NO.	ITEM DESCRIPTION
1	Rear Post Assembly
2	Upper Arm Assembly
3	Lower Arm Assembly
4	Front Post Assembly
5	330lb (150kg) Actuator
6	Actuator Support Plate
7	Control Board & Switches
8	Control Board Cover
9	Front Post Pin
10	Spacer 0.39x1.81" (10x46mm)
11	Spacer 0.47x1.41" (12x35.8mm)
12	Bush - Flanged
13	Bush
14	Socket C'Sunk Capscrew M6x16
15	Actuator Spacer



10. Installing

POST BASE & POST ASSEMBLY

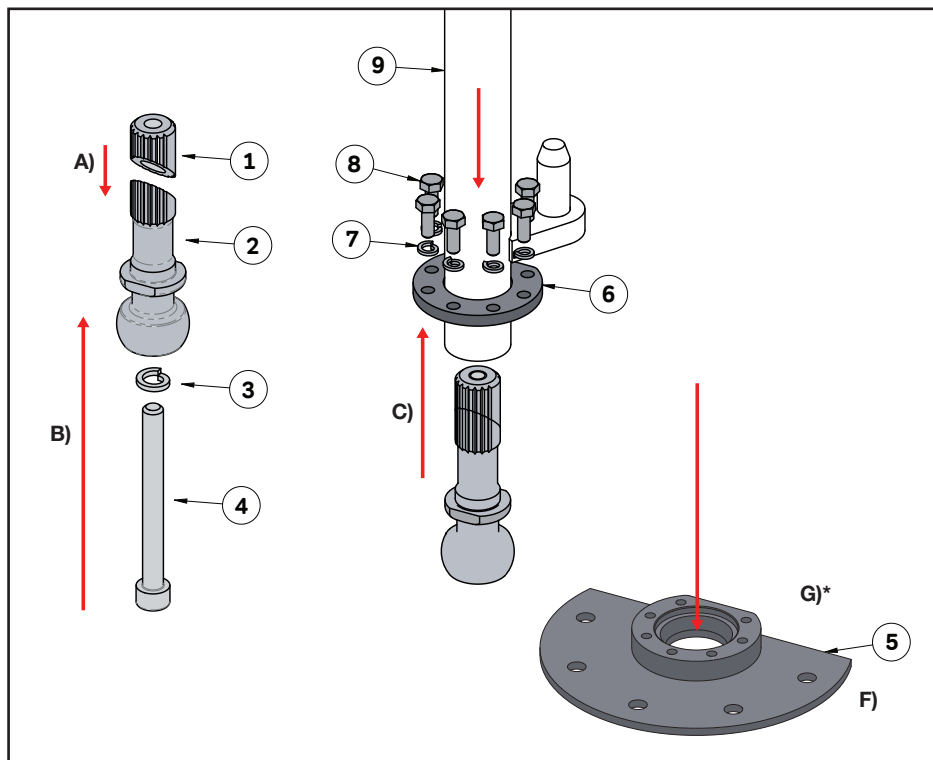

NO.	ITEM DESCRIPTION
1	Post Taper Nut
2	Ball Joint
3	M10 Spring Washer
4	M10x100 Cap Screw
5	Post Base Fabrication
6	Cap Taper Plate
7	M6 Spring Washer
8	M6x16 Hex Head
9	Mounting Post

A) Place 1 onto 2.

B) Place 3 onto 4 and insert through 2, screwing into 1.

C) Following **Step 5** (next page), locate through 6 and push 9 onto the parts assembled (Ball Joint).

D) Tighten 4 to **44.25ft-lb (60Nm)** (**See next page**).

E) Leave assembled parts to one side.

F) Install Base Plate into the vehicle following instructions on the next page.

G) Insert assembled parts into base plate & tighten 8 through 7 and into baseplate **EVENLY***

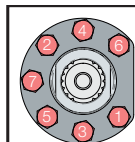

***WARNING** - Ensure that 8 (M6x16 Hex Head Screws) are evenly fastened using the sequence illustrated in the diagram to the left.



10. Installing

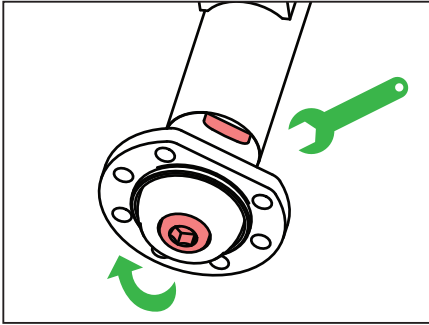

D) CONTINUED Whilst keeping the post secure, use a spanner to hold the flats (highlighted) and tighten **4** securely using appropriate Allen Key. This bolt must be very tight 44.25ft-lb (60Nm), which may cause some bulging of the post.

POST INSTALLATION - BOTTOM MOUNTING



ATTENTION!
If a Cill Bracket is required turn to Section 11 (Page 31)

1. Remove the relevant vehicle trim and carpet in the location that the Post Base will be fitted.

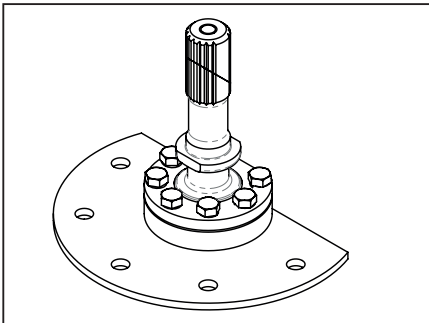

2. **Loosely** assemble the Post Base following the instructions on the previous page (**A, B, G**).

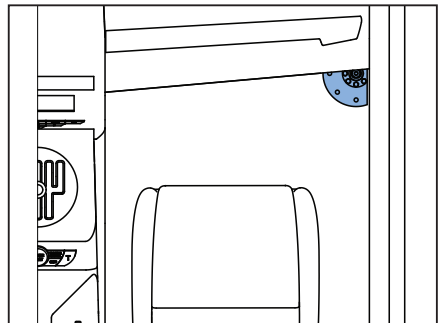

3. Position the Post Base assembly as close to the door sill and the dashboard as possible.

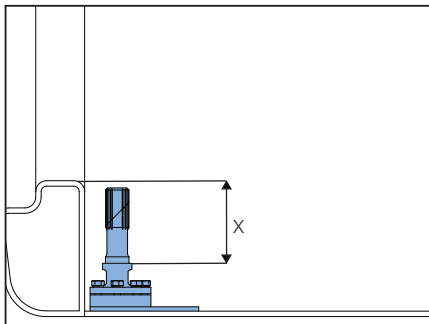

4. Measure "X" from the top of the Post Base to the top of the Sill.

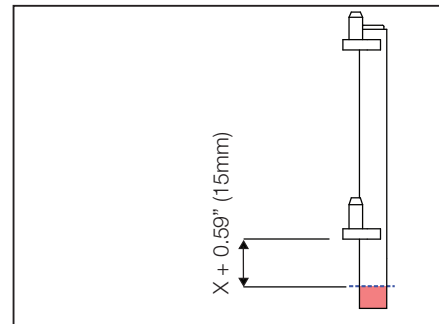

5. Measure "X" down from the lower mounting pin plate, add 0.59" (15mm) allowance for any trim that has been removed from the sill. Mark and cut the Post at this distance.



10. Installing

6. Disassemble the Post Base parts and assemble to steps **A-G on Page 26**. Do not fully tighten **8** (M6 Setscrews).

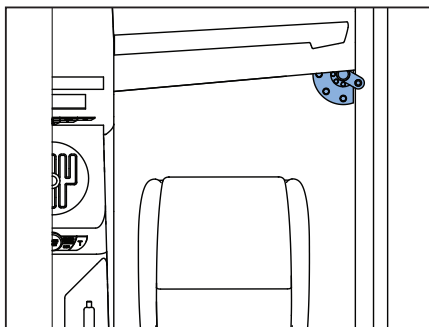
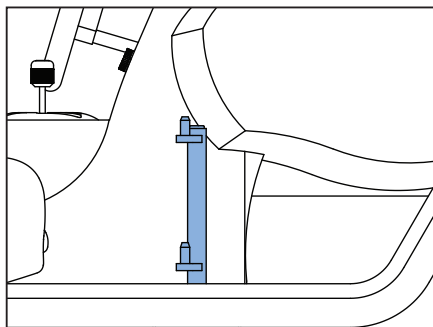

7. Position the Mounting Post and Post Base as near to the vehicle dashboard as possible ensuring that clearance is allowed for the Person Lift to be hooked on & off. Also check the Person Lift clears the corner of the vehicle dash as it rotates on its fixings and that the post will not contact the door when closed.



WARNING! Check that the Post Base is on as flat a surface as possible. Before drilling any mounting holes check for brake and fuel lines, wiring harnesses etc.

8. Remove the Mounting Post from the Post Base Assembly.

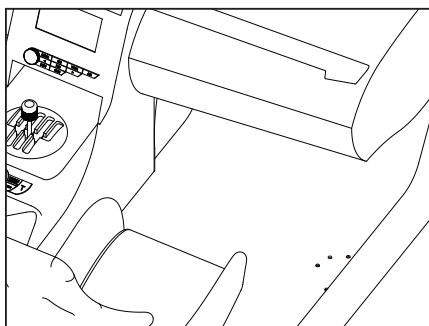
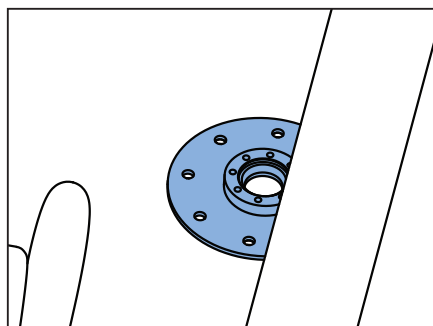

9. Find suitable points for securing the Post Base to the vehicle floor. Check the Post is vertical then mark the five points.

10. Remove the Post Base and drill the vehicle floor through 0.3543" (9mm) for M8 Setscrews.

10. Installing

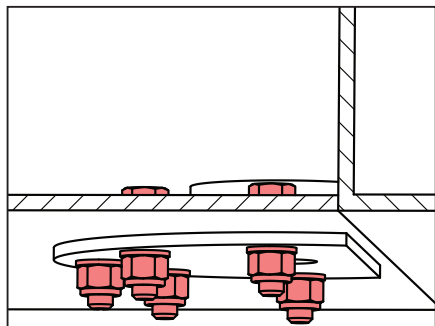

11. Fix the Post and Base into the pre-determined position using M8 x 30 Hexagon Setscrews and Nyloc Nuts with washers. Ensure that the flat mounting plate is secured beneath the vehicle floor using sealer to prevent the ingress of water.

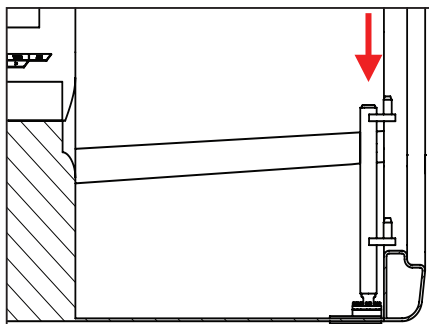

12. With the Post and Ball Joint already assembled (**See Page 26, Steps A-D**), set the angle and tighten the Cap Plate **6** down **EVENLY*** using **7** and **8** to 7.38ft-lb (10Nm).

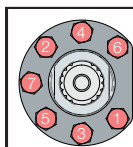

***WARNING** - Ensure that **8** (M6x16 Hex Head Screws) are evenly fastened using the sequence illustrated in the diagram to the left.

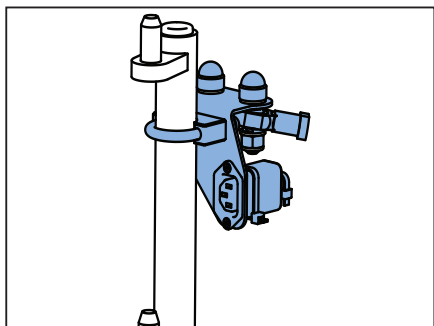

13. Loosely assemble the top mounting in the ideal position.

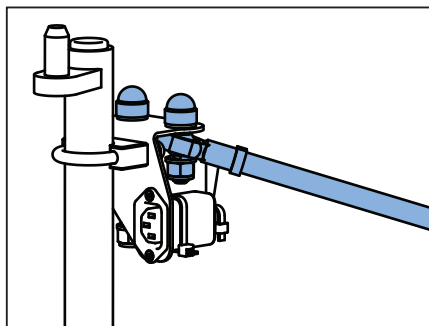

14. Trial the short Brace Bars in the Rose Joints and check that the bars will not foul the dash board. Locate and mark two suitable positions for the Transition Brackets to mount checking there are no obstructions on the other side of the panels such as wiring, brake or fuel lines etc.



10. Installing

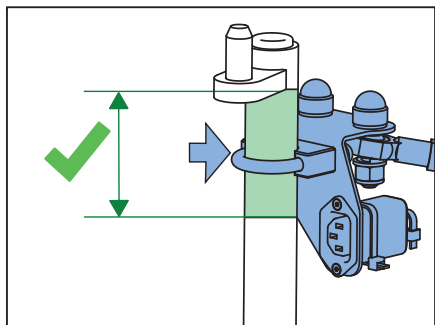

15. The brace bars should be spread as wide as possible. Suitable locations for the transition brackets are the vehicle bulkhead, transmission tunnel and wheel arch. The higher up the post and the further apart they are, the more stable the post installation will be.

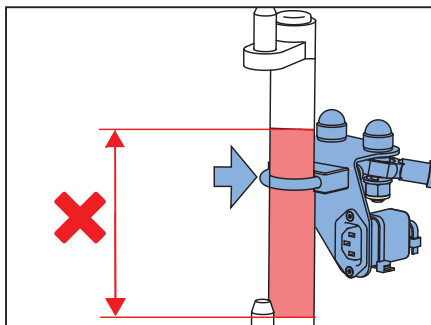

15. CONTINUED - When fitting the Brace Bar U Clamp ensure it is as high up the mounting post as possible.

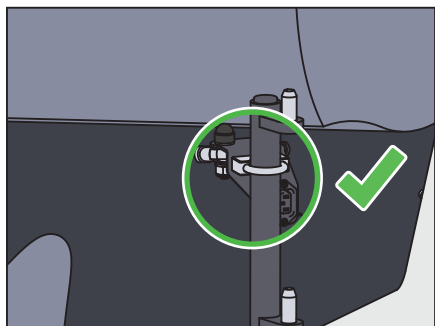

10. Installing



POST INSTALLATION - TOP MOUNTING

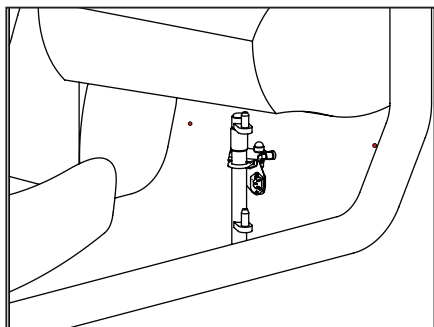

16. Drill two holes $\varnothing 0.4134"$ (10.5mm).

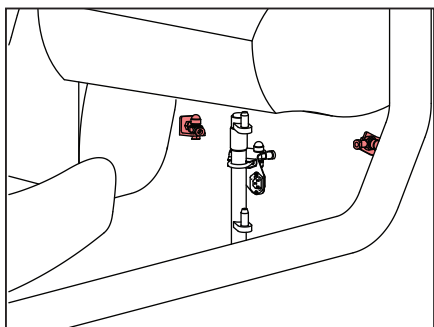

18. Fit the Brackets through the bulkhead.

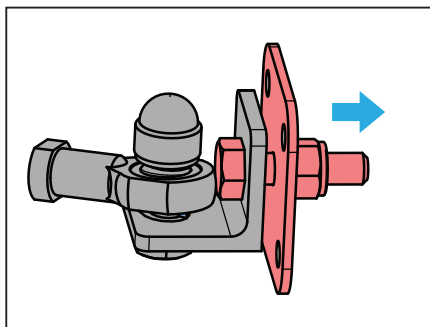

17. Remove the five hole plate and Nyloc Nut from the Transition Bracket.

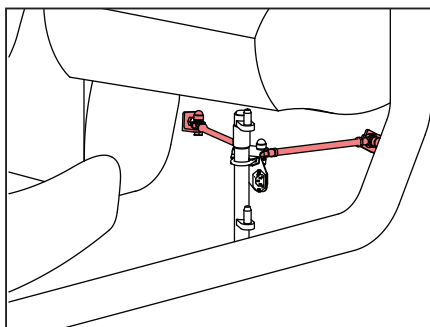

19. Carefully measure and cut the threaded rod and sleeve. Then fit them between the rod ends. Once all parts are installed correctly, fully tighten all the fixings.

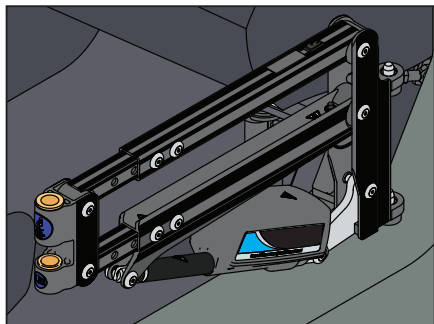

20. Route the wiring, fit all the plastic nut caps and refit all the trim and carpet.

21. The Person Lift should be fitted to the Post and the stability tested before using to lift a person. Once some weight has been applied to the installation check all the fixings are tight.

22. Removal of the Fitting Kit is the reverse of the installation.



11. Cill Bracket - OPTIONAL

Cill Bracket INSTALLATION

When installing a Person Lift; it may be necessary to use a Cill Bracket in order to clear large or unusually shaped door Cills or to fit around an extended or protruding dashboard. The following instructions should be used to ensure the Cill Bracket is correctly and safely installed in the vehicle. **The Cill Bracket is OPTIONAL and isn't part of every install.**

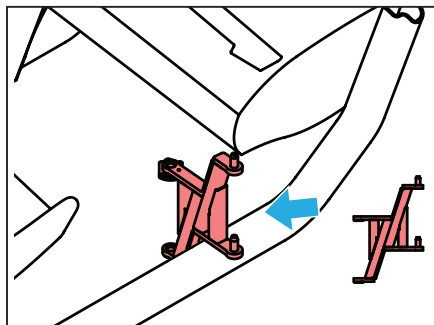

22. Offer Cill Bracket into vehicle in it's approximate intended position

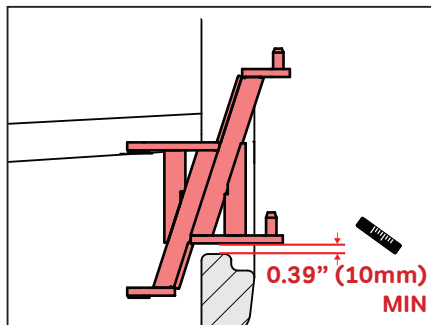

23. Ensure a minimum 0.39" (10mm) gap as shown (TIP: Use a suitably sized packer to support Bracket)

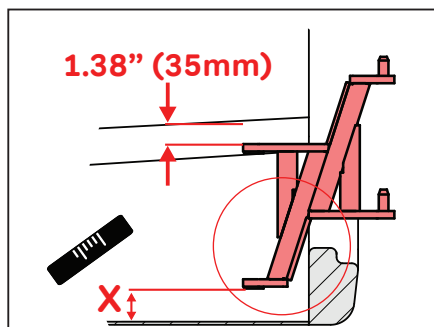

24. Ensure there is a minimum clearance of 35mm between Bracket and dash (for Bracket removal after Post installation) as shown.

Whilst maintaining 0.39" (10mm) from the Cill as shown in Step 23 carefully measure X as shown in Step 23 carefully measure X (the gap between floor and lower section of Bracket).

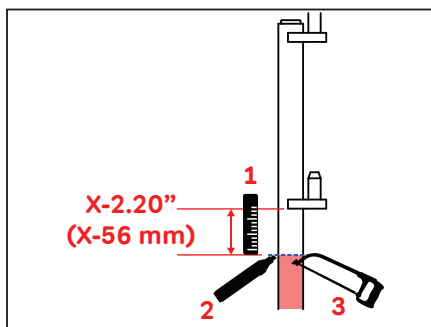

25. Measure and mark the Post as shown.

11. Cill Bracket - OPTIONAL

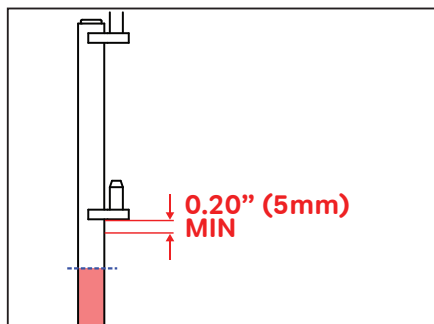

25. CONTINUED - DO NOT remove more than the 0.20" (5mm) Minimum. If X- 2.2 (X-56) = less than 0.20" (5mm) then 0.20" (5mm) must be used.

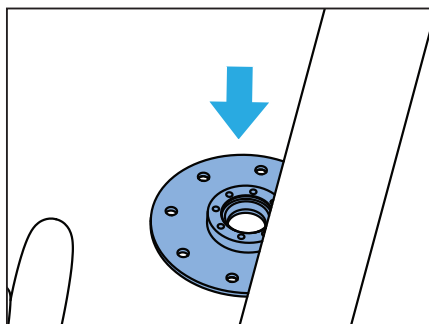

26. Place the Post Base Assembly onto the car floor.

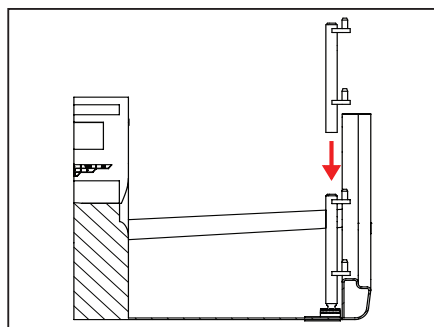

27. With the Post and Ball Joint already assembled (**See Page 26, Steps A-D**), set the angle and tighten the Cap Plate **6** down **EVENLY*** using **7** and **8** to 7.38ft-lb (10Nm).

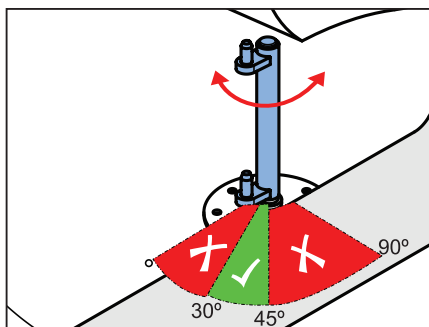

28. Rotate the Post to within the angle range as shown and tighten the Cap Plate **6** down **EVENLY*** using **7** and **8** to 7.38ft-lb (10Nm).

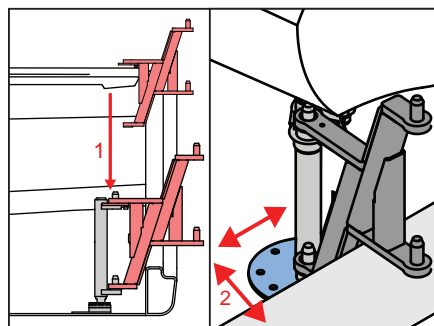

29. Place the Bracket on the Post (1) and locate the Assembly into the desired position (2).

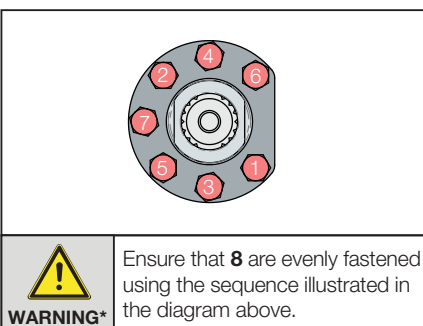



11. Sill Bracket - OPTIONAL

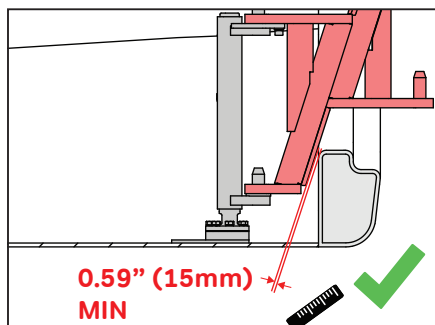

31. Ensure there is a 0.59" (15mm) gap between sill and bracket. Ensure the bracket has adequate clearance for removal from post.

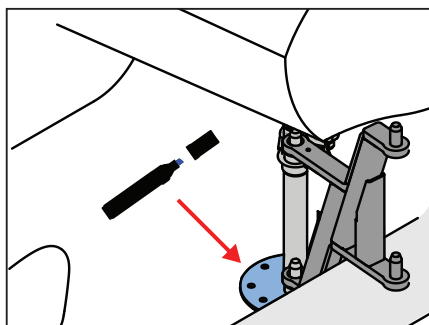

32. Mark holes on the floor for drilling.

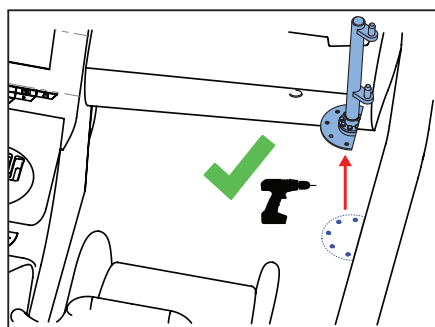

33. Remove bracket, post and base plate assembly. Return to instruction 9 and proceed to complete base and post fitting.

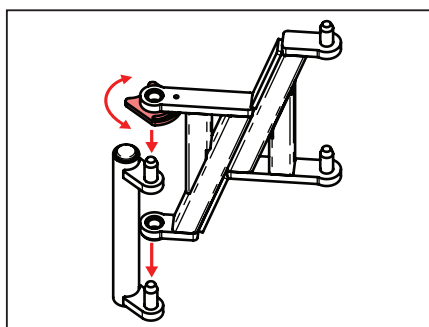

34. Place the bracket on the post. Rotate bracket to required angle.

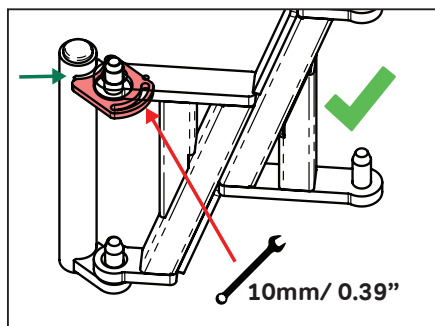

35. Tighten the bolt to set the bracket in the required angle.

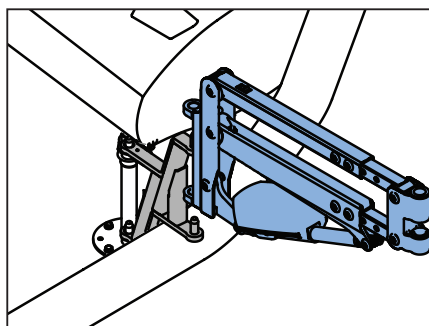

36. The bracket is now ready to mount the Person Lift. Reset bracket angle if required.

12. Wiring



WIRING AND ELECTRICS

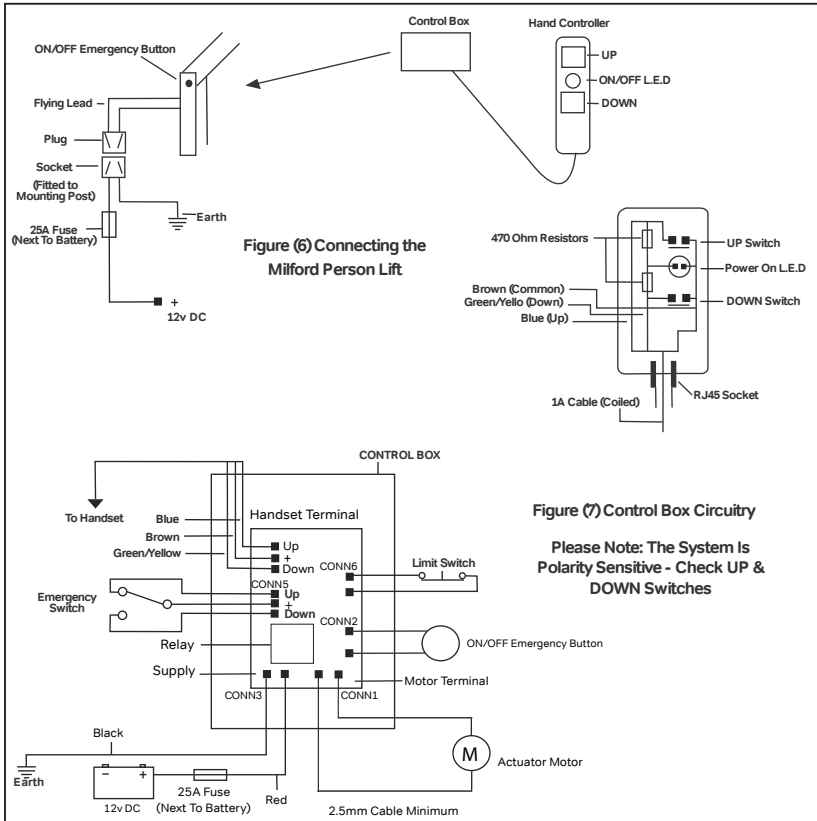

- The wiring supplied for connecting the battery and power socket is twin core with red & black insulation.
- The power connection socket is best positioned on the outside of the post (toward the door).
- Run the cable down the brace bar and through the bulkhead (use the grommet supplied if required) to the vehicle battery. Secure the cable where required using the cable ties provided.
- Connect both wires to the battery. Use the inline fuse holder provided on the positive connection. Wire as follows black = negative / red = positive. A spare 25 AMP fuse is provided and should be handed to the customer or located in an obvious and appropriate position.
- DO NOT use a painted surface to achieve an earth. This could lead to intermittent operation of the Person lift.
- Place the Person Lift onto the mounting post lugs, connect plug, affix extension bar and spreader bar, test by loading up to 330lb (150kg) maximum (refer to page 21 of the Owners Manual for the correct weight for your specific installation) and make sure excessive deflection of all fixings is not present.
- Check all nuts/bolts for security & waxoyl all exposed fixings to prevent corrosion.

Your Dealers Details:



**SMART
TRANSFER**
Range

1 800 488 7688



service@mobilityinnovators.com



www.mobilityinnovators.com

