

VERSATILE STANDING AND RAISING AID

# Sara<sup>®</sup> Flex



Designed to make everyday transfer and care tasks easier, Sara Flex enables a single caregiver to assist a patient or resident from a seated to a standing position, in one natural movement.

## ARJO MOBILITY GALLERY



C © Arjo 2019

C. Able to partially bear weight on at least one leg. Uses a wheelchair for moving a distance.

Please contact Arjo for further information.

- **Patient support**  
Promotes comfort and security throughout and at the completion of the sit-to-stand movement.
- **Facilitating a range of key transfers and care tasks**  
Designed with ease of use for the single caregiver in mind, with no adjustments required.
- **Natural forward movement for the patient**  
Forward movement, combined with the flexible leg support, enables a natural and comfortable sit-to-stand movement.
- **DSDC Dementia Design Accredited Product**  
The Dementia Services Development Centre (DSDC) at the University of Stirling has reviewed Sara Flex and awarded it a DSDC Product Accreditation Rating Class 1B.



# Key features

## CAREGIVER HANDLE

Curved handle enables the caregiver to choose where to hold.

## EASY-TO-USE HAND CONTROL WITH DISPLAY

The hand control is on a long flexible cord that enables the caregiver to stay close to the patient throughout the transfer.

## LOW HORIZONTAL FOOTPLATE

Keeping the patient's feet close to the ground means their knees are not raised too high, making it easier to stand.



## SCALE (OPTION)

Built in electronic scale shows the patient's weight on the display of the hand control.

## PATIENT HANDLE

The contrast-coloured angled patient handle positions the hands, wrists and elbows throughout the sit-to-stand movement.

## FLEXIBLE SILICONE LEG SUPPORT

Curved design with a soft and flexible surface that supports the lower legs and knees throughout the sit-to-stand movement. Requiring no adjustments, the large surface caters for a broad range of patients while delivering good comfort.

## FLEXIBLE SILICONE LEG STRAP

Positioned low and with multiple adjustment options to ensure patients can be securely positioned from a seated to a standing position.

PRODUCT INFORMATION		
Max safe working load	200 kg	440 lb
Lifter weight (incl battery)	53.6 kg	118 lb
Min total storage height	1162 mm	45 ¾ in
Min lifting height	991 mm	39 in
Max lifting height	1518 mm	59 ¾ in
External width legs closed	660 mm	26 in
External width legs fully open	1029 mm	40 ½ in
Internal width legs closed	530 mm	20 ⅞ in
Internal width legs fully open	899 mm	35 ⅝ in
Leg clearance (floor to top of legs)	108 mm	4 ¼ in
Chassis clearance (floor to bottom of chassis)	23 mm	1 in
Lifter total length	996 mm	39 ¼ in
Turning radius	1208 mm	47 ½ in
Lifter protection class	IP24	
Hand control protection class	IPX7	
Battery	24V, 4 Ah	
Battery charge indicator		
Service meter - displays the total time in use (hours)		
Emergency stop and system failure override		
Automatic safety cut out if lowered onto an obstacle		
Low-friction castors, the rear two with brakes		

## ACCESSORIES

Wide range of slings and flites (disposable) available

Optional: integrated scale

Arjo disinfectants

## SPACE REQUIREMENT

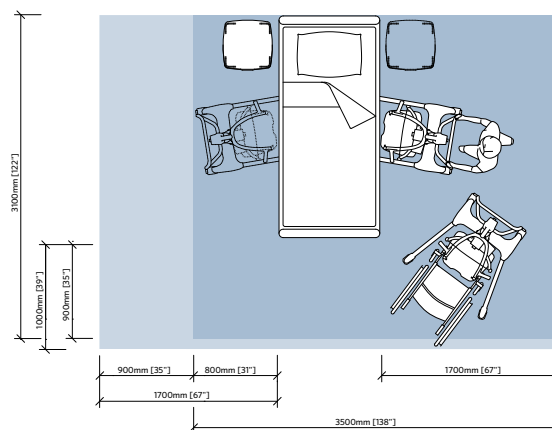

- Blue area shows the minimum working area required to enable the caregiver to use the mechanical aids ergonomically from one side.
- Light blue area shows extension of working area required to facilitate activities from either side to provide adequate access for the patient, mechanical aid and caregiver.

The Dementia Services Development Centre (DSDC) at the University of Stirling has reviewed this product and has rated its design in relation to dementia design principles and its usability in a dementia-inclusive environment. For ease of identification, the suitability of the product is classified by a number with a corresponding explanation of use, within the ratings key provided. The DSDC Accredited Product logo is awarded on the merit of the individual product and colour way. This accreditation does not relate to the manufacture or final application of the product. While every endeavour has been made to ensure the ratings reflect the product's

suitability and application at the time of printing, the DSDC cannot be held responsible for the application of the final product, its performance or its interface with other products or finishes. For an environment to be considered 'dementia-inclusive' or 'dementia-friendly', careful consideration must be given to the specification of adjoining finishes, their performance specification (for example light reflectance value (LRV), slip resistance and use of pattern) and their suitability for their intended use.