

Easytrack FS

Operating and Product Care Instructions



TABLE OF CONTENTS

<i>SAFETY INSTRUCTIONS AND WARNINGS</i>	<i>4</i>
SYMBOLS.....	4
<i>EASYTRACK FS REP SPECIFICATIONS</i>	<i>7</i>
<i>WHAT'S INCLUDED?.....</i>	<i>8</i>
<i>PRIOR TO THE INSTALLATION</i>	<i>9</i>
<i>STEP 1. POST TO BASE ASSEMBLY.....</i>	<i>10</i>
<i>STEP 2. INSTALLATION OF THE FS REP RAIL.....</i>	<i>11</i>
<i>FS REP FEATURES.....</i>	<i>13</i>
<i>STEP 3 - FIXED CEILING LIFT INSTALLATION INSTRUCTIONS –</i>	<i>13</i>
RAIL EXTENSION.....	13
INSERT THE LIFT INTO THE RAIL.....	15
<i>STEP 4. INSTALLING THE CHARGING STATION</i>	<i>17</i>
<i>STEP 5. RAIL WIDTH ADJUSTMENT</i>	<i>18</i>
<i>STEP 6. HEIGHT ADJUSTMENT</i>	<i>19</i>
<i>STEP 7. DISASSEMBLING THE EASYTRACK FS REP.....</i>	<i>21</i>
REMOVING FIXED CEILING LIFT FROM FS REP RAIL:	21
PORTABLE AND FIXED CEILING LIFTS	22
<i>MAINTENANCE</i>	<i>22</i>
<i>EASYTRACK FS REP™ VISUAL INSPECTION.....</i>	<i>22</i>
<i>MONTHLY MAINTENANCE.....</i>	<i>23</i>
<i>IF EQUIPMENT IS MOVED ON A REGULAR BASIS:.....</i>	<i>23</i>
<i>TROUBLESHOOTING</i>	<i>24</i>
<i>ACCESSORIES</i>	<i>25</i>
<i>LIMITED WARRANTY</i>	<i>25</i>

Printed in Canada



BHM Medical Inc. Reserves the right to change or discontinue any specifications, design, features, model or accessories shown without notice.

TM Trade-mark of BHM Medical Inc. All rights reserved. © BHM Medical Inc., 2008

EASYTRACK FS REP™ SPECIFICATIONS

SAFETY INSTRUCTIONS AND WARNINGS

Symbols

	=	WARNING! Notices apply to hazardous or unsafe practices, which could result in serious physical injuries
	=	CAUTION! Notices apply to hazardous or unsafe practices, which could result in minor personal injury or property damage.
	=	Highlights procedures which will assist the operator in understanding the information contained in this manual.



WARNING

Please read and understand these installation procedures entirely before assembling the Easytrack FS Rep™. Information in this manual is important for the proper operation of this equipment. This will protect you from possible injury and ensure the equipment performs to your satisfaction.

EASYTRACK FS REP™ SPECIFICATIONS



ALWAYS KEEP THESE INSTRUCTIONS with the Easytrack FS Rep™.



FAILURE TO MEET REQUIREMENTS LISTED BELOW COULD RESULT IN SERIOUS PHYSICAL INJURY.

- Annual maintenance **MUST** be performed by qualified personnel **ONLY**. This equipment should never be used by patients alone.
- A monthly maintenance inspection must be done in order to assure the good operating condition of the Easytrack FS Rep™.
- The Easytrack FS Rep™ System and its accessories are intended to be used as an assistance device for transferring a person between the posts.
- **The Easytrack FS Rep™ is only to be used with BHM ceiling lifts.**
- Ensure floor is clear of any dust, grease, water or any foreign substances prior to the transferring of a patient.
- If you are unsure of the strength or stability of your floor, do not assemble the equipment.
- Floor must be levelled. Do not install on a sloped floor.
- Ensure posts are straight prior to use with a patient.
- Do not drop product, it may cause breakage.
- Do not submerge in water.
- Do not attempt to over-extend the rail past the locking point.
- Protect the Easytrack FS Rep™ and its accessories during transport.
- Prior to each use of the equipment, complete a visual inspection.

When the Easytrack FS Rep™ is in use

- Do not bump the posts – This might cause unit to become unstable. If posts are bumped, reassemble Easytrack FS Rep™ system to ensure the posts are straight.
- If you use a power wheel chair use extreme care – bumping posts may cause unit to become unstable. If posts are bumped, reinstall the Easytrack FS Rep™ system to ensure the posts are straight.
- Do not lean against posts.
- Do not use the Easytrack FS Rep™ system as a swing.
- Do not allow the patient to swing in any direction while being lifted.

EASYTRACK FS REP™ SPECIFICATIONS

- When moving or storing the Easytrack FS Rep™, always make sure the posts are completely retracted and that the collars are closed.

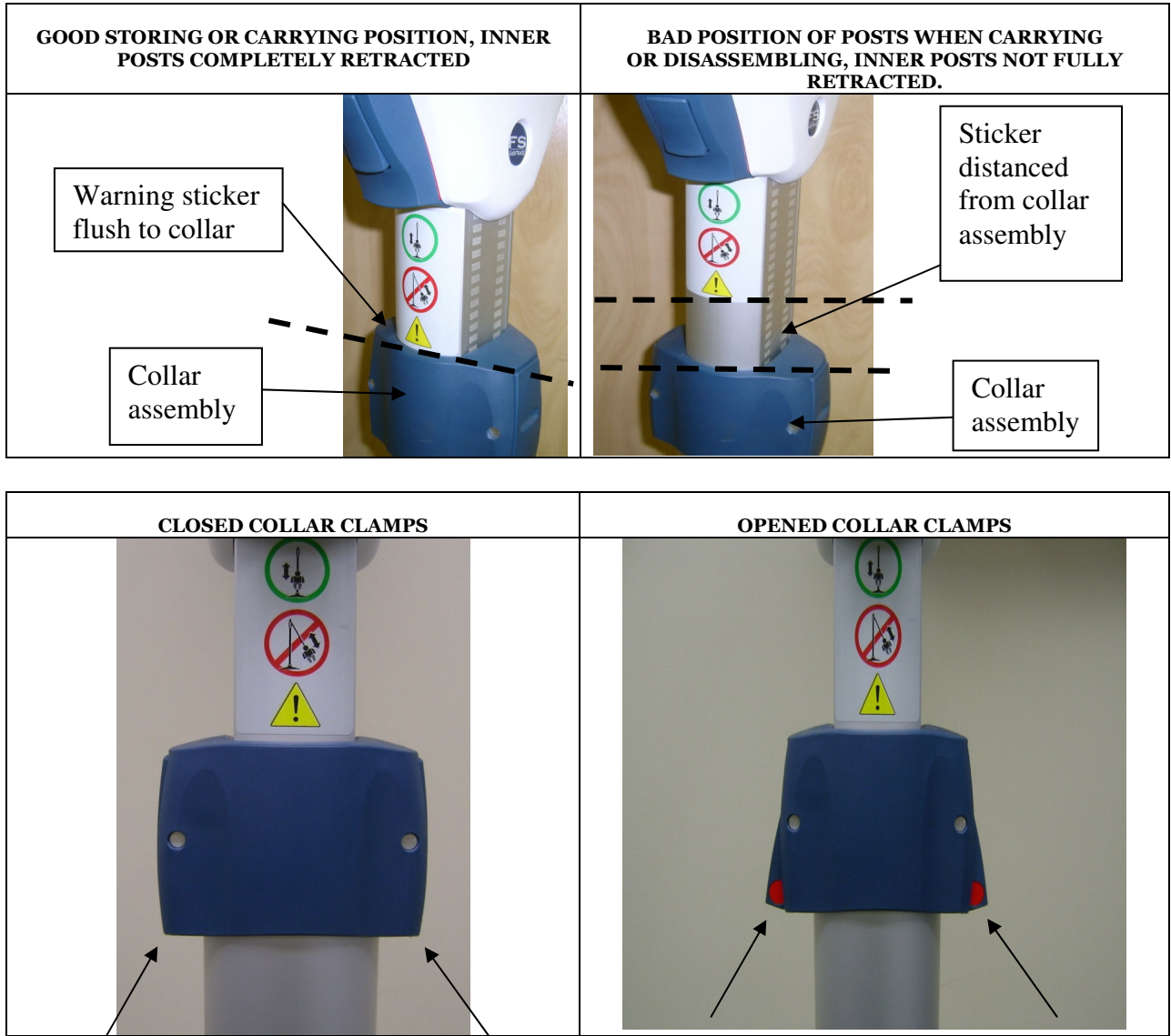

Note: red stickers are showing when collar clamps are open.

EASYTRACK FS REP™ SPECIFICATIONS

EASYTRACK FS REP SPECIFICATIONS

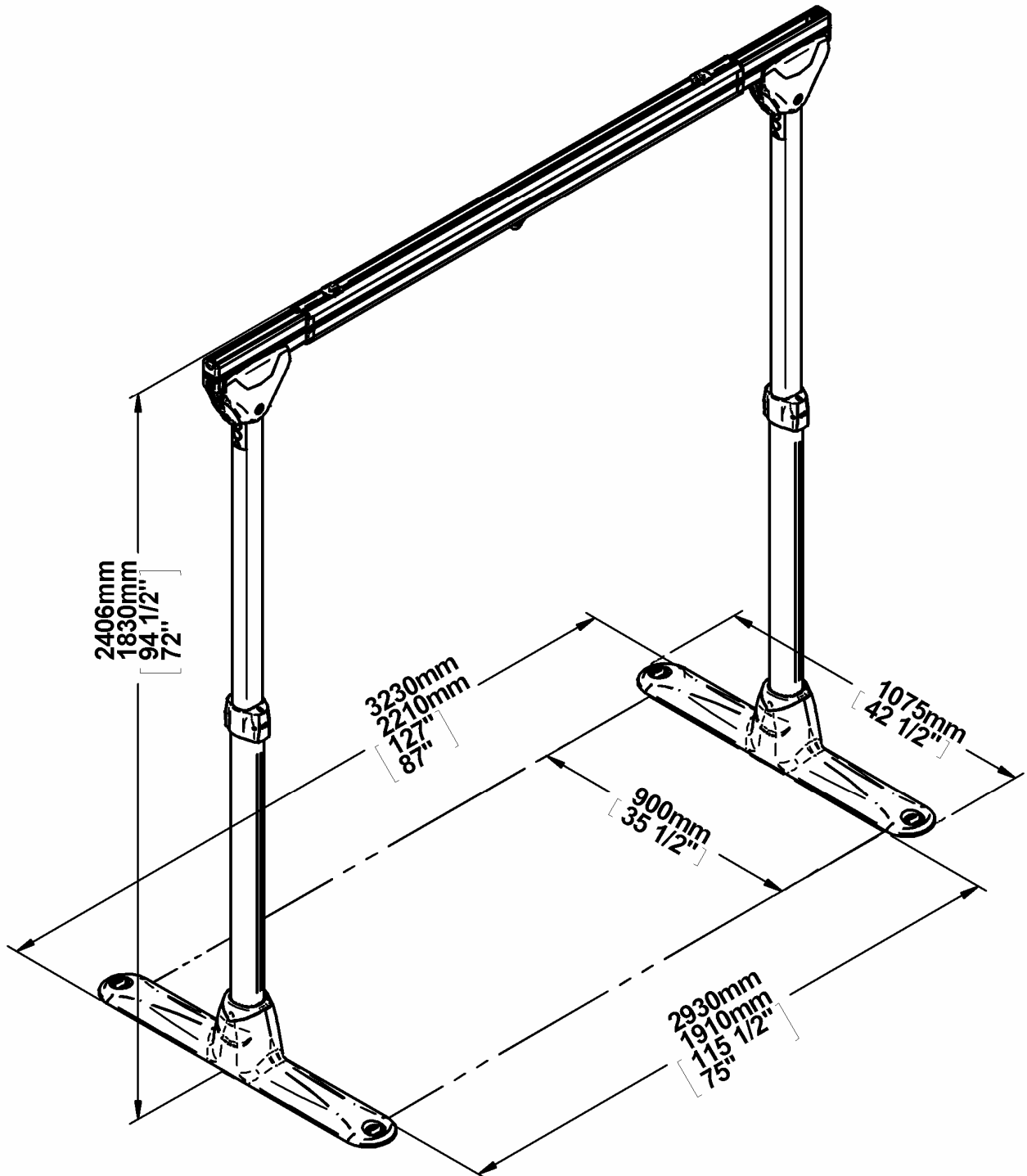

MAX. CAPACITY: 200 kg (440 lbs)

ASSEMBLY INSTRUCTIONS

What's included?

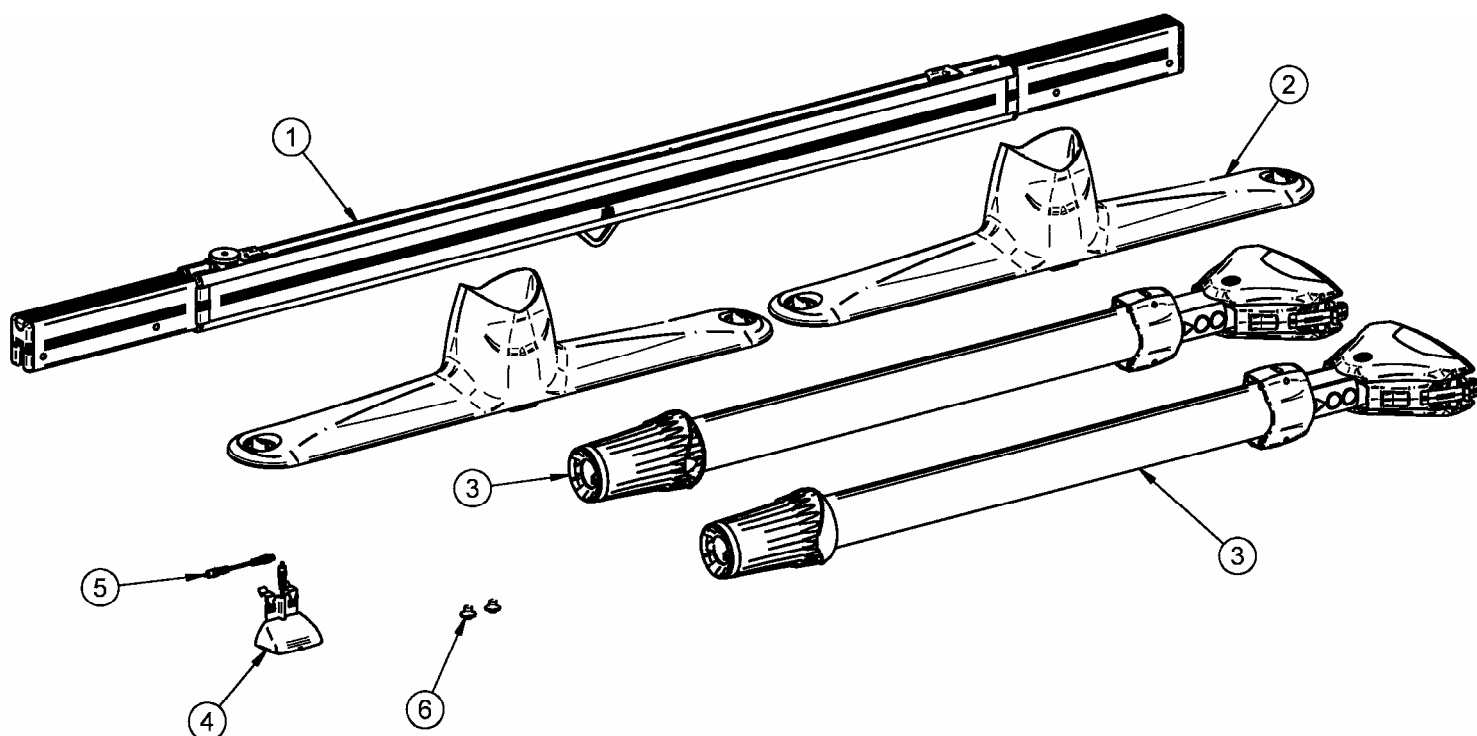

	Legend	Part #
①	Easytrack FS Rep™ extendable rail with knob device	700.17260
②	Easytrack FS Rep™ base – 2 pieces	700.17100
③	Easytrack FS Rep™ post - 2 pieces	700.17000
④	FS-Contact box	700.17180
⑤	Extension cable	402.15505
⑥	Track lift guides	200.17280

ASSEMBLY INSTRUCTIONS

PRIOR TO THE INSTALLATION



WARNING : Read the section “Safety instructions and warnings” before attempting to assemble the Easytrack FS Rep™ system.

- Survey the room, where you plan to install the Easytrack FS Rep™ system.
- Make sure the room meets the requirements specified below.
- Use the measurements below to determine the best place to put the Easytrack FS Rep™ system :

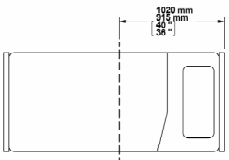
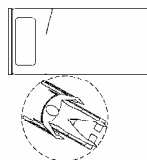
Over a bed	Approx. 915 to 1020 mm (36 to 40 inches) from the head of the bed.	
	Allow 1000 mm (39 1/2 inches) of open area for transfer working space.	



Transfer should only take place between the Easytrack FS Rep™ posts.

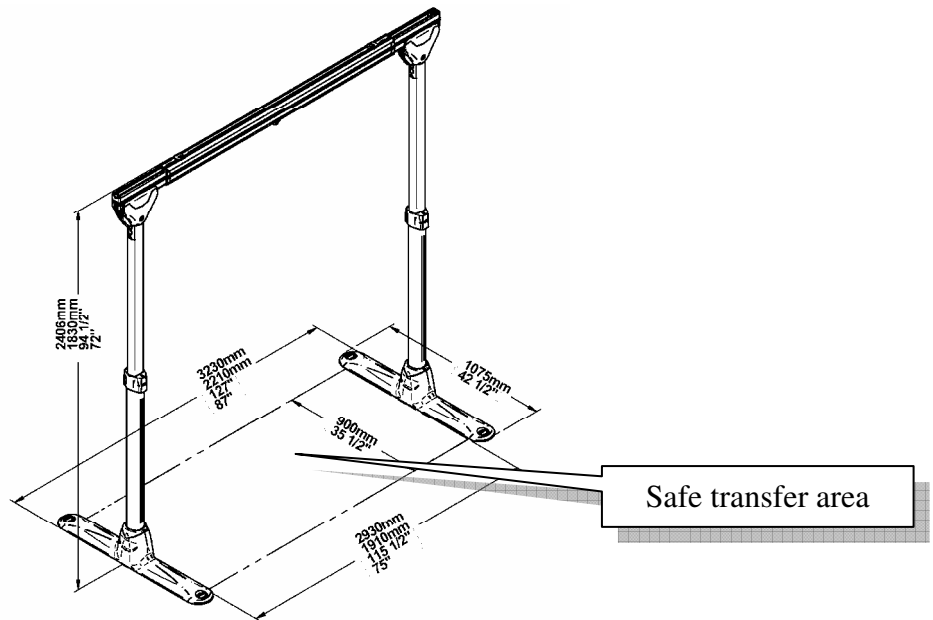

ASSEMBLY INSTRUCTIONS

Step 1. Post to Base Assembly

Note: The assembly can be performed by one person

1. Remove all parts from the boxes. Before assembling make sure that all parts are present and in good condition.
2. Layout the bases on a level and clean floor at the desired distance.
3. Insert the posts in the bases. The design of the base will ensure the post lines up in the correct position.



Make sure posts are correctly inserted in both bases.

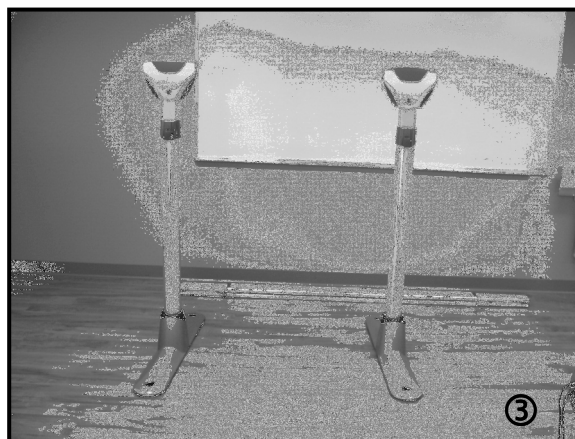
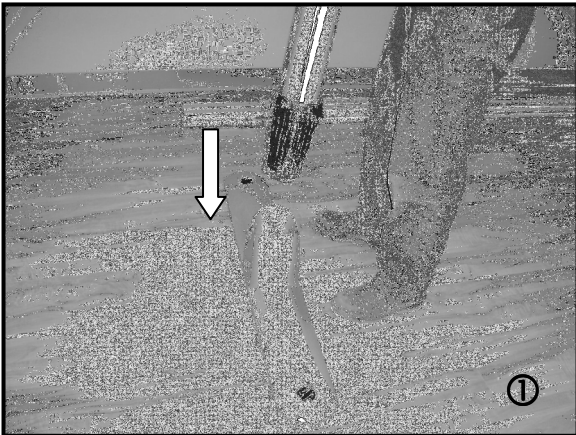

ASSEMBLY INSTRUCTIONS

Step 2. Installation of the FS Rep rail

Note : *The FS Rep rail allows the insertion of a BHM ceiling lifts.*

1. Prior to the installation of the rail, unlock the hook handle by pressing on the safety latch (located on the blue colour component on the side of the post head) and pulling outward. ❶
1. Gently pull out the handle until the red stripe of the main rail hook mechanism is visible. ❷

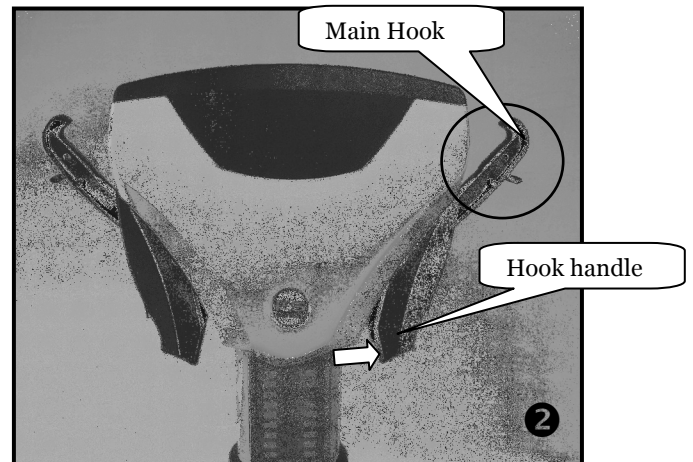

2. Insert the rail in place on top of both posts. ❸



When placing the rail on the post, extend the inner rail 3 inches out from the main outer rail in order to allow enough space for the safety latch to properly engage the rail.

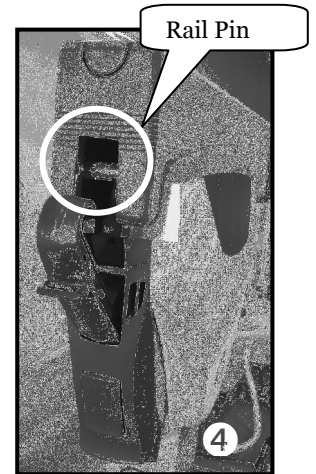

3. Secure both ends of the rail by engaging the main hooks over the rail pins. ❹

ASSEMBLY INSTRUCTIONS

4. Make sure both rail ends are in place on top of the posts.
5. Lock the rail to the post by closing the hook handle while pushing the main hook over the rail pin. The red stripe on the hook handle should no longer be visible. You should feel a slight tension when closing the hook handle. 5 6

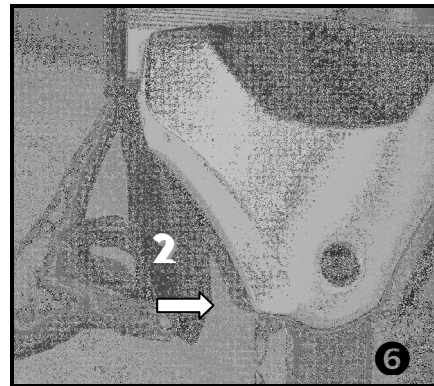
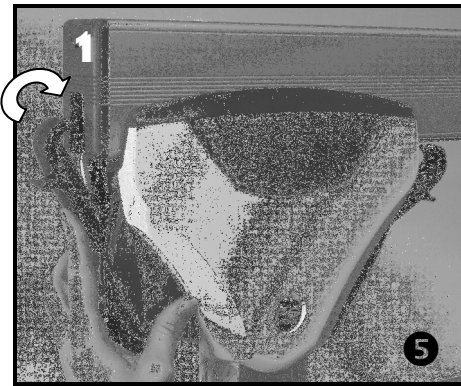

View of the rail when properly installed and locked in place.

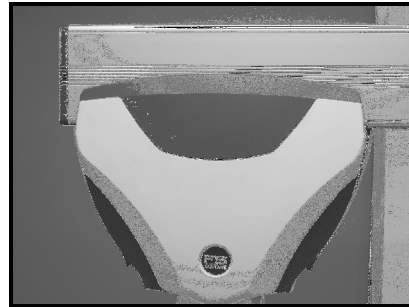

Make sure the main hooks are fully engaged.

ASSEMBLY INSTRUCTIONS

FS Rep features

The Easytrack FS Rep allows you to use a portable or fixed ceiling lift.
If you are using the FS Rep with a portable lift go directly to Step 6.

Step 3 - Fixed ceiling lift installation instructions –

Rail extension

(LDXXXXXX and 910XXXX and 911XXXX with serial numbers higher than 9005).

1. Loosen the special knob ❶ on top of the rail until the larger mark ** on the thread is visible.

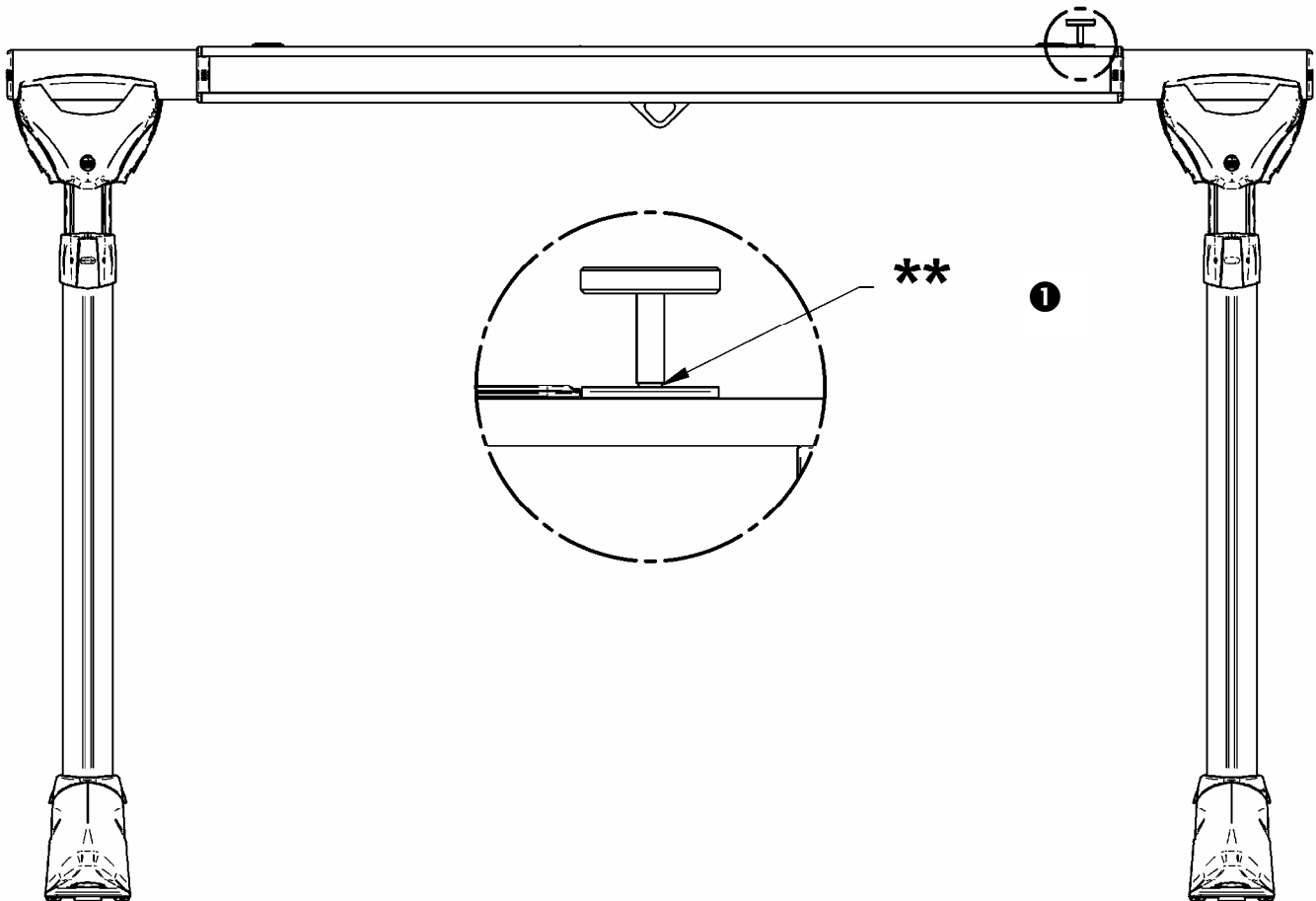

ASSEMBLY INSTRUCTIONS

2. Press on the extension stopper to release the extendable rail allowing it to slide outward. The extension stopper is spring loaded and located approximately 6 inches further along the top of the rail away from the special knob. Slide the inner rail out of the outer rail.
3. Slide the rail out until you see the red stripe on the inner rail ②.

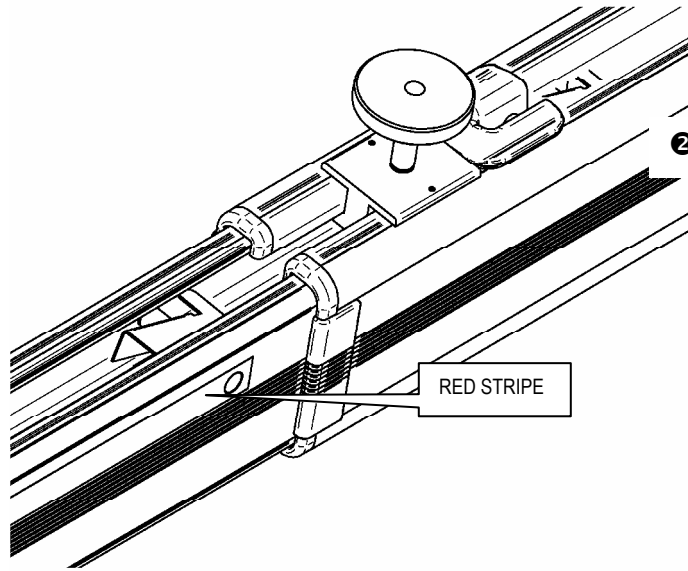

ASSEMBLY INSTRUCTIONS

Insert the lift into the rail

1. Install the 2 track guides on the lift.

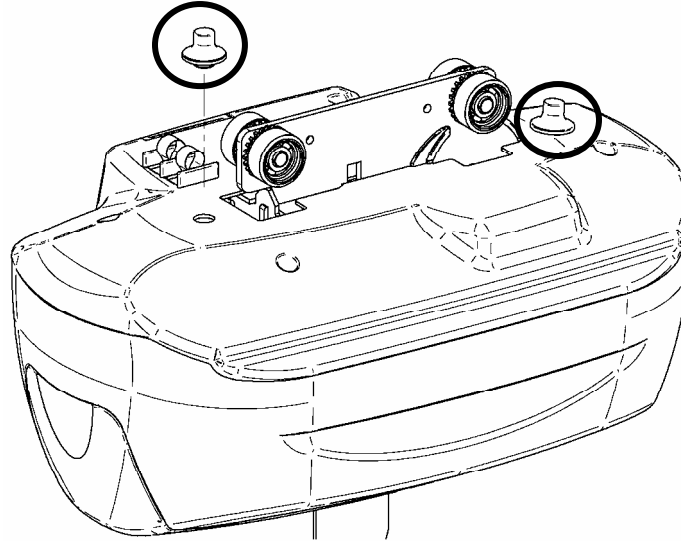

2. In order to allow the lift to move freely on the rail, you have to break the idler gear protectors. To do so use a screwdriver as shown on the following drawings.

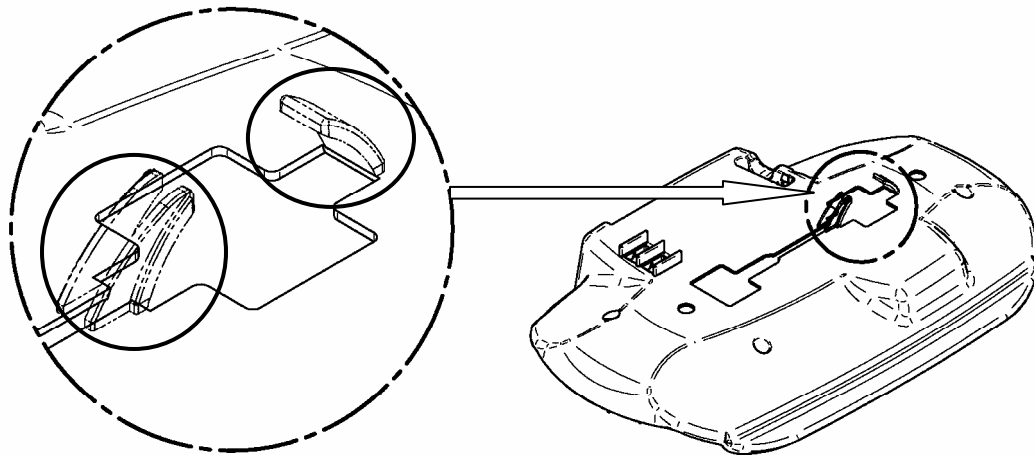

Front and back idler gear protectors

ASSEMBLY INSTRUCTIONS

Insert
screwdriver here
and snap off

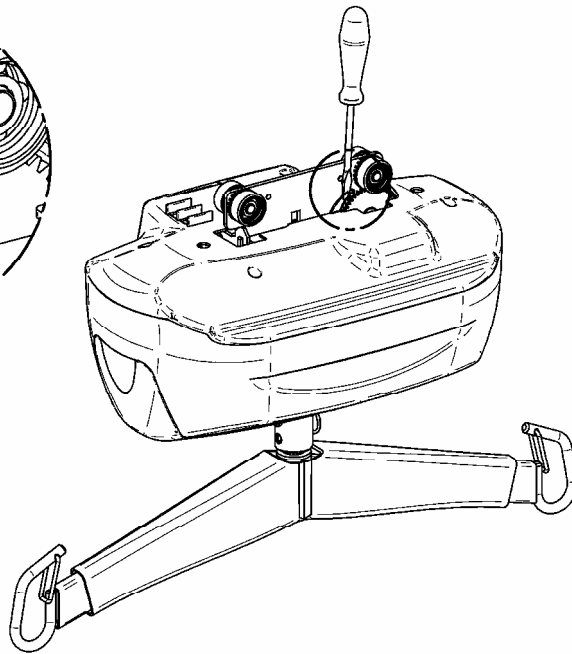
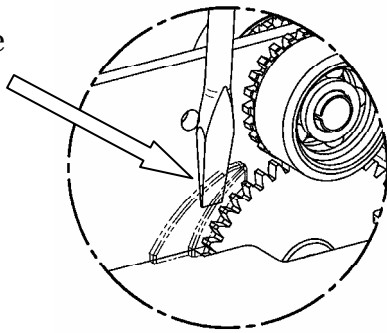

Insert screwdriver
here and snap off

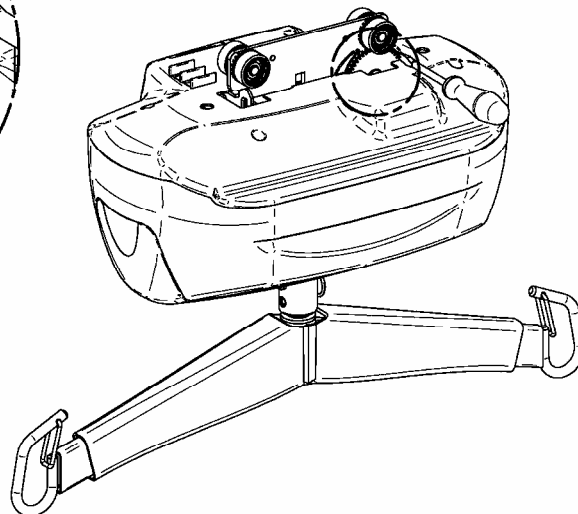
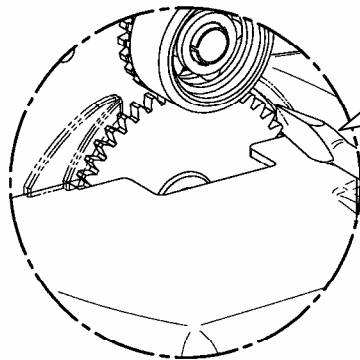

ASSEMBLY INSTRUCTIONS

3. Insert the lift into the opening in the rail located below the red stripe ③.
4. Slide the lift toward the opposite end of the rail ④.
5. Retract the inner rail. You should hear a click indicating that the rail stopper is properly re-engaged.
6. Adjust the length of the rail (extendable from either end).
7. Gently tighten down the special knob. (The knob is used to eliminate the gap inside the rail allowing the lift to smoothly glide over the lift insertion area.)

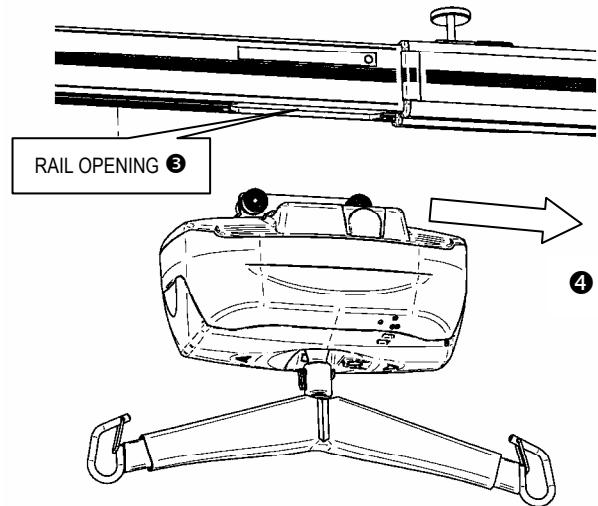

Step 4. Installing the charging station

In order to be able to demonstrate the charging capabilities of the lift the charging station must be installed on FS REP rail.

1. Make sure the charging station is correctly oriented so the contact box will mate with the charging contact blades of the lift.
2. Clip the charging station to the rail.

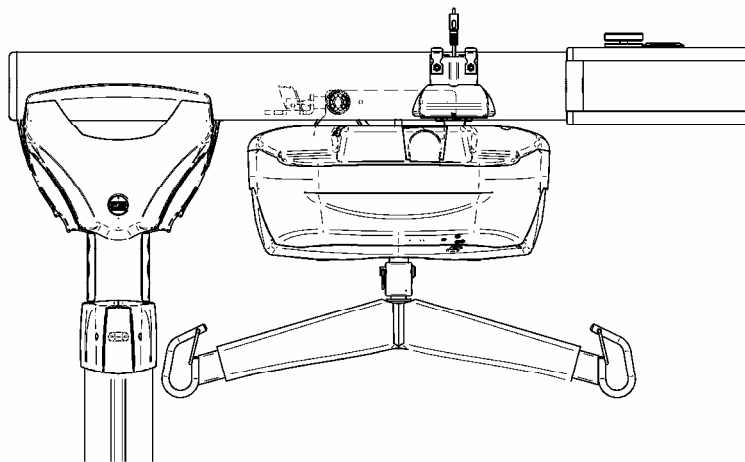

ASSEMBLY INSTRUCTIONS

3. Install the cable extensions and the charging stations power supply box (supplied with the ceiling lift) as shown below.

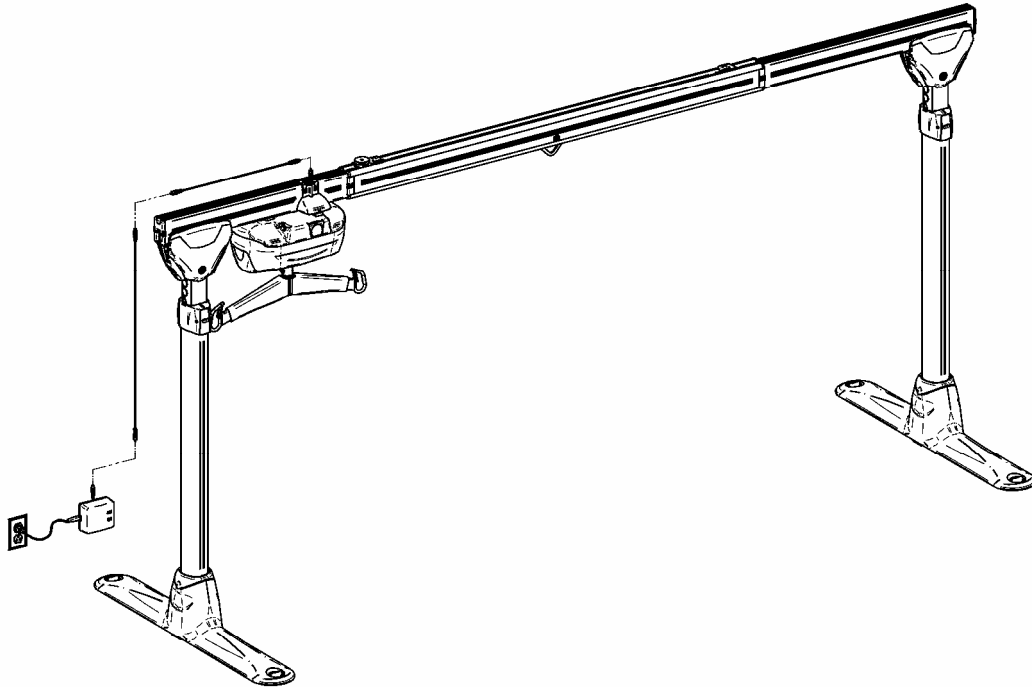

Step 5. Rail width adjustment

1. To adjust the rail width, pull the inner rail away from the main outer rail until the desired width is achieved.
2. Adjustments can be done from either end of the rail. Caution; when extending the rail from the end located by the special knob, the red stripe must not become visible.

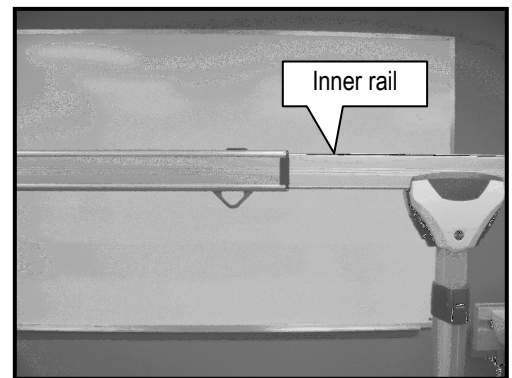

WHEN EXTENDING THE RAIL, DO NOT EXTEND TO EXPOSE THE RED STRIPE. THE RED STRIPE MUST NOT BE VISIBLE WHEN THE SYSTEM IS IN USE.

ASSEMBLY INSTRUCTIONS

Step 6. Height adjustment

1. The height adjustment of the posts is accomplished by starting with the blue locking collar clamp located in the centre of each post.

Blue locking collar clamp

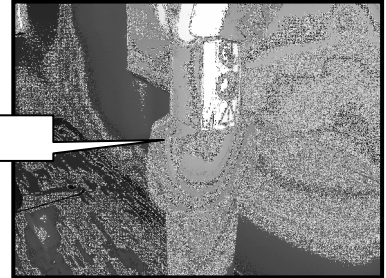

2. Pull on the lower portions of both sides of each locking collar to release the collar mechanisms and allow the inside section of the post to extend upwards. When the collars are in the open position, red dots are visible.

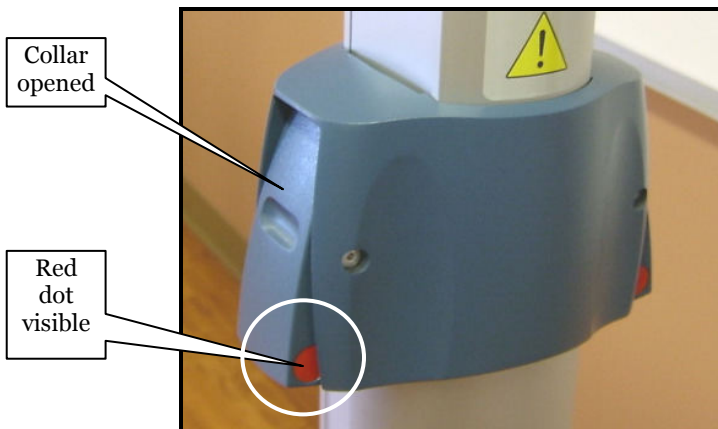

1. Position yourself under the rail between the two posts and gently push upwards until the desired height is achieved.



ASSEMBLY INSTRUCTIONS

2. To ensure the rail is levelled use the measurement reference marks on the front of each post.



Adjustments: To lower the post, consult the section “Disassembling the Easytrack FS System” (further in this manual).



3. Re-lock the clamping collars on both posts to secure the assembly. When the collars are in the locked position **red dots are no longer visible**.
4. Fine tune the level of each base using the two blue floor levellers located at each ends of both bases.



The central glider of the base must touch the floor at all time.

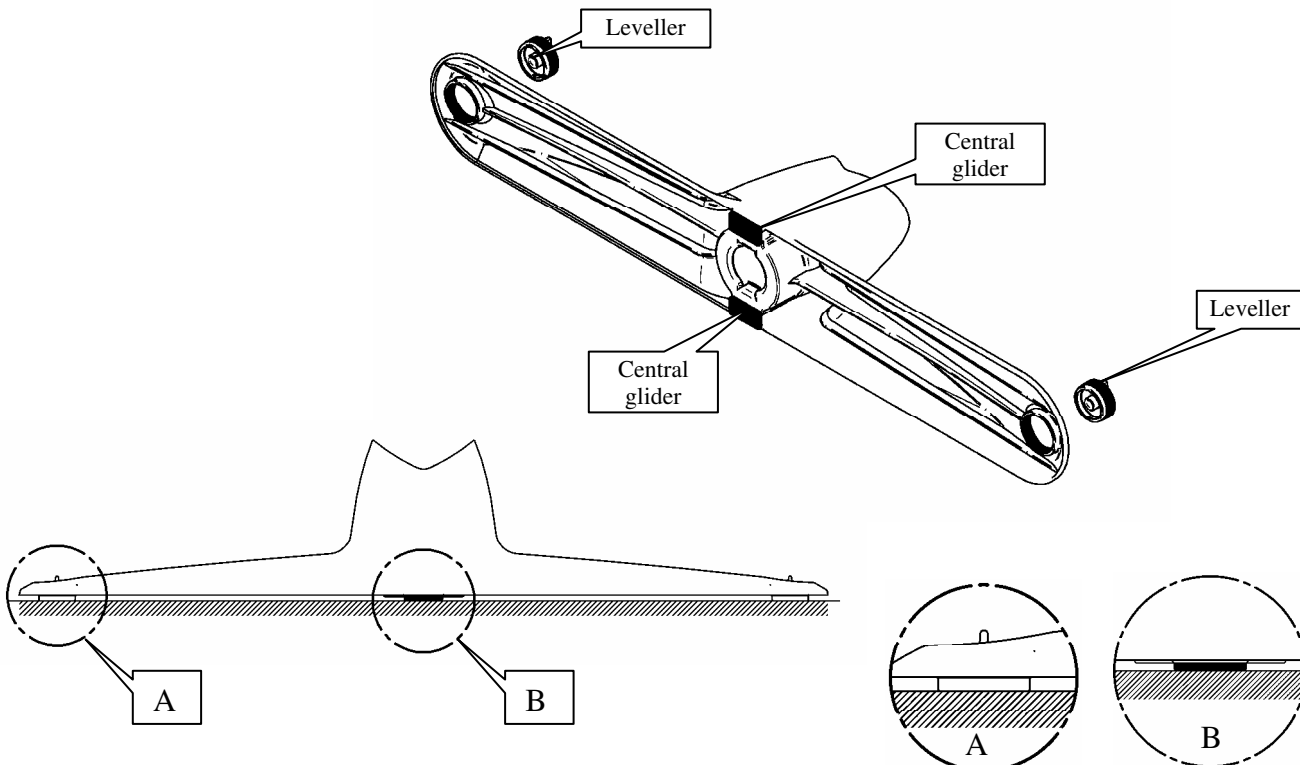

ASSEMBLY INSTRUCTIONS

5. Your Easytrack *FS Rep*[™] is now ready to use with a dedicated track lift or a portable lift (*not included with this kit.*)



THE MAXIMUM CAPACITY OF THE RAIL IS 440 LBS (200 KG). DO NOT USE THIS EQUIPMENT WITH A LOAD EXCEEDING THIS CAPACITY OR SERIOUS INJURY AND MATERIAL DAMAGES MAY OCCUR.

Step 7. Disassembling the Easytrack *FS Rep*



IF USING A PORTABLE LIFT, REMOVE IT FROM THE RAIL BEFORE ADJUSTING OR DISASSEMBLING THE EASYTRACK *FS Rep*[™] SYSTEM.

To disassemble the Easy track *FS Rep*[™] reverse the assembly sequence.

1. Unlock the clamping collars on both posts (See “Height adjustment” section). **If the lift is a fixed model:** carefully slide the lift to the side that you are lowering. This will prevent it from sliding toward you as you lower the post. Retract the first post.
2. Retract second post and bring it to a comfortable height (parallel to the first retracted post) to continue disassembling the Easytrack *FS Rep*.

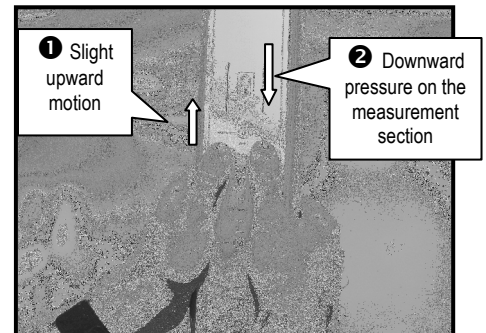

The posts are retracted by first releasing the pressure on the internal lock mechanism using a slightly upwards motion on the post and then applying downward pressure to the section of the post where the measurement reference marks are located.

Removing fixed ceiling lift from *FS Rep* Rail:

3. Unscrew the knob device and slide the inner rail out in order to expose the opening under the rail.
4. Remove the lift from the rail. Hand support the lift while approaching the opening to ensure the unit won't fall through.
5. Reinsert the rail and slightly tighten the knob device.

MAINTENANCE

Portable and fixed ceiling lifts

6. Remove rail from posts. To do so, unlock the safety latches to release the main hook from the rail pin (See the “Installation of the rail” sections).
7. Collapse the extended rail (See “Rail width adjustment” section).



Place all pieces into a box or bag to protect them from the dust and from damages

MAINTENANCE



FAILURE TO FOLLOW MAINTENANCE INSTRUCTIONS COULD RESULT IN INJURY OR DAMAGE.



AN ANNUAL INSPECTION SHOULD BE PERFORMED BY A TECHNICIAN.

INSPECTION SHOULD BE CARRIED OUT ROUTINELY. ANY DAMAGE THAT HAS LEAD TO CORRECTIVE ACTIONS SHOULD BE NOTED, SIGNED AND DATED BY THE INSPECTOR. DEFECTS AND RESULTING ACTIONS SHOULD BE REPORTED IN WRITING TO YOUR SUPPLIER.

EASYTRACK FS REP™ VISUAL INSPECTION



Conduct a visual inspection before each use of the equipment

1. Make sure posts are straight. If they do not appear straight, verify with a level. If posts are not straight, remove rail and re-install posts (refer to assembly instructions).
2. Make sure rail is secured in place before using. Pull up on the rail to make sure that the rail is locked onto the post.
3. Make sure there is no visible damage. If so, **DO NOT USE THE EASYTRACK FS REP™ SYSTEM.**
4. Make sure that bases are properly adjusted (see assembly instructions).

MAINTENANCE

MONTHLY MAINTENANCE

- Clean inside rail with a damp cloth to ensure there is no dust or grease build-up.
- Check to ensure all original parts are present. If any parts are missing they should be replaced BEFORE USING THE EASYTRACK FS REP™ SYSTEM.
- Make sure that the trolley in the rail moves freely. It may need to be cleaned or replaced occasionally.
- Examine all joints and pieces for wear and fatigue. Replace any part that looks damaged or worn.
- Document inspections and repairs.

IF EQUIPMENT IS MOVED ON A REGULAR BASIS:

- Make sure all components are accounted for (see “What’s included” section).
- Check “**Safety instructions and warnings**” and “**Assembly instructions**” sections before re-installing the Easytrack FS Rep™ system.
- Make sure the bases are clear of any debris and are not damaged. If they appear to be damaged, replace bases.
- Make sure there is no debris in the base post sockets.
- Look for signs of wear or breakage on all parts. Replace any parts that appear worn or damaged.



FOLLOW GUIDELINES IN YOUR TRACK LIFT MANUAL FOR OPERATING AND MAINTENANCE PROCEDURES OF THE LIFT.

TROUBLESHOOTING

TROUBLESHOOTING

PROBLEM	CORRECTION
Trolley moves substantially on its own when the Easytrack system is fully assembled.	Is the rail levelled? Is the floor levelled? Is the rail secured to the posts? Press up on the rail to make sure that it is latched onto posts.
Extendable rail comes completely apart during assembly.	<p>Rail has been extended too quickly/forcefully. Rail was pulled past the locking device.</p> <ul style="list-style-type: none"> • Check locking device inside rail (top of rail above the trolley) to make sure it is not damaged. Replace the trolley if damaged. See “Easytrack FS Rep TM” system content. • Put rail back together at a slight angle and slide together. • Slowly extend rail out again to ensure locking device clicks into place. • Slowly compress the rail again.
Trolley does not roll in rail smoothly.	<ul style="list-style-type: none"> • Is rail clean? Clean rail with damp cloth. • Is trolley centered in rail? Re-center trolley. • Is the trolley damaged? Replace trolley
Posts and bases rock back and forth.	<ul style="list-style-type: none"> • Check integrity of the floor. • Are the levellers properly adjusted? • Are the posts properly inserted in the base? • Are the collar clamps closed?
It is impossible to retract posts.	<ul style="list-style-type: none"> • Did you release the collar clamps? • Did you follow the disassembling instructions? • Did you remove lift from trolley?
The trolley does not move.	<ul style="list-style-type: none"> • Did you extend the inner rail in order to release it from the rail slot (transportation)? • Is there debris on the rail?
Main hook does not engage on rail pin.	<ul style="list-style-type: none"> • Is there debris in the rail? • Is the rail well seated on the posts?
Lift does not move freely on rail.	<ul style="list-style-type: none"> • Is the knob correctly tightened? If not, tighten it slightly.

ACCESSORIES

ACCESSORIES

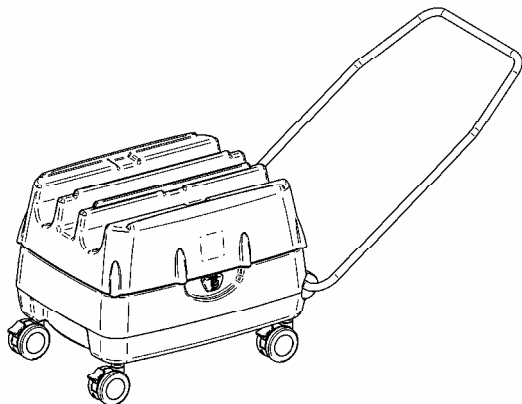

EASYKART
700.17500



FS CARRY BAGS
002.17010

LIMITED WARRANTY

LIMITED WARRANTY

This warranty is extended only to the original purchaser/user of BHM Medical products.

Subject to the limitations and exclusions hereafter, BHM Medical Inc. warrants its products to be free from defects in material under normal use and service, within the periods stated below from the date of purchase. If within such warranty period any such product shall be proven to be defective, such product shall be repaired or replaced at BHM Medical option. This warranty does not include any labour or shipping charges incurred in replacement part installation or repair of any such product. BHM Medical sole obligation and your exclusive remedy under this warranty shall be limited to such repair and/or replacement.

The proper operation of this product is dependant on the compliance with the instructions regarding operation and maintenance. Failure to comply strictly with those instructions will void this warranty.

Patient Lifter	1 year
Lifter's Accessories	1 year
Weighing Devices	1 year
Slings	1 year
Tracks and Installation	1 year
Easytrack / Easytrack FS Systems	1 year
Batteries - All Lifts (except portable track lift)	1 year
Batteries – Portable Track Lift	3 months

For warranty service, please contact the distributor from whom you purchased the BHM Medical product.

Do not return products to our factory without prior authorization. BHM Medical will issue a Return Authorization (RA) Number. C.O.D. shipments will be refused; all shipments to BHM Medical must be prepaid. For this warranty to be valid, the purchaser must present its original proof of purchase at the moment of the claim. The defective unit, assembly or part must be returned to BHM Medical for inspection. The part or components repaired or replaced are guaranteed for the remaining period of the initial warranty.

Limitations and Exclusions:

The warranty above does not apply to serial numbered products if the serial number has been erased, removed or defaced.

No warranty claim shall apply where the product or any other part thereof has been altered, varied, modified, or damaged; either accidentally or through improper or negligent use and storage. Warranty does not apply to products modified without BHM Medical's express written consent (including but not limited to products modified with unauthorized parts or attachments), products damaged by reason of repairs made to any component without the specific consent of BHM Medical, or to products damaged by circumstances beyond BHM Medical's control. BHM Medical will solely determine evaluation of warranty claim. The warranty does not apply to problems arising from normal wear or failure to adhere to the instructions in this manual. This limited warranty does not cover non defect damage, damage caused by improper installation (other than installation performed by BHM Medical) operation or care (including but not limited to abuse, misuse, failure to provide reasonable or necessary

LIMITED WARRANTY

maintenance, unauthorized repairs or any alterations to the products). BHM Medical Inc. slings are void of warranty if not laundered as per instructions on the Sling Label.

BHM Medical Inc. shall not be liable for damages losses or inconveniences caused by a carrier.

Only the original installation performed by BHM Medical or by its authorized subcontractors is covered by this limited warranty. Any modification to the original installation not authorized by BHM Medical will void this limited warranty. The limited warranty does not cover any problems with, or relating to the premises where the products are installed or to the property of the purchaser and shall remain the responsibility of the purchaser.

This limited warranty is in lieu of any other warranties, express or implied, and of any other obligations or liability on BHM Medical's part. Under no circumstances shall BHM Medical be liable for consequential, incidental or special damages arising in connection with use, or inability to use, the products. In no event shall BHM Medical's liability for breach of warranty, or for any delay in the performance of this warranty due to cause beyond the control of BHM Medical, breach of contract, negligence or strict liability exceed the cost of the product covered hereby. BHM Medical neither assumes nor authorises any person to assume for it any other obligation or liability in connection to the sale installation, maintenance or service to the products.

The purchaser may have other rights under existing provincial or federal laws and where any terms of this warranty are prohibited by such laws, they are deemed, null and void, but the remainder of the warranty shall remain in effect.