

ELECTRIC PATIENT LIFT

MOB1076

vive
vivehealth.com



To see all FAQs
in one place,
visit vhealth.link/vmd

OWNER'S MANUAL

ELECTRIC PATIENT LIFT

PARTS DESCRIPTION

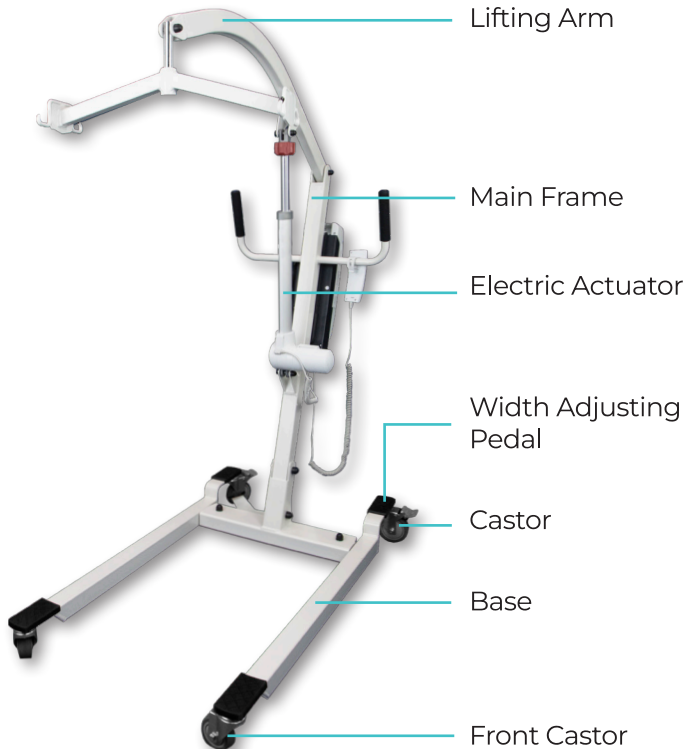

HARDWARE INCLUDED



- | | |
|---------------------------|------------------------------|
| A. Hexagon bolt M10x75 x2 | L. Small Nut Cap x3 |
| B. Washer x2 | M. Small Lock Nut x3 |
| C. Lock Nut x2 | N. Sling Holder |
| D. Nut Cap x2 | O. Sling Holder Support Pipe |
| E. Small Nut x3 | P. Hexagon bolt M10x55 |
| F. Hexagon bolt M10x70 | Q. Electric Control Box |
| G. Lifting Arm | R. Cord Holding Tabs |
| H. Actuator | S. Remote |
| I. Small Nut Cap x3 | T. Power Cord |
| J. Hexagon bolt M10x60 | U. Power Socket Cover |
| K. Spacer x2 | |

NOTE:

Some hardware is pre-installed onto the device. Sling not included.

ASSEMBLY INSTRUCTIONS

1. Place the Main Frame Arm and align the holes with the Base. Fix (A) M10x75 hexagon bolt with (B) Washer and insert it through both the holes on the base. Attach the (C) nut and to the other end and tighten down using your wrenches. Then place the nut cap (D) on the nut.

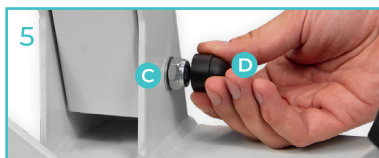
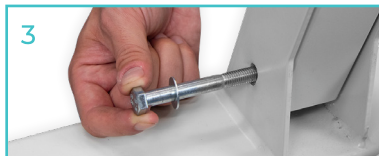
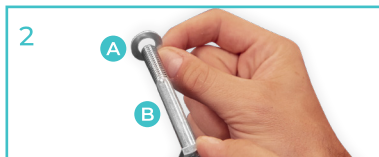

2. Insert the Lifting Arm (G) into the upper groove of the frame. Make sure the holes are in alignment and then slip the Hexagon bolt M10x70 (F) with a Small Washer (L) through the hole. On the opposite side attach another Small Washer (L) and a Small Lock Nut (M). Tighten down with a wrench and an allen key, finally and attach the Small Nut Cap (I). There should be no movement of the lifting arm.

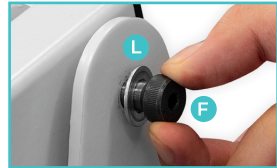
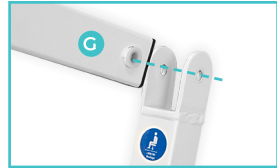

3. Install the actuator (H) by attaching the bottom part to the Frame by first lining up the holes. Insert a Small Washer (L) onto the Hexagon bolt M10x60 (J) then slide through the first hole. On the opposite side attach another Small Washer (L) and a Small Lock Nut (M). Tighten down with a wrench and an allen key. Finally and attach the Small Nut Cap (I).



4. Finish the Installation of the Actuator (H) by attaching the top part to the Lifting Arm (G) by first lining up the holes. Insert a Small Washer (L) onto the Hexagon bolt M10x60 (J) then slide through the top hole on the actuator. On the opposite side attach another Small Washer (L) and a Small Lock Nut (M). Tighten down with a wrench and an allen key. Finally and attach the Small Nut Cap (I).
5. Insert the (R) Cord Holding Tabs to the (Q) Electric Control Box.
6. Insert both the plug for the (S) Remote and the plug for the (T) Power Cord into the bottom of the Control Box.

NOTE:

There is also a (U) Power Socket Cover for when the power cord is not plugged into the device.

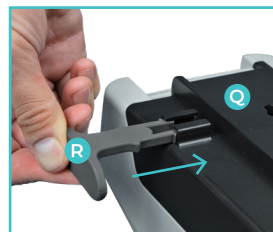
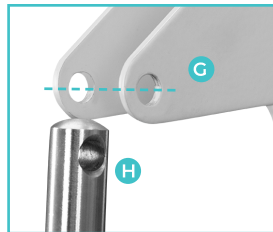

7. Slightly unscrew the mounting screws (2) on the rear of the Main Frame enough for the (Q) electrical control box to slide onto the screw. For an extra secure placement you can slide off the physical battery from the Control Box and turn Lock function clockwise over the head of the top bolt to really lock the box into place.



Step 1

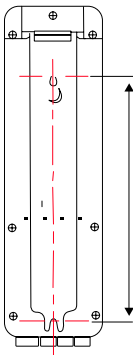

Step 2

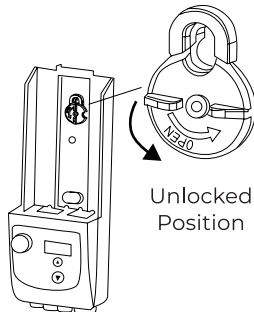
Unlocked
Position

Step 3

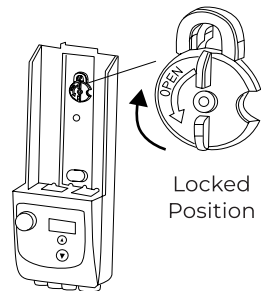
Locked
Position

CONTROL BOX

Features:

- Software and Hardware over-current protection
- Actuator's Over-duty Protection with sign on LCD
- Connection for up to two actuators
- Emergency stop button
- Internal charger
- LCD-display showing battery capacity and indicating when the battery needs recharging.
- Low batter alarm
- Duty cycle 10% (max. 2 mins continuous use)
- Ambient temperature: +5 to 40°C
- Standard Protection Class: IP 65
- Pulling-proof design to lock the AC plug



Options:

- Smart charging function for longer battery life
- Battery volume indicator on battery pack
- Soft start and stop for lifting actuator

NOTE:

Recommended charging time is 2 hours. To preserve battery life do not charge for more than 4 hours at a time.

LCD Display Function

Four continuous beeps will be heard when batter volume is only one block left, the battery must be charged immediately.



= Over Load



= Overduty (overused)



= Battery Volume

Low Batt. = Battery Low (Blink)



Battery is charged to around 100%



Battery is charged to around 75%



Battery is charged to around 50%



Battery is charged to around 25%

Emergency Stop

Emergency Stop button interrupts the power supply to the actautors and makes the actuators stop immediately in case of sudden danger.

Lock

Press the button as shown, then the control device is locked in position.

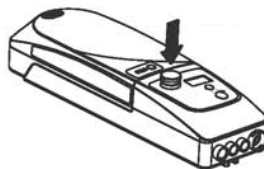

Unlock

Release the red button clockwise, the control device works as usual.

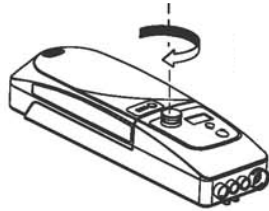

WARNING:

It's strongly recommended that user presses this button in case this device will not be used for over 3 days, so that the power from battery pack stays longer.

Lowering Button

In case the handset malfunctions or no handset is available, use the Lowering Button to retract the actuator.



Connection of Control Device

This device included 4 connections, one for handset, two for actuators and one for power supply.

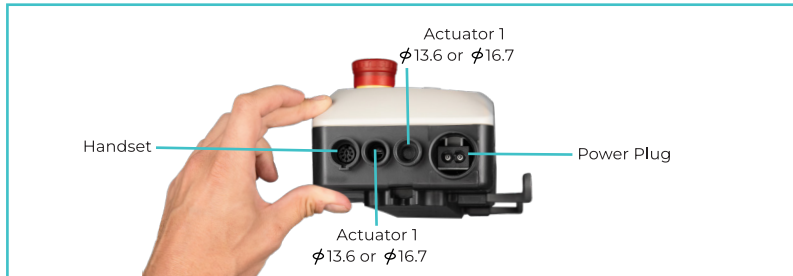

Features of Power Plug

1. C-clamp: When the battery is being charged, insert this C-clamp to secure the power plug.
2. Waterproof Cover: When control is being used, this cover can be inserted to stop water.

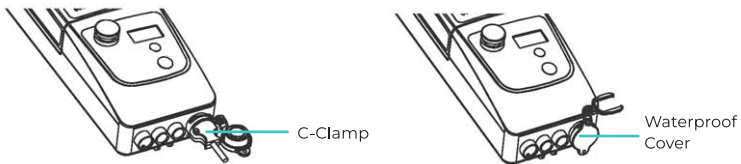

CONTROL BOX INSTALLATION

1. Put two mounting bolts (M5 having 8mm head) onto the hoist according to the drawing Step 1.
2. Turn the locker to the open direction (CCW), then mount Control Box on the mounting bolts or hoist.
3. Turn the locker clockwise for around 90 degrees to lock the Control Box.

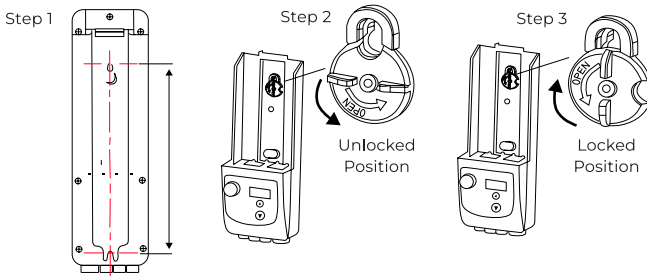

Remove and Insert Battery Pack

Remove

1. Press button A and pull out in the direction B (Fig 1)

Insert

1. Put the battery pack all the way down to position as Fig. 2.
2. Slide in to the direction C while having the release button pressed (Fig 3), make sure the battery pack won't slide back off by pulling the battery pack without pressing the release button.

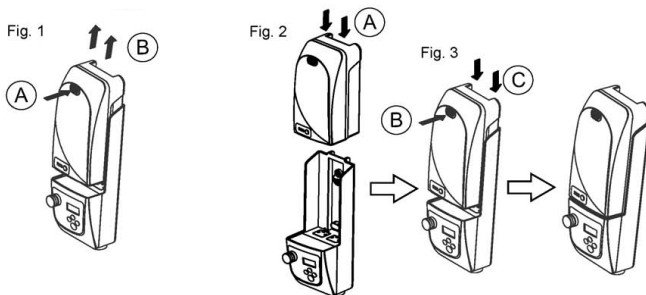

HANDSET OPERATION

1. Press ① to lift up the hoist.
2. Press ② to lower down the hoist.



FUNCTIONAL DIAGRAM

Control Box (CBP2+BTP1)

Charger (CHP1+BTP1)

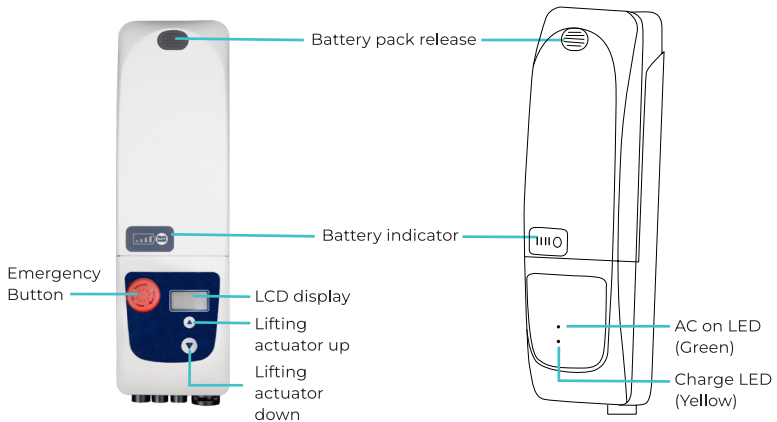

CONTROL BOX SPECIFICATIONS

| | |
|------------------------------------|-------------------------------------|
| Input Voltage | 220-240V AC 50Hz / 110-120V AC 60Hz |
| Output Voltage | 24 VDC (ϕ 6.35 metal plug) |
| Battery Pack | 24VDC 5AH |
| Maximum Current | 10A |
| Power Consumption | Standby: 0.42W |
| Control | Panel and Handset |
| Protection Class | IP65 / IP54 |
| Duty Cycle | 10% (max. 2 mins. continous) |
| Over-duty Alarm | by LCD |
| Battery Status | by LCD |
| Low Battery Alarm | by Buzzer and LCD |
| Connection for Two actuator | Yes (optional) |
| Ambient Temperature | 5°C to 40°C (41°F to 104°F) |
| Storage Temperature | -20°C to 60°C (-4°F to 140°F) |

Base Width Adjustment:

The width of the base can be adjusted by pedal. Press on the left pedal for a wider base and the pedal on the right for a more narrow base.



Lock and Unlock Rear Wheels:

The rear wheels can be locked. Use your foot to lock and unlock the rear wheels.

**ATTENTION:**

It is unnecessary to lock the rear wheels for most ascent and descent movements. Only lock the wheels when the lift moves and may cause personal injury.

WARNING:

Locking the rear wheels of the lift may increase the risk of tipping during the ascent and descent of a patient.

OPERATION OF PATIENT LIFT

Keep the lifting arm and patient's body vertical. Make sure the operation of the lift is correct each time.

WARNING:

An imbalance during ascent increases the risk of tipping. Always use on flat grounds.

Check and ensure the following items after finishing the assembling process:

- All connections are properly locked and there are no loose parts.
- The hydraulic cylinder rises properly after turning on the valve switch and while operating the handle up and down.
- The hydraulic cylinder descends properly with weight loaded after turning off the valve switch.
- The 4 casters function properly.

CARE AND MAINTENANCE

- Washing with a household cleaning agent.
- Use a dried cloth with a diluted neutral detergent to wipe any stains or grease.
- Lacquer thinner, gasoline, Kerosene, volatile solvents, wax, sponges, and abrasive brushes are not permitted.

TROUBLESHOOTING

| | |
|----------------------------------|---|
| Patient Lift Doesn't Work | Check if there is any damage to the hydraulic cylinder. |
|----------------------------------|---|

MAINTENANCE RECORD

| Date | Fault | Cause | Remark |
|------|-------|-------|--------|
| | | | |
| | | | |
| | | | |
| | | | |
| | | | |
| | | | |

SPECIFICATIONS

| | |
|------------------|-----------------------------|
| Device Name | Electric Patient Lift |
| Model/type | MOB1076 |
| Product Size | 47.25"×24.5" ×48.25" |
| Fork Range | 24.5" - 31.5" adjustable |
| Lifting Range | 31" (lowest), 68" (highest) |
| Maximum Capacity | 400 lbs. |
| Net Weight | 86 lbs. |

WARNINGS

- Lift should only be operated by adults with proper knowledge of how to handle a lift and properly position a lift sling. Consult with a care giver before attempting to use this device with no prior knowledge of how it works.
- Maximum User Weight: 400lbs

NOTE:

Make sure the sling you purchase can hold equal to or more weight.

- Always gauge the speed of the hydraulic pumps lowering ability per patient. Never release the valve all the way and drop the patient at full speed without first slowly testing the speed.
- Always check the position of the sling and how it is placed around your patient and placed on the four lift rings. Each sling has multiple height positions, make sure the height positions are all equal so your patient is balanced when being lifted.
- An imbalance during ascent increases the risk of tipping. Always use on flat grounds.



HAVE MORE QUESTIONS?

Check out our list of Frequently Asked Questions at
[vhealth.link/vmd](https://vivehealth.com/vmd) for helpful answers.



And if that doesn't answer your question, our
customer service team would love to help!
Feel free to connect with them by phone,
e-mail, or chat on our website

service@vivehealth.com
1-800-487-3808
vivehealth.com

Distributed by



8955 Fontana Del Sol Way
Naples, FL 34109
1-800-487-3808
www.vivehealth.com