

*Need a part **CLICK HERE***



*[www.shop.mobilemobilityservices.com](http://www.shop.mobilemobilityservices.com)*

## **Lift Chair Service Guide**



**This Service Guide contains:  
Troubleshooting  
Replacement Instructions  
Illustrated Parts Diagrams**

***Need parts **CLICK HERE*****

**Contact Information:**

Golden Technologies  
401 Bridge Street  
Old Forge, PA 18518

Toll-free: 800-624-6374  
Fax: 800-628-5165

Lift Chair/Bed Tech: x645  
Mobility Tech: x648  
VA Tech: x647

Email: [parts@goldentech.com](mailto:parts@goldentech.com)

# Table of Contents

About the Lift Chair Service Guide.....	3
Lift Chair Components.....	3-5
General Trouble Shooting.....	6
Tools Required.....	6
Models Quick Reference.....	7
<b>Replacement Instructions.....</b>	<b>8-15</b>
Smart Tek Hand Control.....	8
Hand Control Extension Wire.....	8
Back Assembly.....	9
Control Box.....	9
Lift Motor.....	9
Lift Frame.....	10
Arm Assembly.....	10-11
Scissor Mechanism.....	11-12
Recline Bar.....	12-13
Seat Assembly.....	13-14
Recline Straps.....	14-15
Scissor Mechanism Parts.....	16
<b>Electrical Systems.....</b>	<b>17-22</b>
Single Motor.....	17
Dual Motor.....	18
Triple Motor.....	19
Heat and Massage.....	20
MaxiComfort.....	21
Trouble Shooting with <i>SMART TEK</i> .....	22
<b>Lift Frames.....</b>	<b>23-41</b>
LM5100.....	23-25
LM5120.....	26-28
LM6111.....	29-31
LM5000C.....	32-34
LM502.....	35-39
LM906.....	40-41
MaxiComfort Recline Mechanism.....	42
Power Connections.....	43
Back Installation.....	43
MaxiComfort Back Installation.....	44
Hand Controls.....	45-47
Grease Points.....	48
Lift Chair Cut Away.....	49
Lift Chair Boxing Instructions.....	50-51

## About the Lift Chair Service Guide

This service guide provides you with the information necessary to repair Golden Technologies 3-position, 2-position, and MaxiComfort recline lift chairs. The troubleshooting scenarios in this manual consist of procedures that enable you to systematically trace and correct faults in the system, replacement procedures, and exploded views of available parts. Most replacement instructions apply to all the lift chairs in this service manual, but some of them are specific to individual chairs.

### ***Before troubleshooting, check the following:***

- Make sure that the lift chair is plugged into a working wall outlet.
- Check the wall outlet circuit breaker.
- Visually check terminals for corrosion.
- Check wires for missing insulation.
- Check connectors for unseated pins.
- Ensure LED lights are on. (Refer to “Trouble Shooting with *SMART TEK*” on page 22).

### ***Information required prior to making a service call:***

- Serial Number
- Date of Purchase
- Description of the problem with the lift chair

## Lift Chair Components

Lift chairs are powered by 24V DC transformers that plug into standard wall outlets and operate on standard 120V AC electricity. The lift chair control system is made up of the following components:

- |                  |                        |                 |
|------------------|------------------------|-----------------|
| • Motor(s)       | • Transformer          | • Massage Unit* |
| • Hand Control   | • Battery Backup Wire* | • Control Unit* |
| • Extension Wire | • Heat Unit*           | • Junction Box* |

\* Only on Selected Models

### **Component:** Motor

**Location:** Between the lift frame and the seat.

**Function:** Provides lift and recline.

**Connections:** Each motor is physically connected to the chair through the lift frame and the motor straps. Each motor is electrically connected to either a control unit or directly to the hand control.

**Failure Signs:** Chair will not lift and/or recline. Motor may become noisy just before failure.

**Tests:** See “Trouble Shooting with *SMART TEK*” on page 22.

**Expected Readings:** See “Trouble Shooting with *SMART TEK*” on page 22.

**Serviceable:** Must be replaced.

### **Component:** Hand Control (Lift/Recline or Recline Only)

**Location:** On the arm of the chair.

**Function:** Provides user interface for lift/recline or recline only.

**Connections:** Connected to either the control unit or the motor.

**Failure Signs:** Chair will not lift and/or recline.

**Tests:** See “Trouble Shooting with *SMART TEK*” on page 22.

**Expected Readings:** See “Trouble Shooting with *SMART TEK*” on page 22.

**Serviceable:** Must be replaced.

**Component:** Extension Wire

**Location:** Between the lift frame and the chair frame.

**Function:** Provides connection from the hand control to the motor or control box.

**Connections:** From the quick disconnect in the pocket to the motor or control box.

**Failure Signs:** Chair will not lift/recline.

**Tests:** Test continuity.

**Expected Readings:** Open Circuit.

**Serviceable:** Must be replaced.

**Component:** Transformer

**Location:** Next to chair.

**Function:** Converts AC to DC. Also provides power during a power failure.

*Note: Power during a power failure only applies to the lift/recline or recline only functions.*

**Connections:** Wall outlet and either control box or motor.

**Failure Signs:** Chair will not operate.

**Tests:** Test for voltage at connection to chair.

**Expected Readings:** Approximately 27VDC.

**Serviceable:** Must be replaced.

**Component:** Control Box (500-lb. chair only)

**Location:** On the lift frame.

**Function:** Provides connectivity for motors, hand control, and transformer.

**Connections:** Connected to the motor(s), hand control, and transformer.

**Failure Signs:** Chair will not lift and/or recline.  
Clicking noise. Motors out of sync.

**Tests:** AC Voltage

**Expected Readings:** 27 - 32 VAC. See figure 1.

**Serviceable:** Must be replaced.

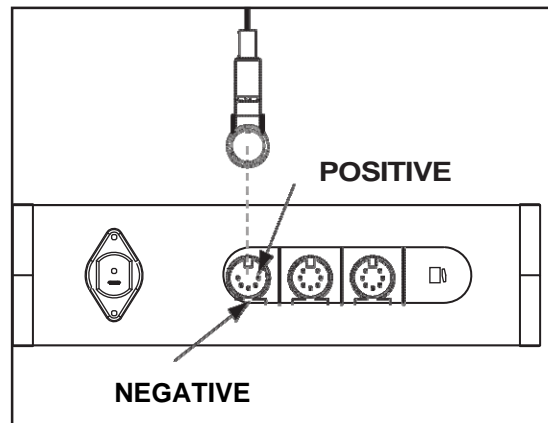

**Figure 1. Control Box**

**Component:** Heat Pad

**Location:** On the chair seat.

**Function:** Provides heat.

**Connections:** Connected to the control box.

**Failure Signs:** No heat.

**Tests:** Resistance.

**Expected Readings:** (Far Infrared Heat only, 1 - 6 ohms across the two connector pins).

**Serviceable:** Must be replaced.

**Component:** Massage Unit

**Location:** On the seatback or the seat.

**Function:** Vibrates to provide massage.

**Connections:** Connected to the junction box.

**Failure Signs:** Massage will not work when selected.

**Tests:** Check for DC voltage.

**Expected Readings:** Approximately 13.8 DC Volts.

**Serviceable:** Must be replaced.

**Component:** Hand Control (Heat/Massage or Infrared Heat Only)

**Location:** On the arm of the chair.

**Function:** Provides user interface for heat/massage or Infrared heat only.

**Connections:** Connected to the control box.

**Failure Signs:** Heat/Massage or Infrared Heat Only will not work.

**Tests:** See "Hand Controls" on pages 45-47. For a more complete guide, refer to the manufacturer's owner's manual.

**Expected Readings:** See "Hand Controls" on pages 45-47. For a more complete guide, refer to the manufacturer's owner's manual.

**Serviceable:** Must be replaced.

### **Battery Back Up System**

1. Batteries should be replaced after one use.

2. Batteries should be changed yearly.

For a complete explanation of the battery back up system, refer to the owner's manual.

# General Trouble Shooting

## Problem: 1

Chair is in the lift position and will not descend, or chair is in the recline position and will not lift.

## Solution:

If the chair is stuck in the lift position, press the down button; if the chair is stuck in the recline position, press the up button. While pressing the appropriate button, listen to hear if the motor is running.

Ensure LED lights are on. (Refer to "Trouble Shooting with *SMART TEK*" on page 22).

## Problem 2

If you don't hear the motor running, follow these steps.

- A) Check to see if the chair is securely plugged in.
- B) See if the outlet is activated by a wall switch.
- C) Try plugging the chair into a different outlet. (Sometimes the socket is worn and will not handle the amps needed for operation.)
- D) Check wiring on both power cord for motor and switch cord for breakage or fraying.
- E) Plug the new hand control into motor or into extension and try for chair response.
- F) If still no response, see "Trouble Shooting with *SMART TEK*" on page 22.

## Problem 3

If you hear the motor running, but the chair won't move or partially moves, check for the following:

- A) Inspect lift frame for possible breakage.
- B) Inspect push tube or gear casing for breakage.
- C) Gears may be stripped in gear casing in motor assembly.
- D) Push tube may be stripped or the fork head may be broken.

## Tools Required:

The following tools are needed to service ***Golden Technologies*** lift chairs.

- # 8, 9 or 10 flat head screw driver
- P2 & P3 Phillips head screw driver
- T30 torx bit
- Wired or wireless drill (*Note: Driver bits can be used to speed up the repair process*).
- Chair stand
- Spare hair pins
- Zip ties
- 7/16 box head wrench
- 3/8 box head wrench
- 1/2 box head wrench
- Needle nose pliers
- Volt meter
- Clippers or scissors
- Retracto knife
- Spare rags
- Large vice grip
- White lithium grease or Zep 2000

If servicing a lift chair with the MaxiComfort mechanism, you will also need:

- 7/16 & 3/8 ratchet wrench
- 5/32 Allen wrench



## Models Quick Reference

Model	Series	Size	Lift Frame	Recline Bar	Motor	Transformer	Hand Control	Recline Mech.
PR-401	Traditional	Medium	LM5100	Medium	Single	Standard US	2 Button	3 way
PR-401L	Traditional	Large	LM5120	Large	Single	Standard US	2 Button	3 way
PR-747	Traditional	Medium	LM5100	Medium	Single	Standard US	2 Button	3 way
PR-643	Traditional	Medium	LM5100	Medium	Single	Standard US	2 Button	3 way
PR-410	Signature	Large	LM5120	Large/24	Single	Standard US	2 Button	3 way
PR-751TY	Signature	Medium	LM5120	Medium	Single	Standard US	2 Button	3 way
PR-752	Signature	Medium	LM5100	Medium	Single	Standard US	2 Button	3 way
PR-451	Signature	Medium	LM5100	Medium	Single	Standard US	2 Button	3 way
PR-906	Signature	Med/Large	LM906	None	906	Standard US	2 Button	906
PR-756MC	Maxi Comfort	Medium	LM5100	Medium	Maxi	Standard US	Auto Drive	Maxi
PR-756L	Maxi Comfort	Large	LM5120	Large	Maxi	Standard US	Auto Drive	Maxi
PR-506	Maxi Comfort	Medium	LM5100	Medium	Maxi	Standard US	Auto Drive	Maxi
PR-505JP	Maxi Comfort	Jr. Petite	LM5100	Petit	Maxi	Standard US	Auto Drive	Maxi
PR-505S	Maxi Comfort	Small	LM5100	Small	Maxi	Standard US	Auto Drive	Maxi
PR-505M	Maxi Comfort	Medium	LM5100	Medium	Maxi	Standard US	Auto Drive	Maxi
PR-505L	Maxi Comfort	Large	LM5120	Large	Maxi	Standard US	Auto Drive	Maxi
PR-510	Maxi Comfort	Medium	LM5100	Medium	Maxi	Standard US	Auto Drive	Maxi
PR-501JP	Comforter	Jr. Petite	LM5100	Petit	Single	Standard US	2 Button	3 way
PR-501S	Comforter	Small	LM5100	Small	Single	Standard US	2 Button	3 way
PR-501M	Comforter	Medium	LM5100	Medium	Single	Standard US	2 Button	3 way
PR-501L	Comforter	Large	LM5120	Large	Single	Standard US	2 Button	3 way
PR-501T	Comforter	Tall	LM5120	Large	Single	Standard US	2 Button	3 way
PR-501S-23	Comforter Wide	Wide	LM5120	Large	Single	Standard US	2 Button	3 way
PR-501M-26D	Comforter Wide	Medium	LM6111	Medium/wide	Dual	Standard US	2 Button	3 way
PR-501L-26D	Comforter Wide	Large	LM6111	Medium/wide	Dual	Standard US	2 Button	3 way
PR-501T-28D	Comforter Wide	Tall	LM6111	Tall/Wide	Dual	Standard US	2 Button	3 way
PR-502	Comforter Wide	Wide	LM502	502	Triple	Standard US	6 Button	502
PR-200	Value	Medium	LM5000C	Capri	Single	Standard US	2 Button	2 way
PR-355M	Value	Medium	LM5100	Medium	Single	Standard US	2 Button	3 way
PR-355L	Value	Large	LM5120	Large	Single	Standard US	2 Button	3 way
PR-359M	Value	Medium	LM5100	Medium	Single	Standard US	2 Button	3 way
PR-359L	Value	Large	LM5120	Large	Single	Standard US	2 Button	3 way



# Replacement Instructions

## Smart Tek Hand Control Replacement

**Tools Needed:** None

1.  **WARNING Unplug the transformer from the wall outlet.**
2. Unplug the motor power cable.
3. Reach down into the pocket until you feel the disconnect latch on the extension cable.
4. Pull back on the disconnect latch.
5. Put one hand on the back of the extension wire plug base and one on the hand control plug base and pull the two pieces apart.
6. Plug in the new Smart Tek hand control to the extension cable.
7. Push forward on the disconnect latch. Make sure it engages fully with the hand control plug base.
8. Reconnect the motor power cable.
9. Plug the transformer into the wall outlet and test the hand control.

## Hand Control Extension Wire Replacement

**Tools Needed:** Phillips head screwdriver, wire cutter, staple remover, stapler, zip ties, and a chair stand.

1.  **WARNING Unplug the transformer from the wall outlet.**
2. Unplug the transformer from the battery backup cable.
3. Reach down into the chair's side pocket until you feel the disconnect latch on the hand control extension.
4. Pull back on the disconnecting latch.
5. Put one hand on the back of the extension wire plug base and one on the hand control plug base and pull the two pieces apart.
6. Gently push the chair over onto the footrest, turn it upside down or, gently push it over onto its side, opposite of the hand control.
7. Use a Phillips screwdriver to remove the wire clamp used to secure the extension cable to the bottom of the armrests. Make sure you save the clamp and screw.
8. Remove a few staples on the arm assembly to allow the extension wire to be pulled out through the fabric pocket.
9. Pull the extension cable through the fabric pocket.
10. Locate the zip ties that hold the extension wire to the lift frame. Note their location.
11. Cut these ties.
12. Unplug the extension cable from the control box.
13. Plug the new extension cable into the control box.
14. Secure it to the lift frame with zip ties. Use the same locations as the old extension cable.
15. Insert the extension cable into the fabric pocket.
16. Reinstall the staples that were removed in step 8.
17. Reinstall the wire clamp.
18. Turn the chair back over onto its legs.
19. Plug in the Smart Tek hand control to the extension cable.
20. Push forward on the disconnecting latch. Make sure it engages fully with the hand control plug base.
21. Clip the Smart Tek hand control to the black plastic hook on the side of the chair arm.
22. Plug the battery backup back into the transformer.
23. Plug the transformer back into the wall outlet and test.

## Back Assembly Replacement (500-lb. and 3-position)

**Tools needed:** 7/16 in. socket wrench

1. Press the Up Button on the hand control until the footrest is about parallel to the floor.
2.  **WARNING** **Unplug the transformer from the wall outlet.**
3. Using the 7/16 in. socket wrench, remove the (2) flange lock nuts located on both sides of the back.
4. Pull the back flap away from the Velcro.
5. Work the back assembly out one side at a time pulling the threaded studs out of the scissor mechanisms.
6. Install new back.

## Control Box Replacement (500-lb. only)

**Tools needed:** Wire cutters, replacement zip ties, and a chair stand.

1.  **WARNING** **Unplug the transformer from the wall outlet.**
2. Unplug the battery backup cable from the transformer.
3. Gently push the chair over onto the footrest, turn it upside down or, gently push it over onto its side, opposite of the hand control.
4. Unplug the motor(s), hand control extension, and battery backup from the control box.
5. Cut the wire ties that fasten the control box and the motor(s) to the lift frame and remove it.
6. Use wire ties to fasten a new control box onto the lift frame.
7. Plug the motor(s), hand control extension, and battery backup into the new control box.
8. Gently turn the chair back over.
9. Plug the battery backup cable into the transformer.
10. Plug the transformer into the wall outlet and test.

## Lift Motor Replacement

**Tools needed:** Needle nose pliers, zip ties, and a chair stand.

1.  **WARNING** **Unplug the transformer from the wall outlet.**
2. Unplug the battery backup cable from the transformer.
3. Gently push the chair over onto the footrest, turn it upside down or, gently push it over onto its side, opposite of the hand control.
4. Unplug the motor(s) from the control unit (501M26, 501L26, 501T28), or from the hand control extension and the transformer.
5. Remove the hitch pin and the clevis pin that fastens the bottom of the motor(s) to the lift frame.
6. Remove the hitch pin, the clevis pin, washers, and spacers that fasten the top of the motor(s) to the recline straps.
7. Use the hitch pin and clevis pin to fasten the bottom of the new motor to the lift frame.
8. Use the hitch pin, clevis pin, washers, and spacers to fasten the top of the lift recline to the recline straps.
9. Connect the new motor(s) to the control unit.
10. Turn the chair over onto the lift frame.
11. Plug the battery backup cable into the transformer.
12. Plug the transformer into the wall outlet and test.

## Lift Frame Replacement

**Tools needed:** Needle nose pliers, T30 Torx screw bit, wire cutters, replacement zip ties, and a chair stand.

1.  **WARNING Unplug the transformer from the wall outlet.**
2. Unplug the battery backup cable from the transformer.
3. Gently push the chair over onto the footrest, turn it upside down or, gently push it over onto its side, opposite of the hand control.
4. Unplug the motor(s), hand control extension, and battery backup from the control box.
5. Cut the wire ties that fasten the control box to the lift frame and remove it (500-lb. only.)
6. Remove the eight (8) T30 lag screws that hold the lift frame to the arm assembly.
7. Cut the wire ties that hold the hand control extension wire to the frame and place the wire to the side.
8. Remove the hitch pin(s), the clevis pin(s), and the washers that fasten the recline strap(s) to the recline bar.
9. Lift the lift frame out of the chair shell.

**Note:** When installing the new lift frame the footboard must be completely closed when you fasten the lift frame to the armrest assembly or the footboard will not close properly.

10. Cut the wire ties that fasten the motor cables to the lift frame.
11. Remove the hitch pin(s) and the clevis pin(s) that fasten the bottom of the motor(s) to the lift frame.
12. Remove the hitch pin(s), the clevis pin(s), spacers, and washers that fasten the recline straps(s) to the lift frame.
13. Use the hitch pin(s), the clevis pin(s), spacers, and washers to fasten the recline strap(s) to the new lift frame.
14. Use the hitch pin(s) and the clevis pin(s) to fasten the bottom of the motor(s) to the new lift frame.
15. Place the new lift frame onto the chair shell.
16. Use the hitch pin(s), the clevis pin(s), and the washers to fasten the recline strap(s) to the recline bar.
17. Use the eight (8) T30 lag screws to fasten the lift frame to the arm assembly.
18. Use two wire ties to fasten the hand control extension to the lift frame.
19. Use wire ties to fasten the control box to the lift frame.
20. Plug the motor(s), hand control extension, and battery backup into the control box.
21. Gently push the chair back over.
22. Plug the battery backup cable into the transformer.
23. Plug the transformer into a wall outlet and test.

## Arm Assembly Replacement

**Tools needed:** Needle nose pliers, P2 Phillips screwdriver, T30 screw bit, wire cutters, zip ties, 3/8 in. socket, a stool or stand for placing the chair upside down.

1.  **WARNING Unplug the transformer from the wall outlet.**
2. Unplug the battery backup cable from the control box.
3. Reach down into the chair's side pocket until you feel the disconnect latch on the hand control extension.
4. Pull back on the disconnecting latch.
5. Put one hand on the back of the extension wire plug base and one on the hand control plug base and pull the two pieces apart.
6. Gently push the chair over onto the footrest, turn it upside down or, gently push it over onto its side, opposite of the hand control.

7. Use a Phillips screwdriver to remove the wire clamp used to secure the extension cable to the bottom of the armrests. Make sure you save the clamp and screw.
8. Remove a few staples on the arm assembly to allow the extension wire to be pulled out through the fabric pocket.
9. Pull the extension cable through the fabric pocket.
10. Remove the eight (8) T30 lag screws that hold the lift frame to the arm assembly.
11. Remove the hitch pin(s), the clevis pin(s), and the washers that fasten the recline strap(s) to the recline bar.
12. Lift the lift frame out of the chair shell and place it off to the side.
13. Use the 3/8 in. socket to remove the four (4) bolts that fasten each scissor mechanism to the arm assembly.



**WARNING** While this next step can be done alone, it does require extra attention. You must remove the arm assembly without twisting the frame. Excessive twisting will cause the board holding the arms together to snap.

14. Stand behind the chair and pull the arms away from the chair being careful not to get the material snagged in the scissor mechanisms.
15. Place the arm assembly to the side.
16. Place the new arm assembly in place so that the bolt holes in the scissor mechanisms line up with the bolt holes in the armrest.
17. Install the four (4) bolts that fasten each scissor mechanisms to the new arm assembly.
18. Make sure the footboard is completely closed.

**Note:** When installing the lift frame the footboard must be completely closed when you fasten the lift frame to the armrest assembly or the footboard will not close properly.

19. Place the lift frame onto the chair shell.
20. Use the hitch pin(s), the clevis pin(s), and the washers to fasten the recline strap(s) to the recline bar.
21. Use the eight (8) T30 lag screws to fasten the lift frame to the arm assembly.
22. Reinstall the staples that were removed in step 8.
23. Reinstall the wire clamp.
24. Gently turn the chair back over onto its legs.
25. Plug in the Smart Tek hand control to the extension cable.
26. Push forward on the disconnecting latch. Make sure it engages fully with the hand control plug base.
27. Clip the Smart Tek hand control to the black plastic hook on the side of the chair arm.
28. Plug the battery backup back into the control box.
29. Plug the transformer back into the wall outlet and test.

## Scissor Mechanism Replacement

**Tools needed:** Needle nose pliers, P2 Phillips screwdriver, T30 screw bit, wire cutters, zip ties, 3/8 in. socket, a stool or stand for placing the chair upside down.



1. **WARNING** Unplug the transformer from the wall outlet.
2. Unplug the battery backup cable from the transformer.
3. Reach down into the chair's side pocket until you feel the disconnect latch on the hand control extension.
4. Pull back on the disconnecting latch.
5. Put one hand on the back of the extension wire plug base and one on the hand control plug base and pull the two pieces apart.

6. Gently push the chair over onto the footrest, turn it upside down or, gently push it over onto its side, opposite of the hand control.
7. Unplug the transformer and the hand control extension from the motor (or control box.)
8. Remove the eight (8) T30 lag screws that hold the lift frame to the arm assembly.
9. Remove the hitch pin(s), the clevis pin(s), and the washers that fasten the recline strap(s) to the recline bar.
10. Remove the hand control extension wire clamp.
11. Lift the lift frame out of the chair shell and place it off to the side.
12. Use the 3/8 in. socket to remove the four (4) bolts that fasten each scissor mechanism to the arm assembly.



**WARNING** While this next step can be done alone, it does require extra attention. You must remove the arm assembly without twisting the frame. Excessive twisting will cause the board holding the arms together to snap.

13. Stand behind the chair and pull the arms away from the chair being careful not to get the material snagged in the scissor mechanisms.
14. Place the arm assembly to the side.
15. Use the Phillips screwdriver to remove the screws that fasten the scissor mechanism to the footboard.
16. Use the 3/8 in. socket to remove the bolts that fasten the scissor mechanism to the seat and to the footboard.
17. Use the 3/8 in. socket to install the bolts that fasten the new scissor mechanism to the seat and the footboard.
18. Use the Phillips screwdriver to install the screws that fasten the new scissor mechanism to the footboard.
19. Place the arm assembly in place so that the bolt holes in the scissor mechanisms line up with the bolt holes in the armrest.
20. Install the four (4) bolts that fasten each scissor mechanisms to the arm assembly.
21. Make sure the footboard is completely closed.

**Note:** When installing the lift frame the footboard must be completely closed when you fasten the lift frame to the armrest assembly or the footboard will not close properly.

22. Place the lift frame onto the chair shell.
23. Use the hitch pin(s), the clevis pin(s), and the washers to fasten the recline strap(s) to the recline bar.
24. Use the eight (8) T30 lag screws to fasten the lift frame to the arm assembly.
25. Reinstall the hand control extension wire clamp.
26. Plug the transformer and hand control extension into the motor or control box.
27. Plug the battery backup back into the transformer.
28. Plug the transformer back into the wall outlet and test.
29. Reinstall the seatback (if removed).

## Recline Bar Replacement

**Tools needed:** Needle nose pliers, P2 Phillips screwdriver, T30 screw bit, wire cutters, zip ties, 3/8 in. socket, a stool or stand for placing the chair upside down.



1. **WARNING** Unplug the transformer from the wall outlet.
2. Unplug the battery backup cable from the transformer.

3. Reach down into the chair's side pocket until you feel the disconnect latch on the hand control extension.
4. Pull back on the disconnecting latch.
5. Put one hand on the back of the extension wire plug base and one on the hand control plug base and pull the two pieces apart.
6. Gently push the chair over onto the footrest, turn it upside down or, gently push it over onto its side, opposite of the hand control.
7. Remove the eight (8) T30 lag screws that hold the lift frame to the arm assembly.
8. Remove the hitch pin(s), the clevis pin(s), and the washers that fasten the recline strap(s) to the recline bar.
9. Remove the hand control extension wire clamp.
10. Lift the lift frame out of the chair shell and place it off to the side.
11. Use the 3/8 in. socket to remove the four (4) bolts that fasten each scissor mechanism to the arm assembly.



**WARNING** While this next step can be done alone, it does require extra attention. You must remove the arm assembly without twisting the frame. Excessive twisting will cause the board holding the arms together to snap.

12. Stand behind the chair and pull the arms away from the chair being careful not to get the material snagged in the scissor mechanisms.
13. Place the arm assembly to the side.
14. Use the 1/2 in. socket to remove the bolts that fasten the recline bar to the seat.
15. Use the 1/2 in. socket to install the bolts that fasten the new recline bar to the seat.
16. Place the arm assembly in place so that the bolt holes in the scissor mechanisms line up with the bolt holes in the armrest.
17. Install the four (4) bolts that fasten each scissor mechanisms to the arm assembly.
18. Make sure the footboard is completely closed.

**Note:** When installing the lift frame the footboard must be completely closed when you fasten the lift frame to the armrest assembly or the footboard will not close properly.

19. Place the lift frame onto the chair shell.
20. Use the hitch pin(s), the clevis pin(s), and the washers to fasten the recline strap(s) to the recline bar.
21. Use the eight (8) T30 lag screws to fasten the lift frame to the arm assembly.
22. Reinstall the hand control extension wire clamp.
23. Plug the battery backup back into the transformer.
24. Plug the transformer back into the wall outlet and test.

## Seat Assembly Replacement

**Tools needed:** Needle nose pliers, P2 Phillips screwdriver, T30 screw bit, wire cutters, zip ties, 3/8 in. socket, and a stool or stand for placing the chair upside down.



1. **WARNING** Unplug the transformer from the wall outlet.
2. Unplug the battery backup cable from the transformer.
3. Reach down into the chair's side pocket until you feel the disconnect latch on the hand control extension.
4. Pull back on the disconnecting latch.
5. Put one hand on the back of the extension wire plug base and one on the hand control plug base and pull the two pieces apart.
6. Gently push the chair over onto the footrest, turn it upside down or, gently push it over onto its side,



opposite of the hand control. You can also remove the seat back.

7. Remove the eight (8) T30 lag screws that hold the lift frame to the arm assembly.

8. Remove the hitch pin(s), the clevis pin(s), and the washers that fasten the recline strap(s) to the recline bar.

9. Remove the hand control extension wire clamp.

10. Lift the lift frame out of the chair shell and place it off to the side.

11. Use the 3/8 in. socket to remove the four (4) bolts that fasten each scissor mechanism to the arm assembly.



**WARNING** While this next step can be done alone, it does require extra attention. You must remove the arm assembly without twisting the frame. Excessive twisting will cause the board holding the arms together to snap.

12. Stand behind the chair and pull the arms away from the chair being careful not to get the material snagged in the scissor mechanisms.

13. Place the arm assembly to the side.

14. Use the Phillips screwdriver to remove the screws that fasten the scissor mechanism to the footboard.

15. Use the 3/8 in. socket to remove the bolts that fasten the scissor mechanism to the seat and to the footboard.

16. Use the 1/2 in. socket to remove the bolts that fasten the recline bar to the seat.

17. Use the 1/2 in. socket to install the bolts that fasten the recline bar to the new seat.

18. Use the 3/8 in. socket to install the bolts that fasten the scissor mechanism to the new seat and the footboard.

19. Use the Phillips screwdriver to install the screws that fasten the new scissor mechanism to the footboard.

20. Place the arm assembly in place so that the bolt holes in the scissor mechanisms line up with the bolt holes in the armrest.

21. Install the four (4) bolts that fasten each scissor mechanisms to the arm assembly.

22. Make sure the footboard is completely closed.

**Note:** When installing the lift frame the footboard must be completely closed when you fasten the lift frame to the armrest assembly or the footboard will not close properly.

23. Place the lift frame onto the chair shell.

24. Use the hitch pin(s), the clevis pin(s), and the washers to fasten the recline strap(s) to the lift frame.

25. Use the eight (8) T30 lag screws to fasten the lift frame to the arm assembly.

26. Reinstall the hand control wire clamp.

27. Plug the motor(s), hand control extension, and battery backup into the control box.

28. Plug the battery backup back into the transformer.

29. Plug the transformer back into the wall outlet and test.

## Recline Straps

**Tools needed:** Needle nose pliers, zip ties, and a chair stand.



1. **WARNING** Unplug the transformer from the wall outlet.

2. Unplug the battery backup cable from the transformer.

3. Gently push the chair over onto the footrest, turn it upside down or, gently push it over onto its side, opposite of the hand control.

4. Remove the hitch pin, clevis pin(s), and washers that fastens the recline straps to the lift frame.

5. Remove the hitch pin(s), clevis pin(s), and washers that fasten the recline straps to the recline bar.



6. Use the hitch pin(s), clevis pin(s), and washers to fasten the new recline straps to the recline bar.
7. Use the hitch pin(s), clevis pin(s), and washers to fasten the new recline straps to the lift frame.
8. Use hitch pin(s), clevis pin(s), washers, and spacers to fasten the top of the motor to the new recline straps.
9. Turn the chair over onto the lift frame.
10. Plug the battery backup cable into the transformer.
11. Plug the transformer into the wall outlet and test.
12. Reinstall the seatback (if removed).

## Scissor Mechanism Parts

Component	Description
RM621	3-Way Recliner Mechs
RM8300	2-Way Recliner Mechs
RM620	MaxiComfort Mechs

We do recommend both sides be replaced.

RM8300

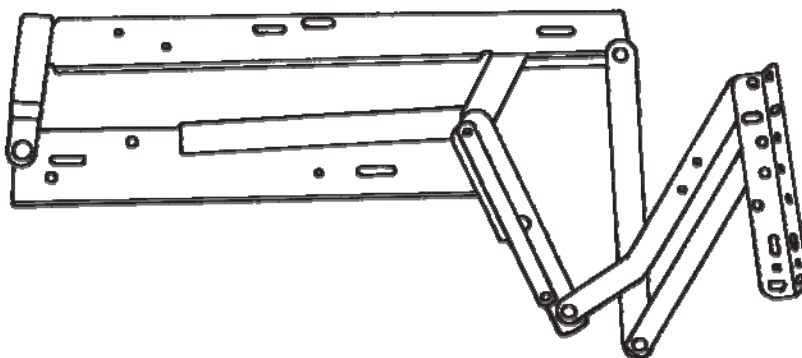

RM621

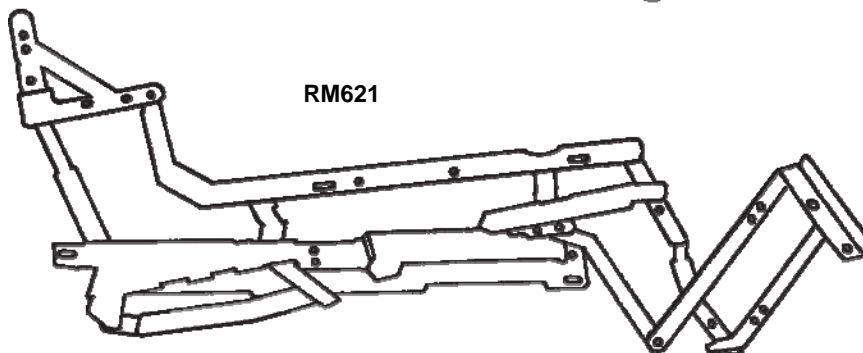

RM620

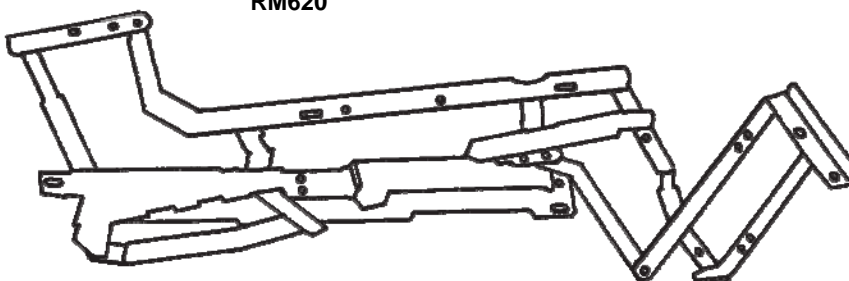

## Single Motor Electrical Diagram

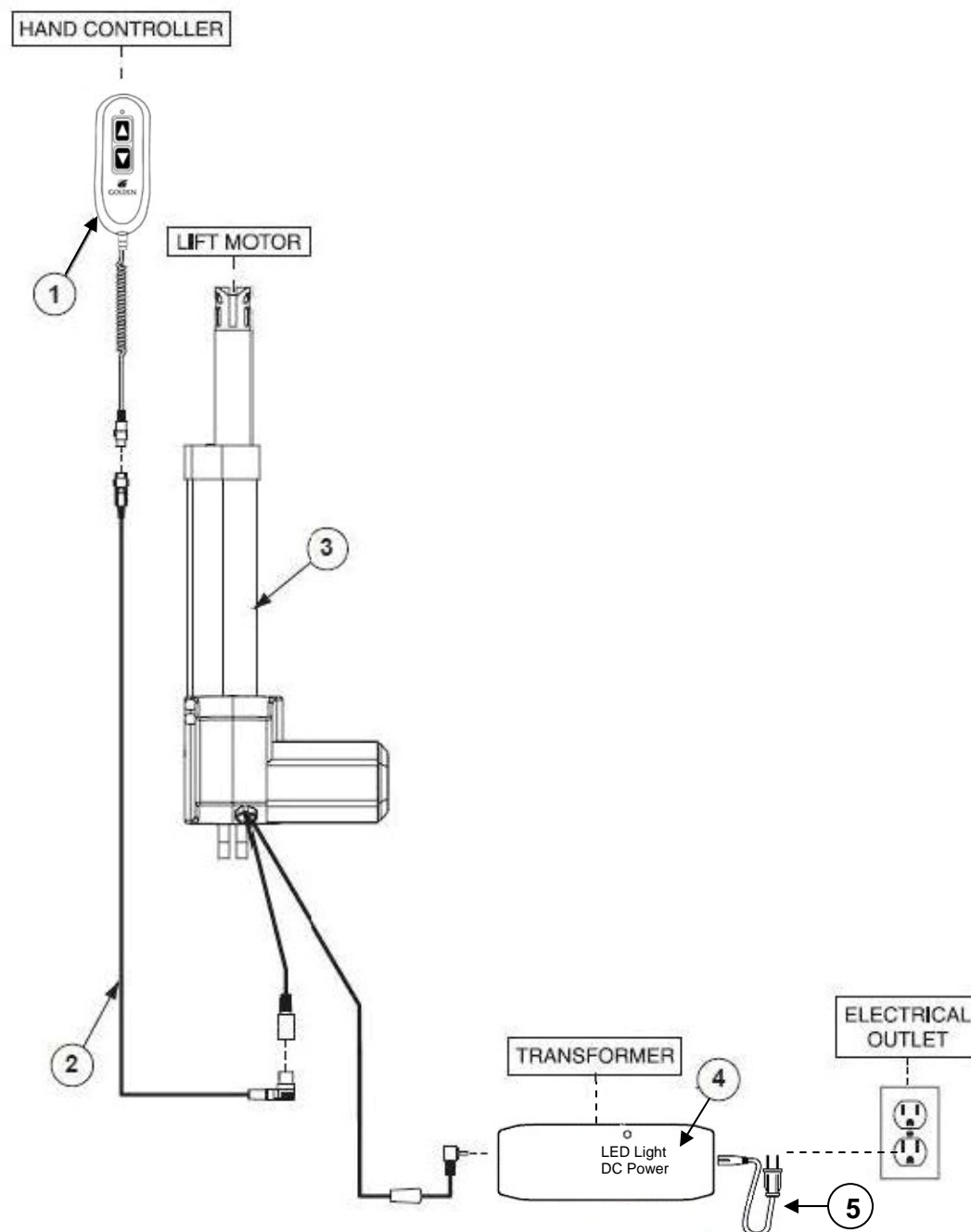

REF #	PART NUMBER	DESCRIPTION	QTY.
1*	ZK1200-HC	Hand Wand, 2 Button LED with Walnut Burl Grain	1
1	ZK-1100-HC	Hand Wand, 2 Button LED with Walnut Burl Grain	1
2*	ZK-20-EXT	Hand Control Extension 62" Long	1
2	ZK-10-EXT	Hand Control Extension 62" Long	1
3	GM1500-LM	Motor Chair Led Non Transformer	1
4	GM1501-A	Motor Chair Transformer	1
5	GM1501-APUS	Transformer Cord	1

### Smart Tek System

Models: PR-401, PR-401L, PR-747, PR-643, PR-410, PR-751TY, PR-752, PR-451, PR-501JP, PR-501S, PR-501M, PR-501L, PR501T, PR-501S-23, PR-200, PR-355M, PR-355L, PR-359M, and PR-359L

\* Asterisk designates the current style.

## Dual Motor Electrical Diagram

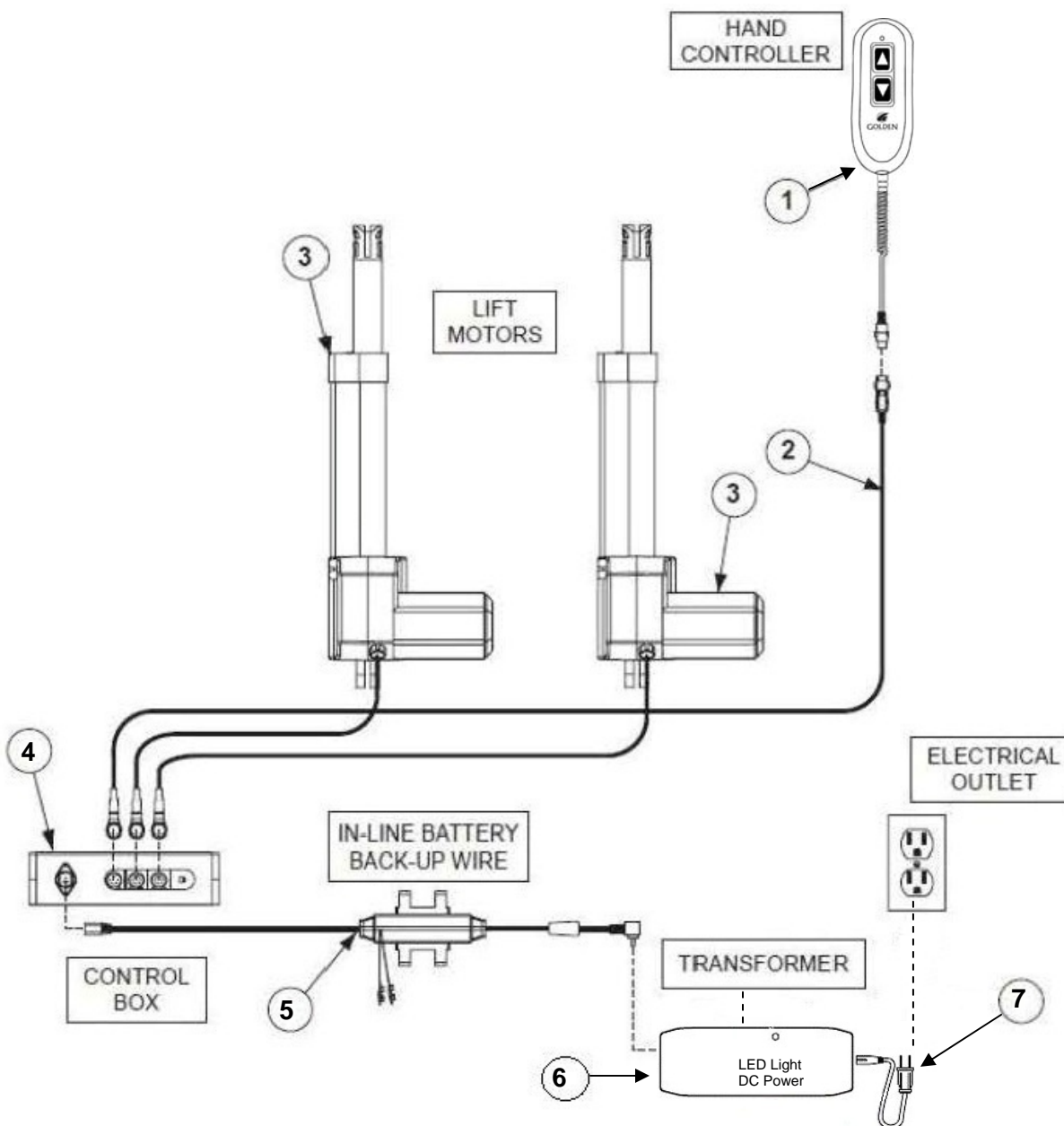

REF #	PART NUMBER	DESCRIPTION	QTY.
1*	ZK1200-HC	Hand Wand, 2 Button LED with Walnut Burl Grain	1
1	ZK-1100-HC	Hand Wand, 2 Button LED with Walnut Burl Grain	1
2*	ZK-20-EXT	Hand Control Extension 62" Long	1
2	ZK-10-EXT	Hand Control Extension 62" Long	1
3	GMOKI-28W	Okin 26-28 Wide Motor	2
4	GMOKI-CB	Motor Chair Okin 26-28 Wide Control Box 4/2003	2
5	GM1502L	Motor Chair Battery Back Up Wire with LED	1
6	GM1501-A	Motor Chair Transformer	1
7	GM1501-APUS	Transformer Cord	1

### Smart Tek System

Model: PR-501M-26D, PR-501L-26D, PR-501T-28D

\* Asterisk designates the current style.

# Triple Motor Electrical Diagram

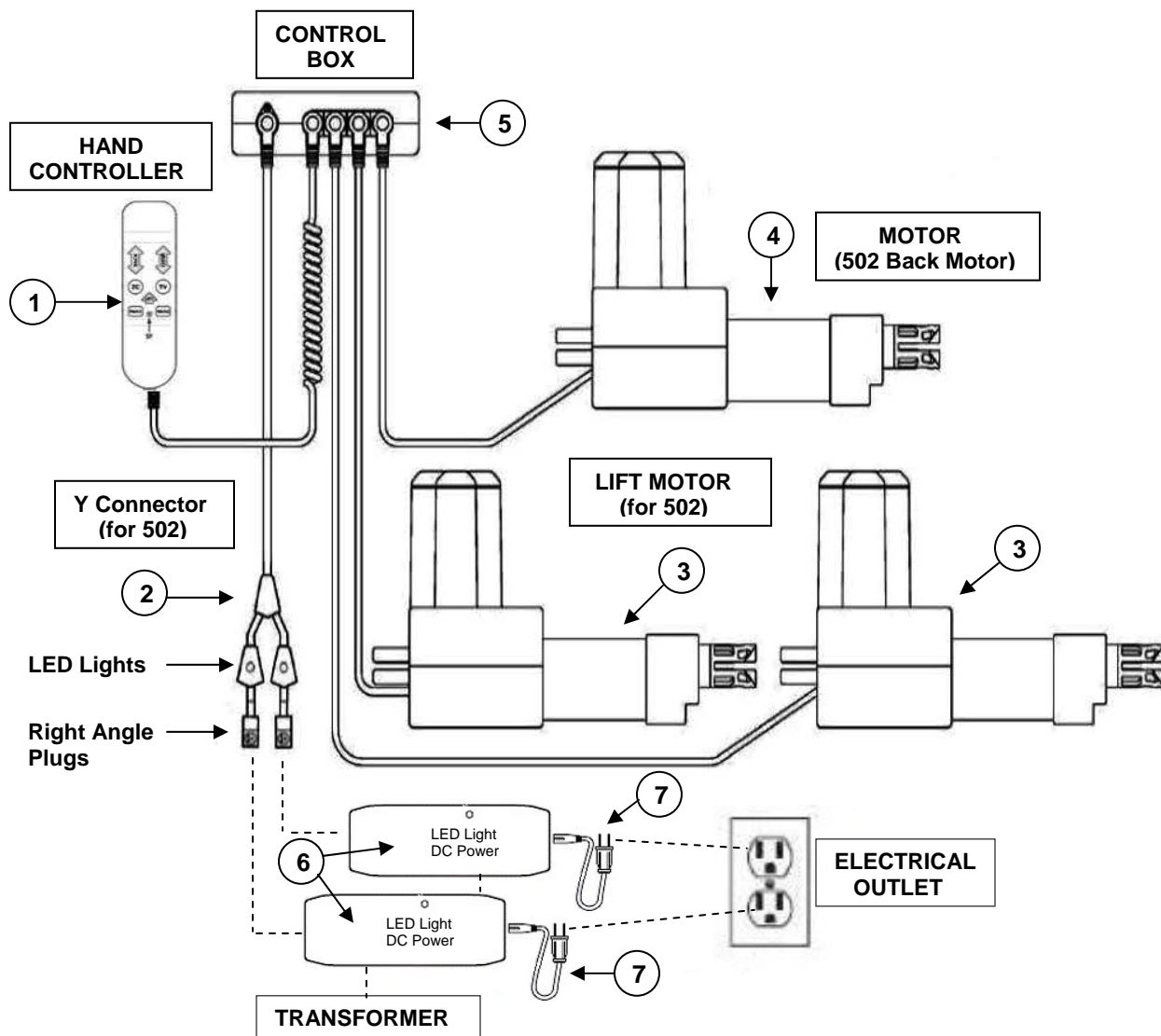

REF #	PART NUMBER	DESCRIPTION	QTY.
1	ZKAD-1	Hand Wand Auto Drive for Lift Chairs	1
2	GM502YL	Y Connector for 502	1
3	GMOKI-28W	Okin 26-28 Wide Motor	2
4	GMOKI1502-OM	Okin Motor, for 502	1
5	GMOKI-CB	Motor Chair Okin 26-28 Wide Control Box 4/2003	1
6	GM1501-A	Motor Chair Transformer	2
7	GM1501-APUS	Transformer Cord	2

**Smart Tek System**  
Model: PR-502

# Heat and Massage Electrical Diagram

HV3000 COMPLETE  
RELAXOR DHV SYSTEM

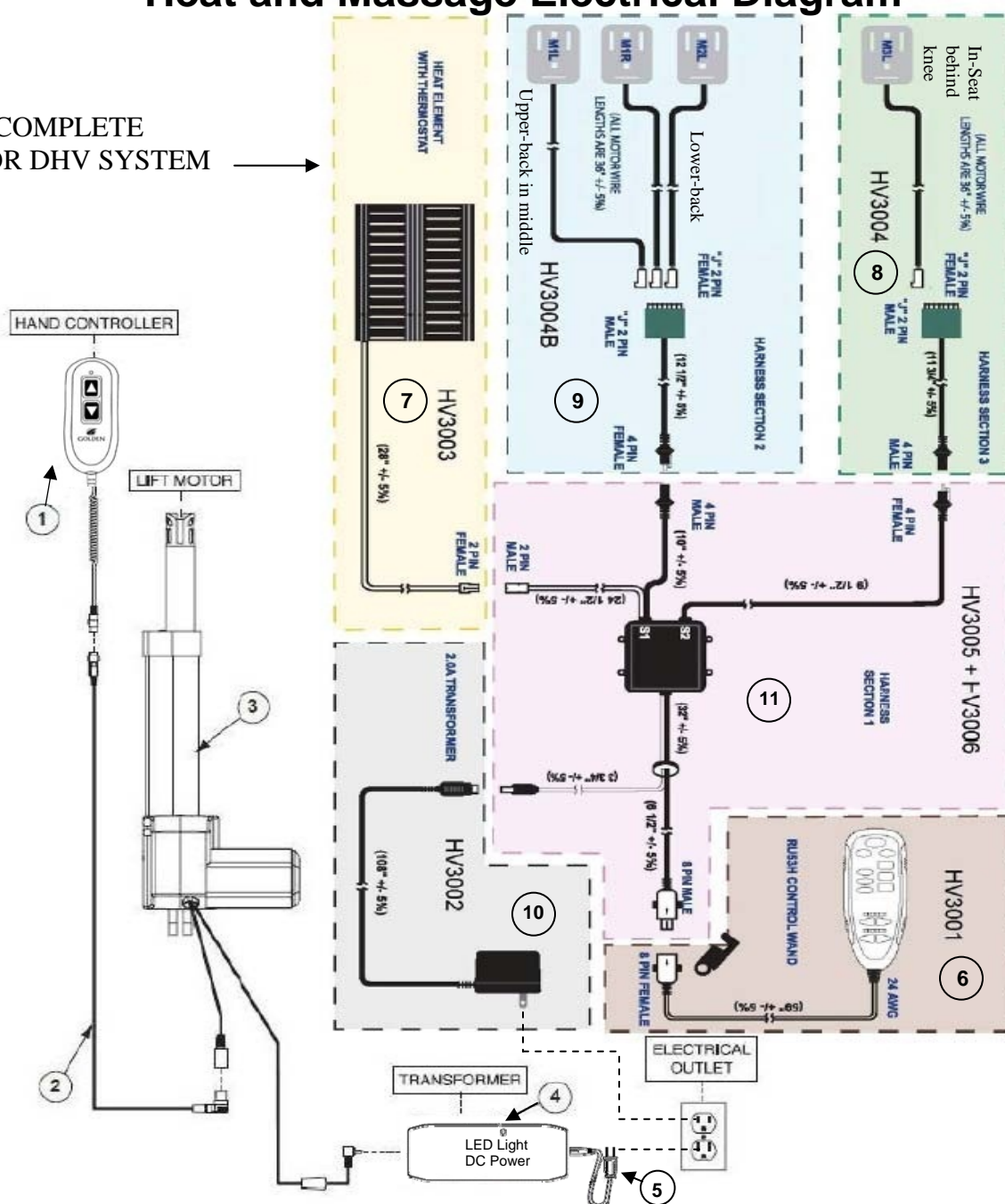

REF #	PART NUMBER	DESCRIPTION	QTY.
1*	ZK-1200	Hand Wand, 2 Button LED with Walnut Burl Grain	1
1	ZK-1100	Hand Wand, 2 Button LED with Walnut Burl Grain	1
2*	ZK-20-EXT	Hand Control Extension 62" Long	1
2	ZK-10-EXT	Hand Control Extension 62" Long	1
3	GM1500-LM	Motor Chair Led Non Transformer	1
4	GM1501-A	Motor Chair Transformer	1
5	GM1501-APUS	Transformer Cord	1
6	HV3001	DHV Hand Control	1
7	HV3003	Heat Unit	1
8	HV3004	Massage Seat	1
9	HV3004B	Massage Back	3
10	HV3002-2	Transformer	1
11	HV3005	DHV Control Box	1

\* Asterisk designates the current style.

Smart Tek System - Models: All except PR200



# MaxiComfort Electrical Diagram

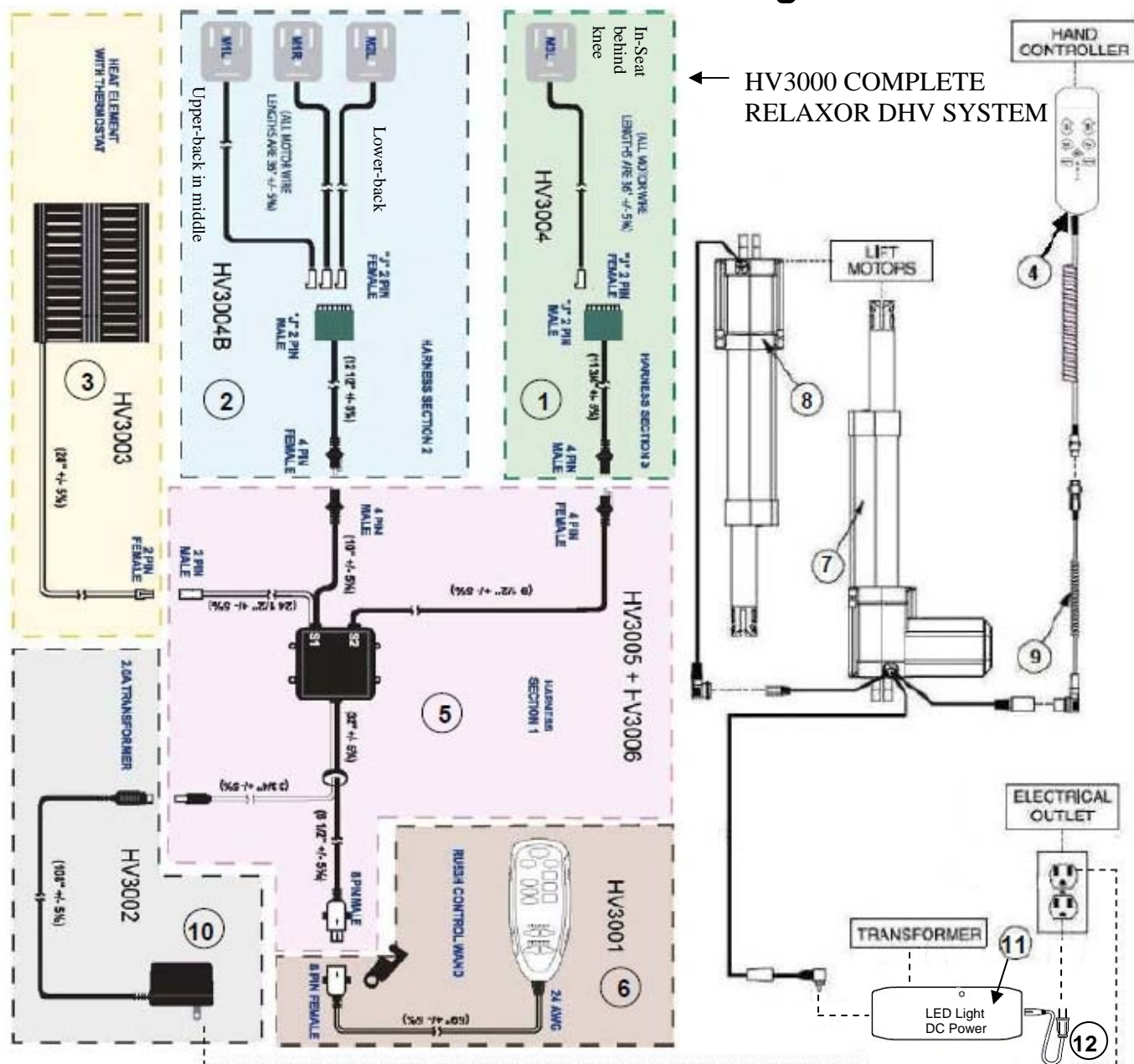

REF #	PART NUMBER	DESCRIPTION	QTY.
1	HV3004	Massage Unit Assembly, Seat	1
2	HV3004B	Massage Unit Assembly, Back	3
3	HV3003	Heat Pad	1
4	ZKAD-1	Hand Wand Auto Drive for Lift Chairs	1
5	HV3005	Control Box	1
6	HV3001	Heat Massage Deluxe Hand Control	1
7	GM1500-LM	Motor Chair Okin Maxi Lift Motor	1
8	GM756R	Motor Chair Okin Maxi Recline Motor	1
9	ZK1100-EXT	Hand Control Extension	1
10	HV3002-2	Box Transformer 3 x 3 1/2 x 10	1
11	GM1501-A	Motor Chair Transformer	1
12	GM1501-APUS	Transformer Cord	1

**Smart Tek System**

Models: PR-756MC, PR-756L, PR-506, PR-505JP, PR-505S, PR-505M, PR-505L, PR-510



## Trouble Shooting with Smart Tek

**Models:** Capri, 355M, 355L, 359M, 359L, 501JP, 501S, 501M, 501L, 501T, 501S23, 510, 505L, 505M, 505S, 505JP, 506, 756L, 756MC, 451, 410, 643, 747, 751TY, 752, 401L, 401, 906

**Problem:**

Chair doesn't work, both LED lights are off.

Chair doesn't work, both LED lights are on.

Chair motor runs in one direction, both lights are on.

Chair doesn't work; LED on hand control is off.

**Solution:**

1. Check right angle plug is connected to the transformer.
  2. Check the plug end of the transformer is plugged into the wall outlet.
  3. Check the fuse or breaker to the wall outlet the chair is plugged into.
- If all above are ok, defective transformer replace it.

1. Defective motor replace it.

1. Defective hand control, replace it.

1. Check the quick release connector is plugged in and locked in the chair pocket.
2. Check the extension from the pocket is connected to the motor. If all above are ok, defective hand control or extension wire, extension wire rarely goes bad, replace hand control.

**Models:** 501M26D, 501L26, 501T28

**Problem:**

Chair doesn't work, both LED lights are off.

Chair doesn't work, both LED lights are on.

Chair motor runs in one direction, both lights are on.

Chair doesn't work; LED on hand control is off.

**Solution:**

1. Check right angle plug is connected to the transformer.
  2. Check the plug end of the transformer is plugged into the wall outlet.
  3. Check the fuse or breaker to the wall outlet the chair is plugged into.
- If all above are ok, defective transformer replace it.

1. Check motors are plugged into the control box. If all above are ok, defective control box or motors, both motors rarely go bad, replace the control box.

1. Defective hand control, replace it.

1. Check the quick release connector is plugged in and locked in the chair pocket.
2. Check the extension from the pocket is connected to the control box. If all above are ok, defective hand control or extension wire or control box, extension wire rarely goes bad, replace control box and hand control, replace hand control first, if problem is resolved send control box back.

**Model:** 502

**Problem:**

Chair doesn't work, both LED lights are off.

Chair doesn't work, both LED lights are on.

Chair motor(s) run in one direction, both lights are on.

Chair doesn't work; LED on hand control is off.

Chair works but slowly, hand control light is on and one of the Y connector lights is off.

**Solution:**

1. Check right angle plug is connected to the transformer.
  2. Check the plug end of the transformer is plugged into the wall outlet.
  3. Check the fuse or breaker to the wall outlet the chair is plugged into.
- If all above are ok, defective transformers replace both.

1. Check motors are plugged into the control box. If all above are ok, defective control box or motors, both motors rarely go bad, replace control box.

1. Defective hand control, replace it.

1. Check the quick release connector is plugged in and locked in the chair pocket.
2. Check the extension from the pocket is connected to the control box. If all above are ok, defective hand control or extension wire or control box, extension wire rarely goes bad, replace control box and hand control, replace hand control first, if problem is resolved send control box back.

1. Check right angle plug is connected to the transformer.
2. Check plug end of the transformer is plugged into the wall outlet.
3. Check power to the socket on the wall outlet the chair is plugged into. If all above are ok, defective transformer replace it.

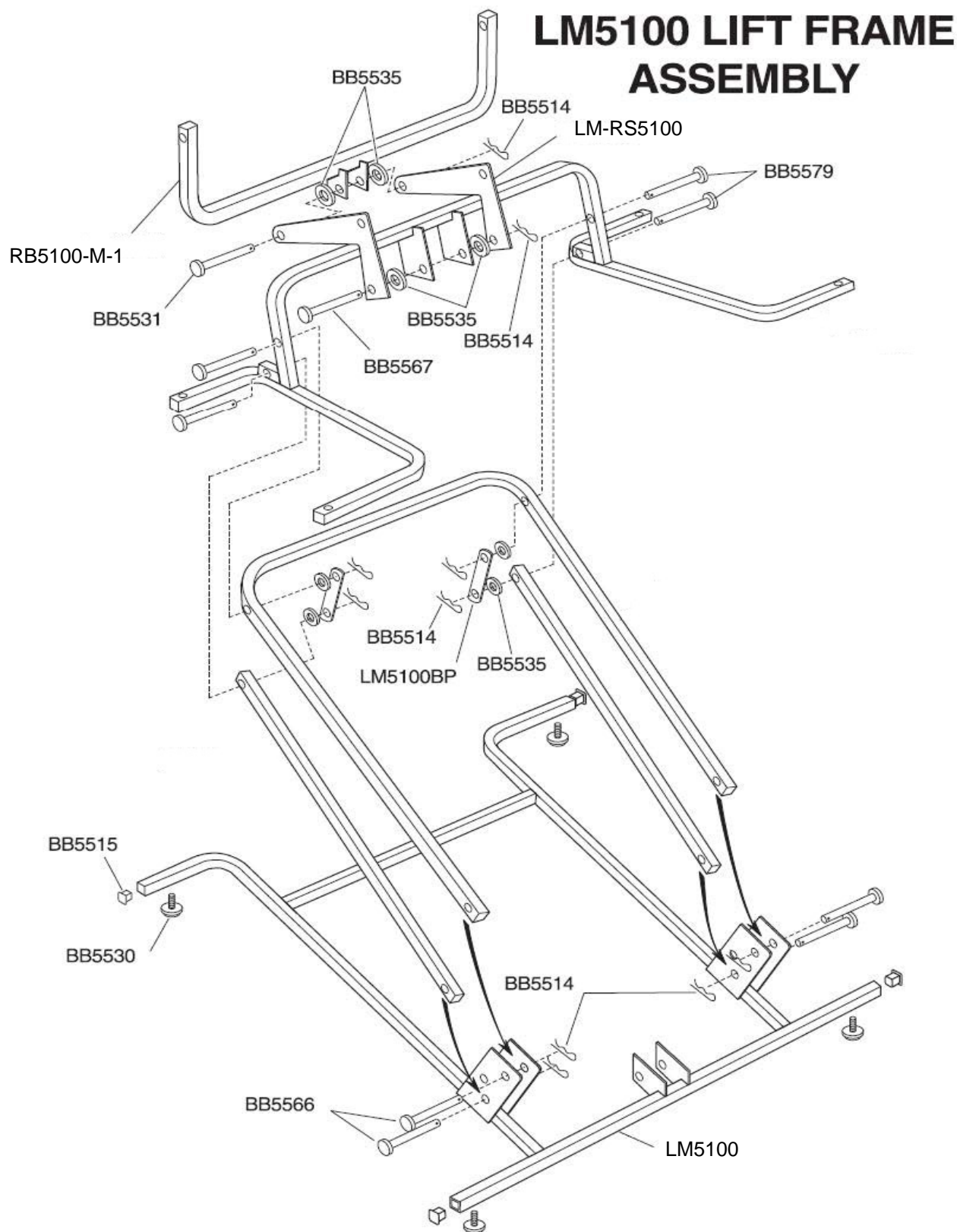

For use in models: PR-401, PR-747, PR-643, PR-752, PR-451, PR756MC, PR-506, PR-505JP, PR-505S, PR-505M, PR-510, PR-501JP, PR-501S, PR-501M, PR-355M, PR359M  
 See parts list for specific parts by model.

# LM5100 LIFT MOTOR

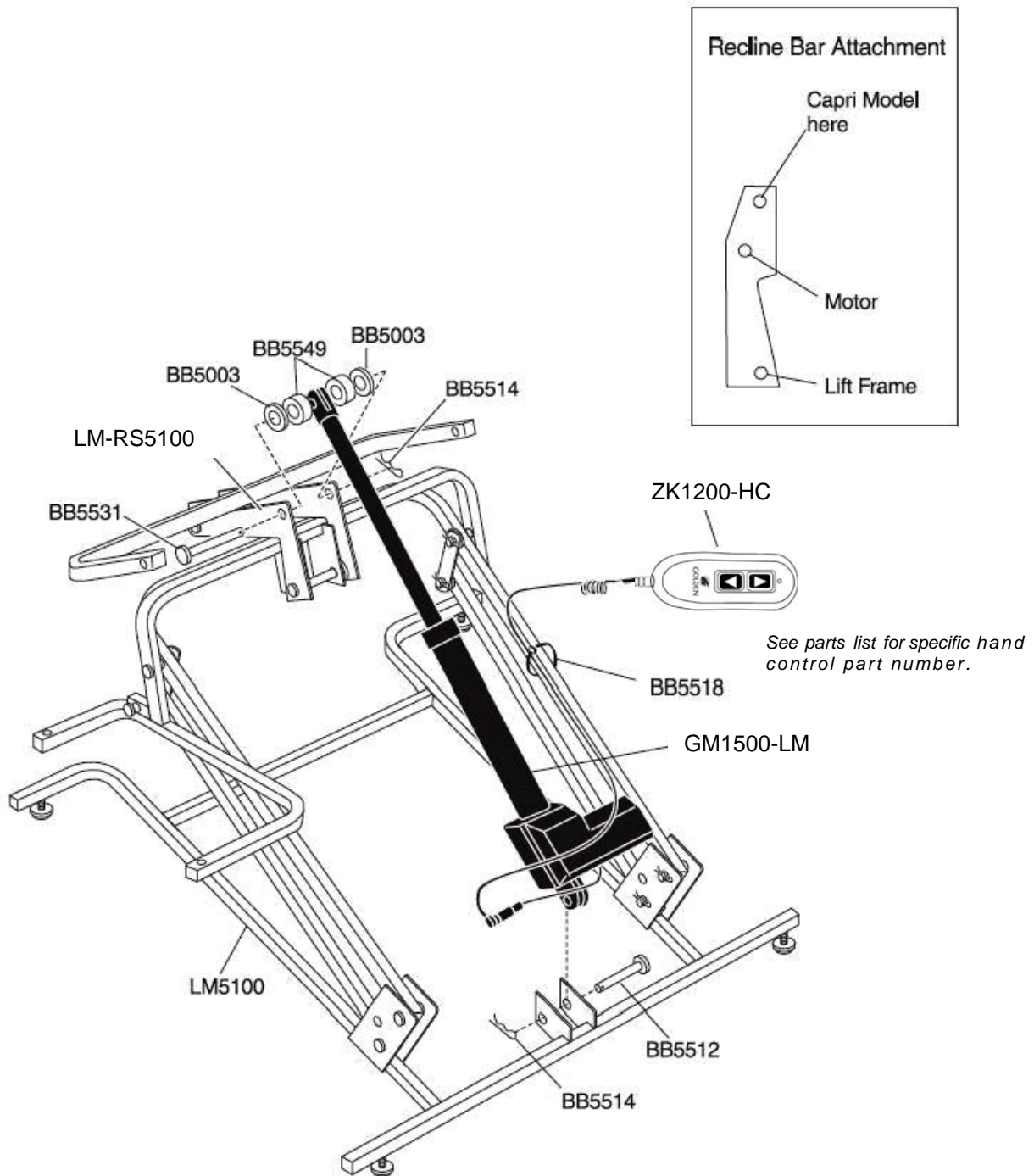

## LM5100 LIFT FRAME PARTS LIST

Part Number	Description	Qty. Per Unit
BB5003	Washer, 380 x 750 x 062 Nylon	2
BB5512	Pin, 3/8 x 1 5/8 Zinc Clevis	1
BB5514	Pin, Hitch	11
BB5515	Cap, 1" Square End Chair	8
BB5518	Tywrap, 8" Black	2
BB5530	Leg Leveler 5/16 X 1	4
BB5531	Pin, 3/8 x 2 1/2 Zinc Clevis	1
BB5535	Washer, 750 x 394 x 125 Nylon	6
BB5549	Washer, 400 x 750 x 312 Nylon	2
BB5566	Pin, 3/8 X 1 3/4 Zinc Clevis	4
BB5567	Pin, 3/8 X 2 5/8 Zinc Clevis	1
BB5579	Pin, 3/8 X 2 7/8 Zinc Clevis	4
GM1500-LM	DC INLINE MOTOR	1
LM5100	5100 LIFT FRAME	1
LM-RS5100	RECLINE STRAP 5100 / 6111 SERIES LIFT FRAME	2
ZK1200-HC	Hand Wand, 2 Button LED with Walnut Burl Grain	1
ZKAD-1	Hand Wand Auto Drive for Lift Chairs	1

Note: Refer to "Models Quick Reference" chart for correct hand control by model.

## RECLINE BARS FOR 5100 LIFT FRAME

RB5100-M-1	RECLINE BAR MEDIUM / SMALL	1
------------	----------------------------	---

## RECLINE MECHANISMS FOR 5100 LIFT FRAME

RM621L	3 WAY MECHANISM LEFT SIDE	1
RM621R	3 WAY MECHANISM RIGHT SIDE	1
RM8300L	2 WAY MECHANISM LEFT SIDE	1
RM8300R	2 WAY MECHANISM RIGHT SIDE	1

LEFT AND RIGHT IS DETERMINED BY SITTING IN CHAIR

## TRANSFORMER FOR 5100 LIFT FRAME

GM1501-A	Motor Chair Transformer	1
GM1501-APUS	Transformer Cord	1

CALL TECHNICAL SERVICE FOR FABRIC, FOAM, SPRING AND WOOD PART NUMBERS AND PRICING

## LM5120 LIFT FRAME

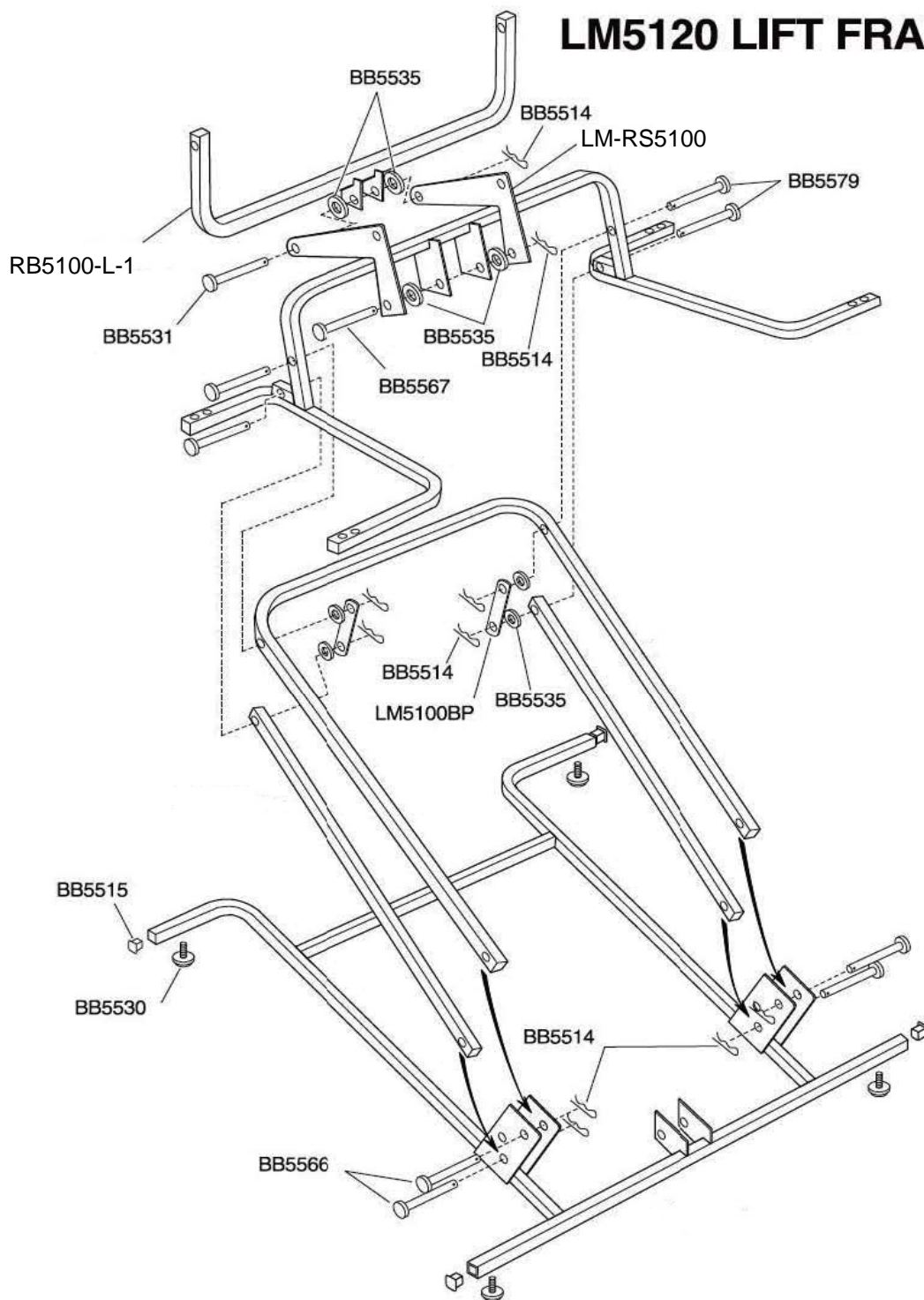

For use in models: PR-401L, PR-410, PR-751TY, PR-756L, PR-505L, PR-501L, PR-501T, PR-501S-23, PR-355L, PR-359L

See parts list for specific parts by model.

# LM5120 LIFT MOTOR ASSEMBLY

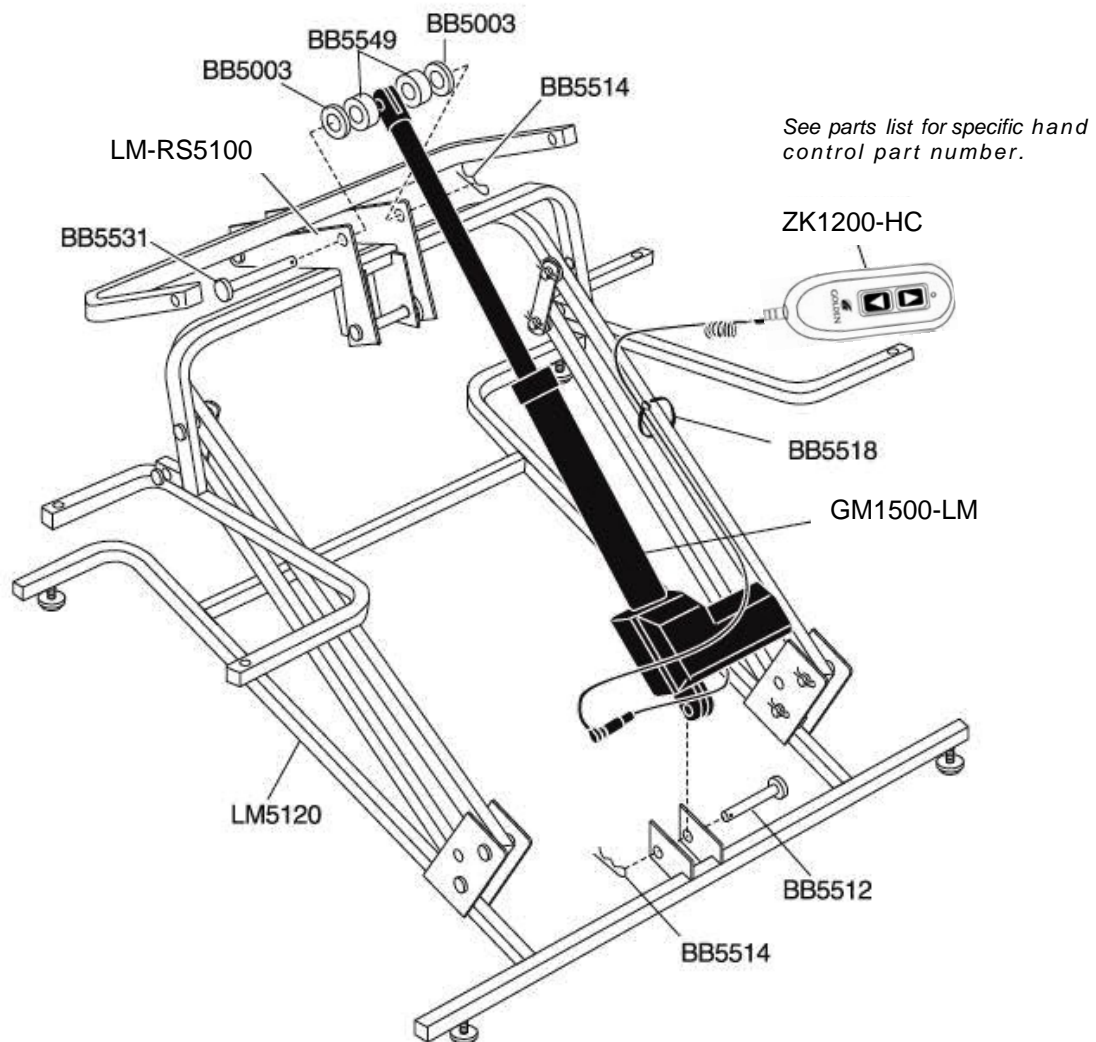

## LM5120 LIFT FRAME PARTS LIST

Part Number	Description	Qty. Per Unit
BB5003	Washer, 380 x 750 x 062 Nylon	2
BB5512	Pin, 3/8 x 1 5/8 Zinc Clevis	1
BB5514	Pin, Hitch	11
BB5515	Cap, 1" Square End Chair	8
BB5518	Tywrap, 8" Black	2
BB5530	Leg Leveler 5/16 X 1	4
BB5531	Pin, 3/8 x 2 1/2 Zinc Clevis	1
BB5535	Washer, 750 x 394 x 125 Nylon	6
BB5549	Washer, 400 x 750 x 312 Nylon	2
BB5566	Pin, 3/8 X 1 3/4 Zinc Clevis	4
BB5567	Pin, 3/8 X 2 5/8 Zinc Clevis	1
BB5579	Pin, 3/8 X 2 7/8 Zinc Clevis	4
GM1500-LM	DC INLINE MOTOR	1
LM5120	5120 LIFT FRAME	1
LM-RS5100	RECLINE STRAP 5100 / 6111 SERIES LIFT FRAME	2
ZKAD-1	Hand Wand Auto Drive for Lift Chairs	1
ZK1200-HC	Hand Wand, 2 Button LED with Walnut Burl Grain	1

Note: Refer to "Models Quick Reference" chart for correct hand control by model.

## RECLINE BARS FOR 5120 LIFT FRAME

RB5100-M-1	RECLINE BAR MEDIUM / SMALL	1
RB5100-L-1	RECLINE BAR LARGE / 754	1

## RECLINE MECHANISMS FOR 5120 LIFT FRAME

RM621L	3 WAY MECHANISM LEFT SIDE	1
RM621R	3 WAY MECHANISM RIGHT SIDE	1

LEFT AND RIGHT IS DETERMINED BY SITTING IN CHAIR

## TRANSFORMER FOR 5120 LIFT FRAME

GM1501-A	Motor Chair Transformer	1
GM1501-APUS	Transformer Cord	1

CALL TECHNICAL SERVICE FOR FABRIC, FOAM, SPRING AND WOOD PART NUMBERS AND PRICING



# LM6111 LIFT FRAME

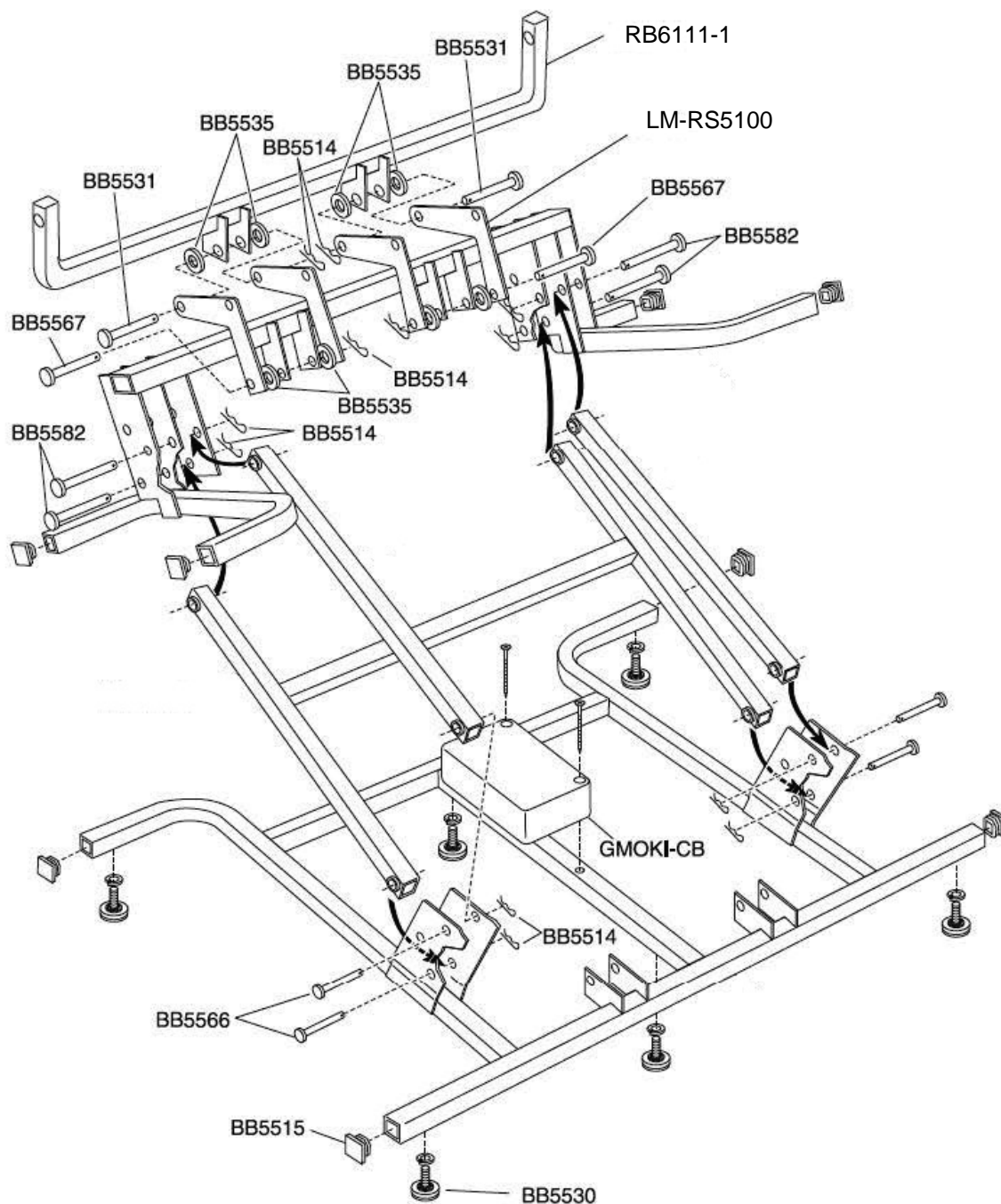

For use in models: PR-501M26D, PR-501L26, PR-501T28  
 See parts list for specific parts by model.

# LM6111 LIFT MOTOR

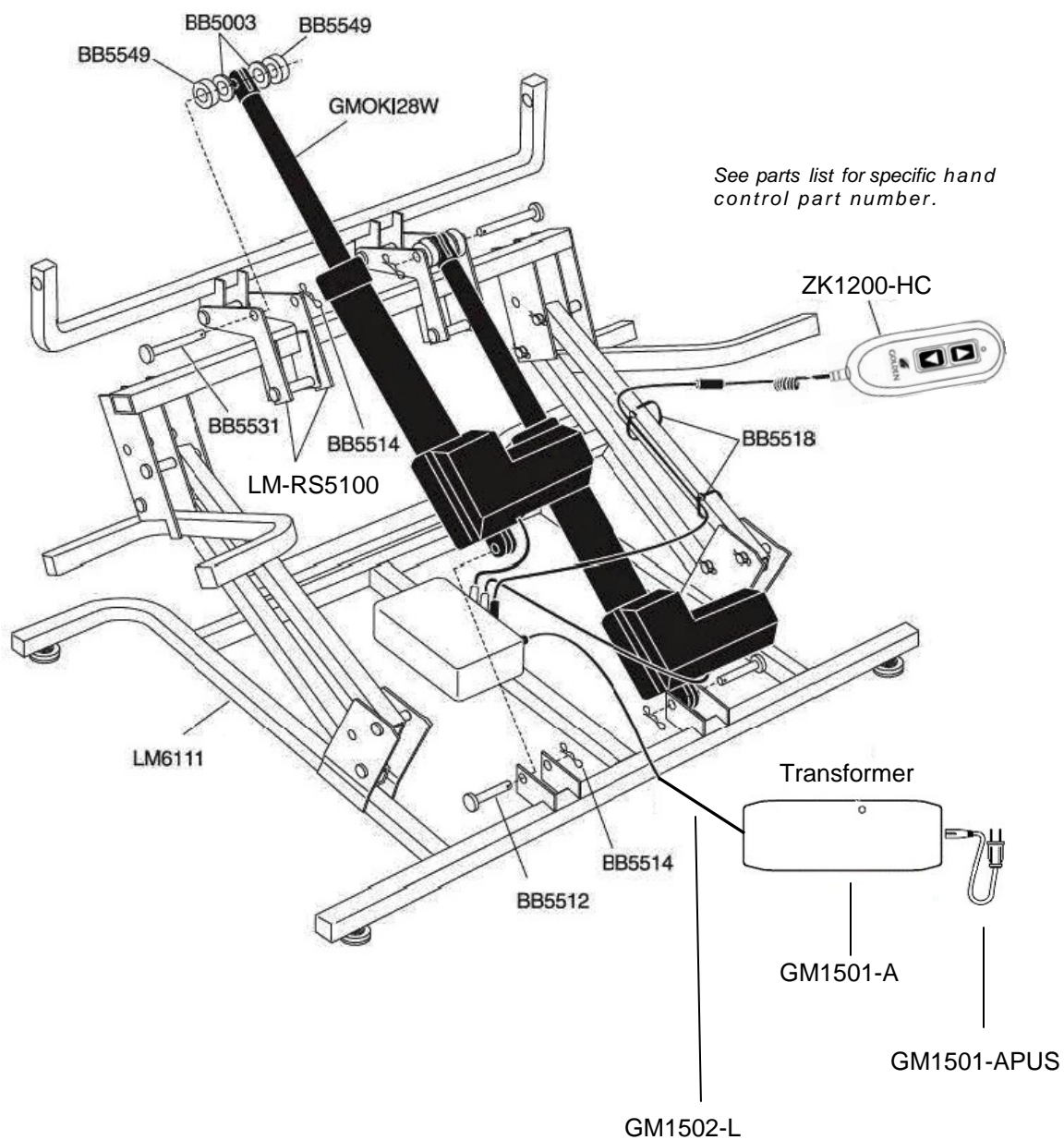

## LM6111 LIFT FRAME PARTS LIST

Part Number	Description	Qty. Per Unit
BB5003	Washer, 380 x 750 x 062 Nylon	4
BB5512	Pin, 3/8 x 1 5/8 Zinc Clevis	2
BB5514	Pin, Hitch	13
BB5515	Cap, 1" Square End Chair	8
BB5518	Tywrap, 8" Black	2
BB5530	Leg Leveler 5/16 X 1	6
BB5531	Pin, 3/8 x 2 1/2 Zinc Clevis	2
BB5535	Washer, 750 x 394 x 125 Nylon	4
BB5549	Washer, 400 x 750 x 312 Nylon	4
BB5566	Pin, 3/8 X 1 3/4 Zinc Clevis	4
BB5567	Pin, 3/8 X 2 5/8 Zinc Clevis	2
BB5582	Pin, 3/8 X 3 Zinc Clevis	4
GMOKI-28W	Motor Chair Okin 26-28 Wide Motor	2
GMOKI-CB	Motor Chair Okin 26-28Wide Control Box 4/2003	1
GM1502L	LOW VOLTAGE POWER CORD (Extension wire low voltage )	1
LM6111	Dual Motor Lift Frame	1
LM-RS5100	RECLINE STRAP 5100 / 6111 SERIES LIFT FRAME	2
ZK1200-HC	Hand Wand, 2 Button LED with Walnut Burl Grain	1

Note: Refer to "Models Quick Reference" chart for correct hand control by model.

## RECLINE BARS FOR 6111 LIFT FRAME

RB6111	DUAL MOTOR RECLINE BAR	1
--------	------------------------	---

## RECLINE MECHANISMS FOR 6111 LIFT FRAME

RM621L	3 WAY MECHANISM LEFT SIDE HEAVY DUTY	1
RM621R	3 WAY MECHANISM RIGHT SIDE HEAVY DUTY	1

LEFT AND RIGHT IS DETERMINED BY SITTING IN CHAIR

## TRANSFORMER FOR 6111 LIFT FRAME

GM1501-A	Motor Chair Transformer	1
GM1501-APUS	Transformer Cord	1

CALL TECHNICAL SERVICE FOR FABRIC, FOAM, SPRING AND WOOD PART NUMBERS AND PRICING

# LM5000C LIFT FRAME ASSEMBLY

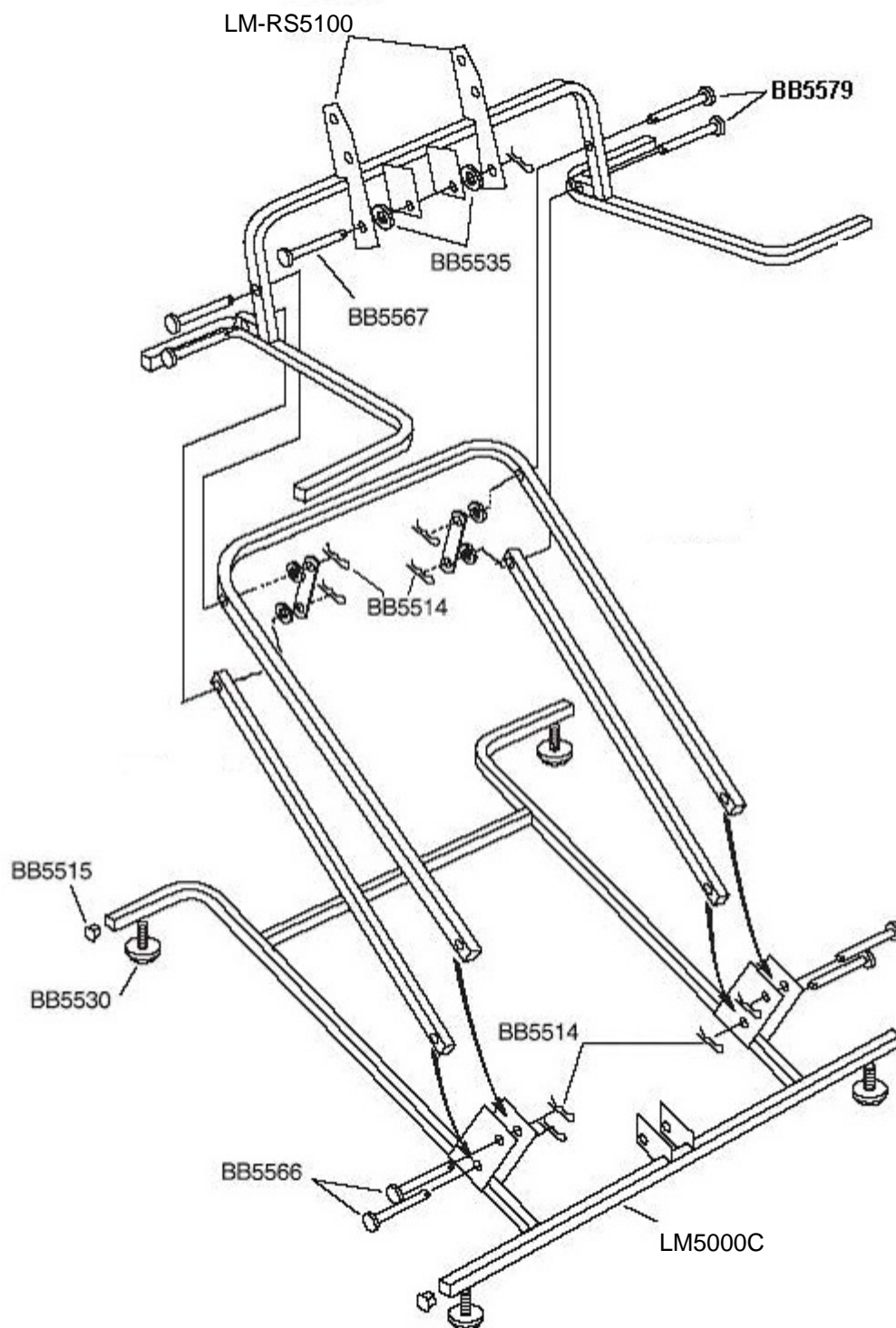

For use in model: PR-200

*See parts list for specific parts by model.*

# LM5000C LIFT MOTOR

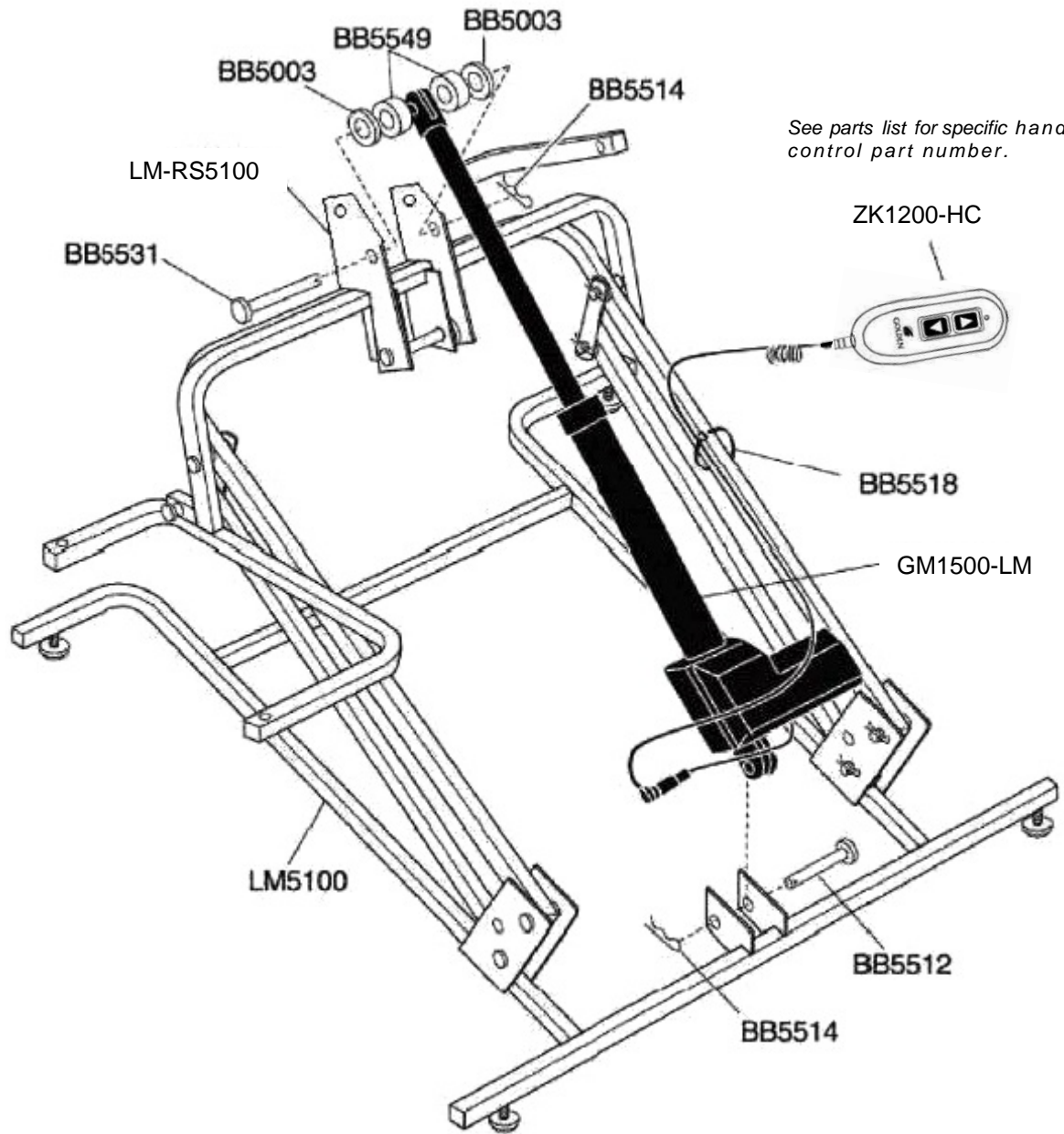

## LM5000C LIFT FRAME PARTS LIST

Part Number	Description	Qty. Per Unit
BB5003	Washer, 380 x 750 x 062 Nylon	2
BB5512	Pin, 3/8 x 1 5/8 Zinc Clevis	1
BB5514	Pin, Hitch	11
BB5515	Cap, 1" Square End Chair	8
BB5518	Tywrap, 8" Black	2
BB5530	Leg Leveler 5/16 X 1	4
BB5531	Pin, 3/8 x 2 1/2 Zinc Clevis	1
BB5535	Washer, 750 x 394 x 125 Nylon	6
BB5549	Washer, 400 x 750 x 312 Nylon	2
BB5566	Pin, 3/8 x 3 1/2 Zinc Clevis	4
BB5567	Pin, 3/8 x 2 5/8 Zinc Clevis	1
BB5579	Pin, 3/8 x 2 7/8 Zinc Clevis	4
GM1500-LM	DC INLINE MOTOR	1
LM5000C	5000C LIFT FRAME	1
LM-RS5100	RECLINE STRAP 5100 / 6111 SERIES LIFT FRAME	2
ZK1200-HC	Hand Wand, 2 Button LED with Walnut Burl Grain	1

Note: Refer to "Models Quick Reference" chart for correct hand control by model.

## RECLINE BAR FOR 5000C LIFT FRAME

RB4000-CB	RECLINE BAR CAPRI	1
-----------	-------------------	---

## RECLINE MECHANISMS FOR 5100 LIFT FRAME

RM8300L	2 WAY MECHANISM LEFT SIDE	1
RM8300R	2 WAY MECHANISM RIGHT SIDE	1

LEFT AND RIGHT IS DETERMINED BY SITTING IN CHAIR

## TRANSFORMER FOR 5100 LIFT FRAME

GM1501-A	Motor Chair Transformer	1
GM1501-APUS	Transformer Cord	1

CALL TECHNICAL SERVICE FOR FABRIC, FOAM, SPRING AND WOOD PART NUMBERS AND PRICING



# LM502 LIFT FRAME

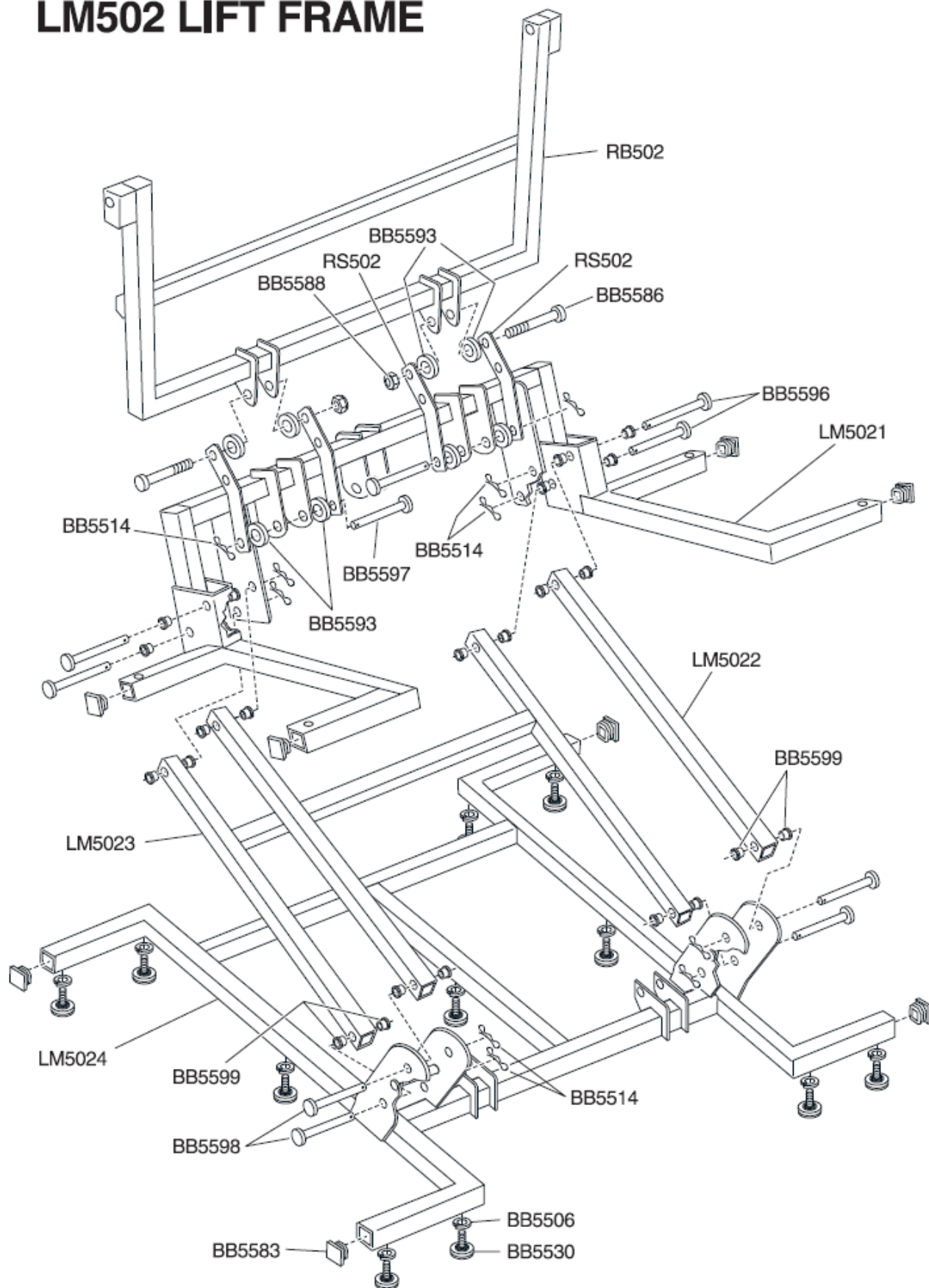

For use in model: PR-502



# LM502 LIFT MOTOR

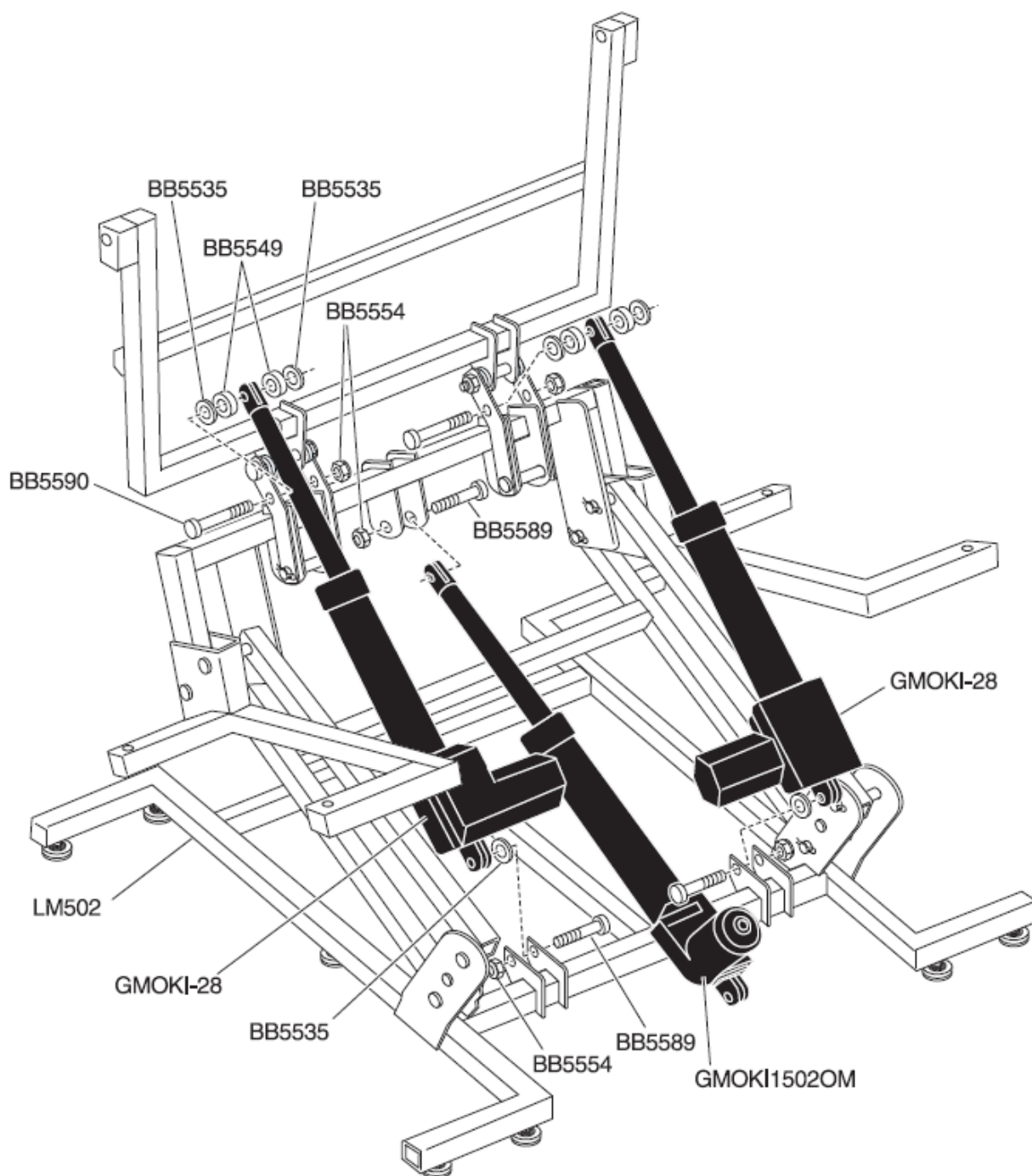

## LM502 ELECTRICAL CONNECTION

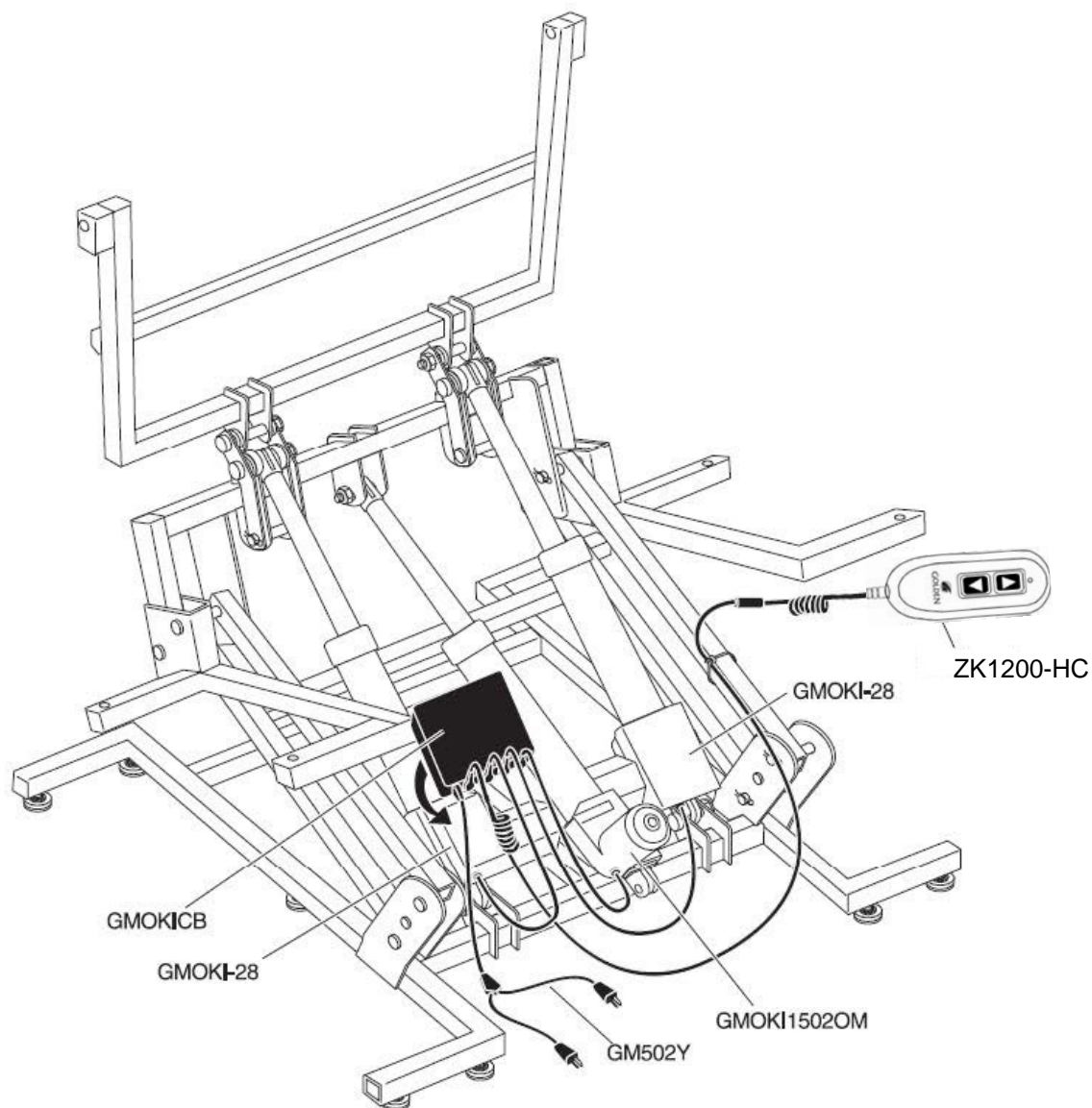

# RM502 RECLINE MECHANISM

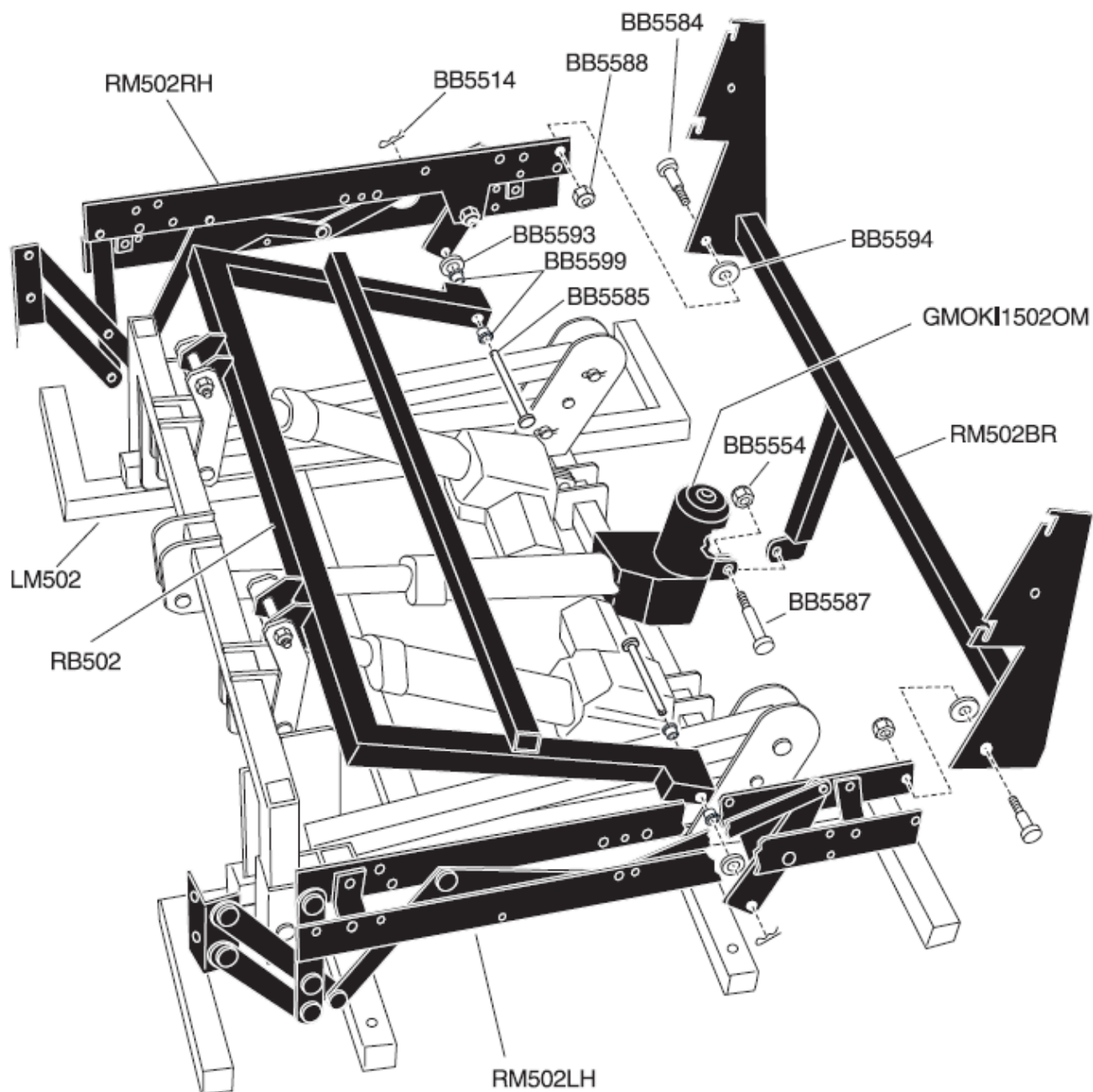

## LM502 LIFT FRAME PARTS LIST

Part Number	Description	Qty. Per Unit
BB5506	1/4" LOCK WASHER	17
BB5514	HAIR PIN	12
BB5530	5/16 X 1 LEG LEVELER	13
BB5535	1/8 NYLON PLASTIC WASHER	6
BB5548	5/16" X 3" TAP BOLT GRADE 5 ( to attach lift frame to chair )	4
BB5549	3/8 NYLON PLASTIC WASHER	4
BB5554	5/16" NYLON LOCK NUT	6
BB5583	1 1/4" X 1 1/4" END CAP	12
BB5584	1/2" X 1/2" SHOULDER BOLT	2
BB5585	1/2" X 3 1/4" CLEVIS PIN	2
BB5586	1/2" X 2 1/2" SHOULDER BOLT	2
BB5587	3/8" X 1 1/4" SHOULDER BOLT	1
BB5588	3/8"-16 NYLON LOCK NUT	4
BB5589	3/8" X 1 3/4" SHOULDER BOLT	3
BB5590	3/8" X 2 1/2" SHOULDER BOLT	2
BB5591	5/16" X 1 1/2" HEX CAP SCREW ( to attach back to mechanism )	2
BB5592	5/16" X 2" HEX CAP SCREW 9 to ( to attach back to mechanism )	4
BB5593	NYLON WASHER .750 X .502 X .1875	8
BB5594	NYLON WASHER 1.25 X .502 X .0625	2
BB5596	1/2" X 4" CLEVIS PIN	4
BB5597	1/2" X 2 1/2" CLEVIS PIN	2
BB5598	1/2" X 2 1/4" CLEVIS PIN	4
BB5599	5/8" X 1/2" X 1/2" BUSHING	28
BB5599KIT	BUSHING KIT FOR 502	1
GMOKI-28	26-28 WIDE MOTOR	2
GMOKICB	26-28 WIDE CONTROL BOX	1
GMOKI1502OM	SINGLE MOTOR 502	1
GM502Y	Y CONNECTOR	1
LIFT-502	COMPLETE 502 LIFT FRAME ASSEMBLY (Recline bar not included)	1
LM502	502 LIFT FRAME	1
LM5021	TOP PIECE 502 LIFT FRAME	1
LM5022	STRAIGHT BAR 502 LIFT FRAME	1
LM5023	H-BAR 502 LIFT FRAME	1
LM5024	BASE PIECE 502 LIFT FRAME	1
RS502	RECLINE STRAP 502 LIFT FRAME	4
ZKAD-1	Hand Wand Auto Drive for Lift Chairs	1

## RECLINE BAR FOR 502 LIFT FRAME

RB502	RECLINE BAR FOR 502 CHAIR	1
-------	---------------------------	---

## RECLINE MECHANISM FOR 502 LIFT FRAME

RM502BR	BACK RECLINE MECHANISM 502	1
RM502LH	RECLINE MECHANISM LEFT SIDE 502	1
RM502RH	RECLINE MECHANISM RIGHT SIDE 502	1

LEFT AND RIGHT IS DETERMINED BY SITTING IN CHAIR

## TRANSFORMER FOR 502 SERIES LIFT FRAME

GM1501-A	Motor Chair Transformer	2
GM1501-APUS	Transformer Cord	2

CALL TECHNICAL SERVICE FOR FABRIC, FOAM, SPRING AND WOOD PART NUMBERS AND PRICING

## 906 LIFT FRAME

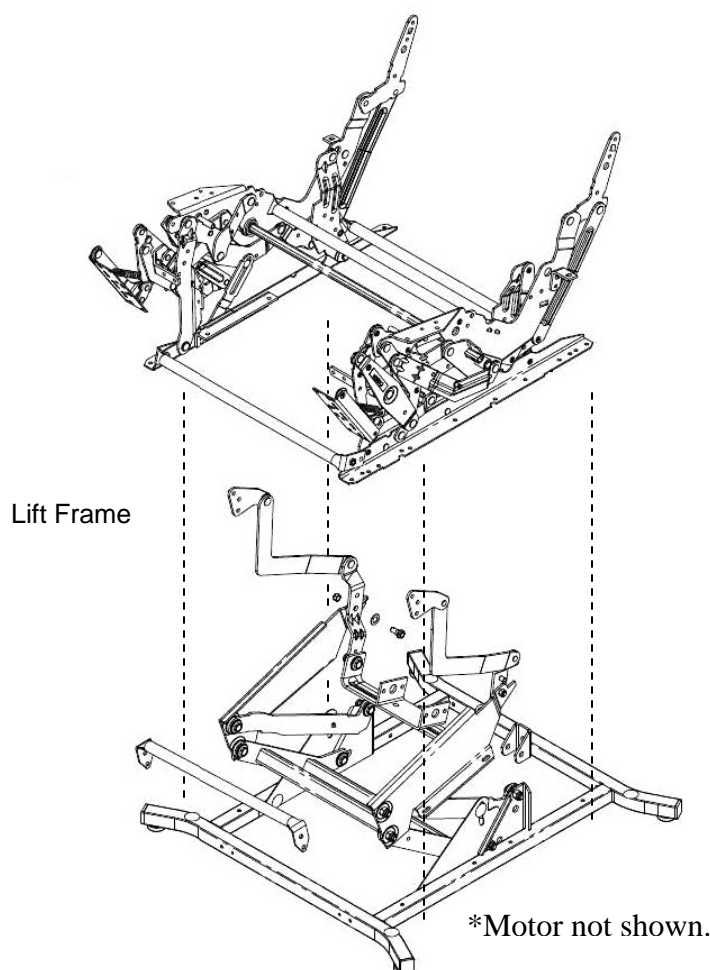

Note: The lift frame pictured is only sold as a complete assembly. For repair purposes, the entire assembly shown must be replaced if defective.

### Lift Frame Replacement (PR-906 only)

1.  **WARNING Unplug the transformer from the wall outlet.**
2. Gently push the chair over onto the footrest.
3. Lift material on the bottom of the chair back away from the Velcro strip.
4. Disconnect the red and green vibrator connectors.
5. Unlatch both back hinges and lift the back up and off the chair.
6. Unplug the motor, hand control extension, and battery backup from the control box.
7. Remove the four (4)  $\frac{1}{4}$ -20 x 2  $\frac{1}{2}$ " bolts; two (2) per side that hold the lift frame to the arm assembly and retain for reassembly.
8. Lift the lift frame out of the chair shell.
9. Remove the four (4) bolts that fasten the footrest to the lift frame and retain for reassembly.
10. Place the new lift frame into the chair shell.
11. Reinstall the four (4)  $\frac{1}{4}$ -20 x 2  $\frac{1}{2}$ " bolts; two (2) per side to secure the lift frame.
12. Reinstall the four (4) bolts; two (2) per side to reattach the foot rest.
13. Reconnect the motor, hand control extension, and battery backup to the control box.
14. Align both back hinges, connect the red and green vibrator connectors, and push the back down until it locks into place.
15. Reposition the material on the bottom of the chair back and connect to Velcro strip.
16. Turn the chair over onto the lift frame.
17. Plug the transformer into the wall outlet and test.



## 906 LIFT MOTOR

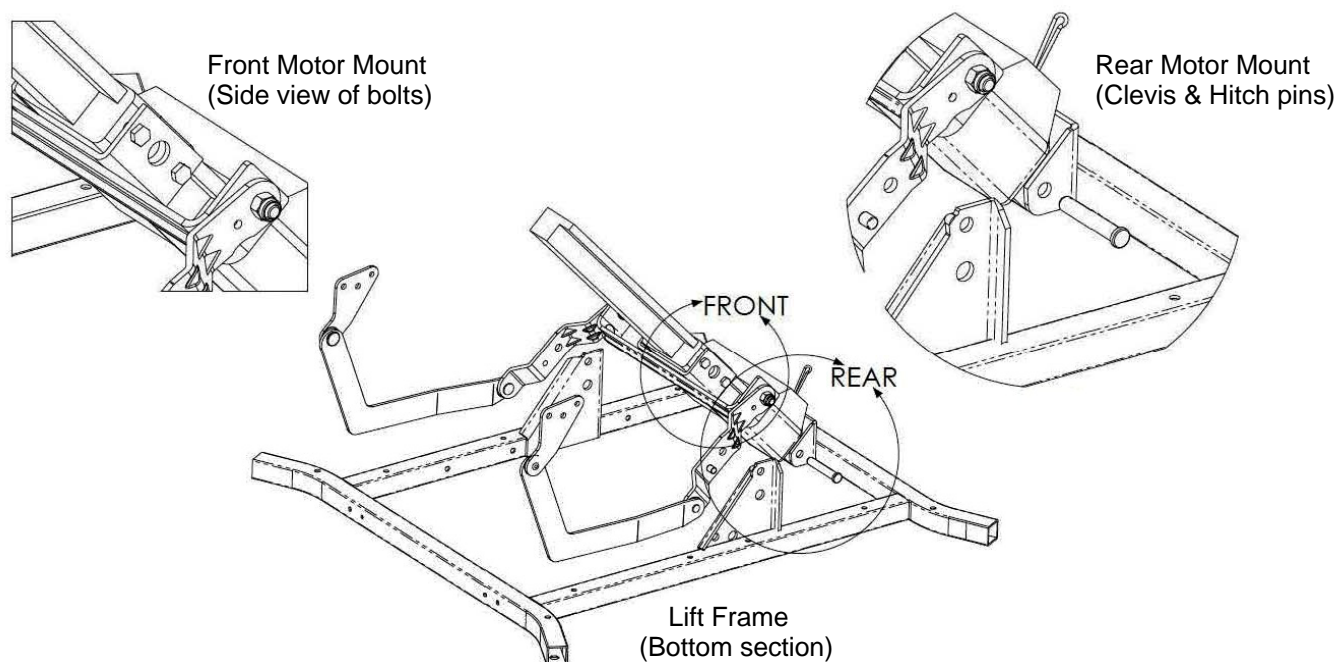

### Lift Motor Replacement (PR-906 only)

1.  **WARNING** **Unplug the transformer from the wall outlet.**
2. Gently push the chair over onto the footrest.
3. Unplug the motor from the hand control extension and the transformer.
4. Remove the four (4) bolts; two (2) per side from the front motor mount and retain hardware for reassembly.
5. Remove the hitch pin and the clevis pin from the rear motor mount that fastens the bottom of the motor to the lift frame. Retain hitch pin and clevis pin for reassembly.
6. Remove the motor from the lift frame.
7. Align the new motor into place and use the hitch pin and clevis pin to fasten the bottom of the new motor to the lift frame.
8. Use the four (4) bolts and hardware retained in step 4 to fasten the top of the lift motor to the lift frame.
9. Connect the new motor to the hand control extension and the transformer.
10. Turn the chair over onto the lift frame.
11. Plug the transformer into the wall outlet and test.



# MAXICOMFORT RECLINE MECHANISM

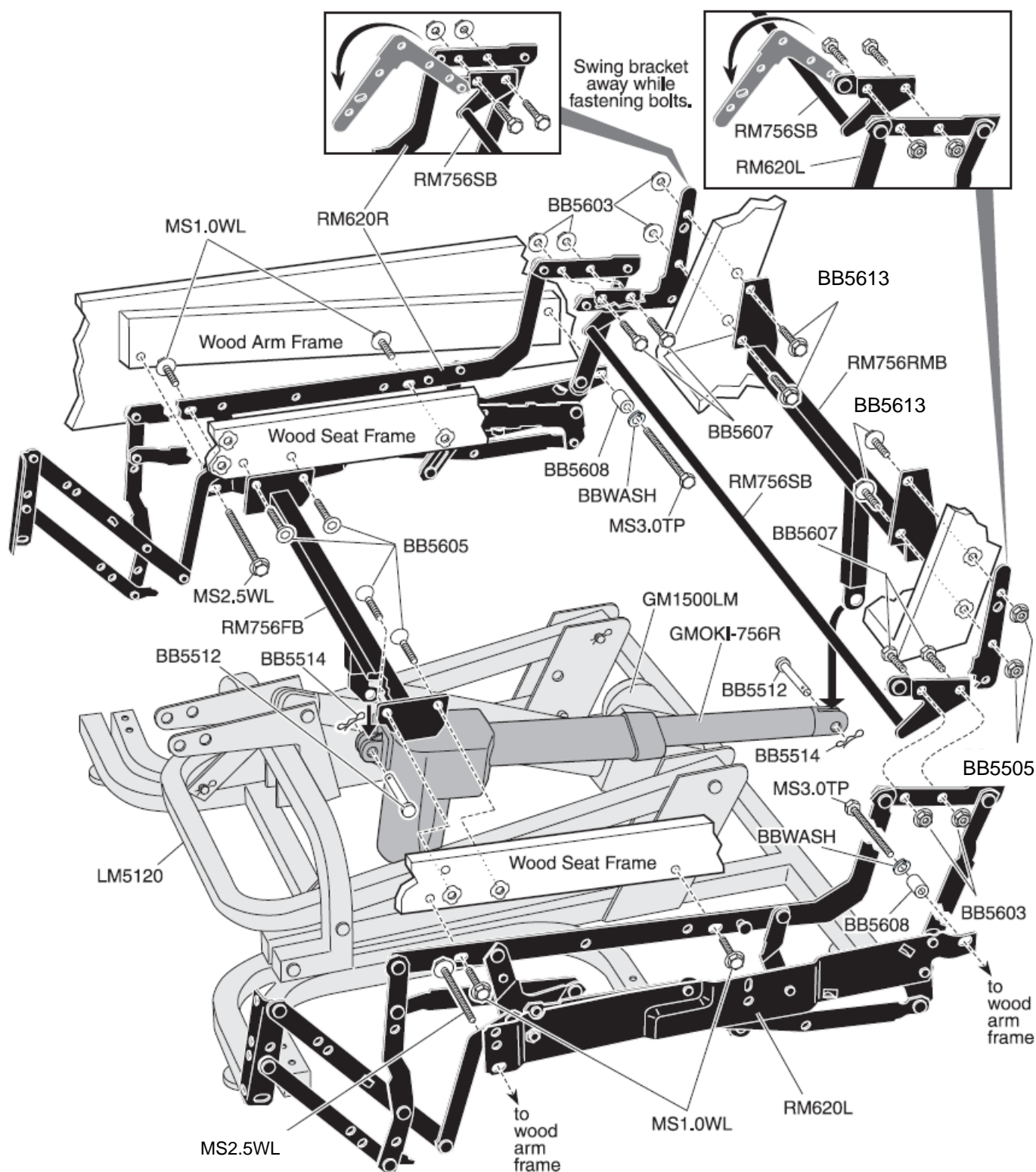

For use in models: PR-756MC, PR-756L, PR-506, PR-505JP, PR-505S, PR-505M, PR-505L, PR-510

See parts list for specific parts by model.

## Power Connections

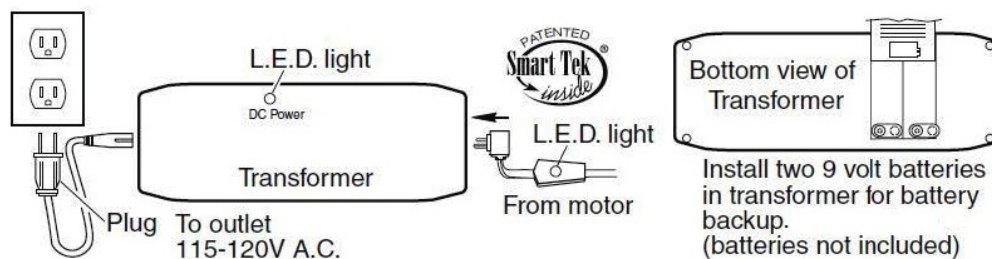

**Models:** PR-200, PR-355M, PR-355L, PR-359M, PR-359L, PR-401, PR-401L, PR-410, PR-451, PR501JP, PR-501S, PR-501S-23, PR-501M, P5-501L, PR-501T, PR-643, PR-747, PR-751TY, PR-752, PR-906, PR-756MC, PR-756L, PR-505JP, PR-505S, PR-505M, PR-505L, PR-506, PR-510, PR502

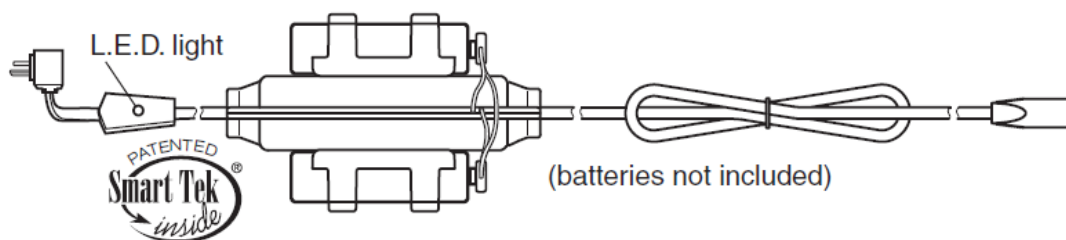

**Models:** PR-501M-26D, PR-501L-26D, PR-501T-28D

### Back Installation:

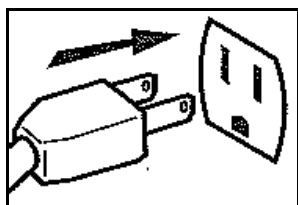

Step 1

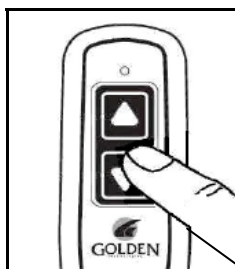

Step 2

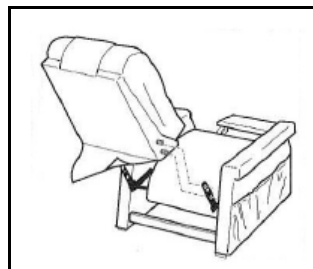

Step 3

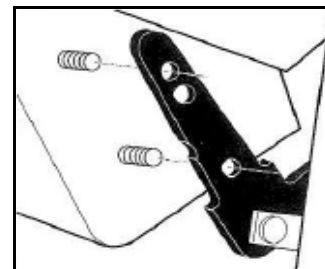

**Step 1.** Plug the lift chair into a standard (115-120VAC) wall outlet.

**Step 2.** Press the down arrow on the hand control until the footrest is about parallel to the floor. This will expose the back brackets at the rear of chair.

**Step 3.** Slide the back down between the brackets until the threaded studs on the back slip thru the holes in the brackets as shown.

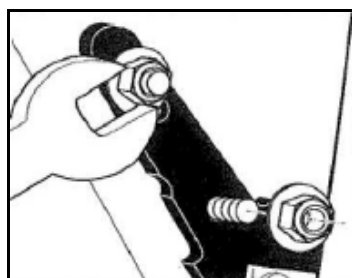

Step 4

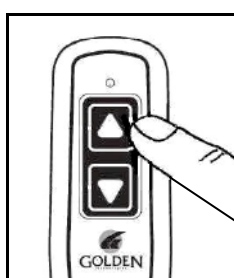

Step 5

**Step 4.** Thread the flange lock nuts onto the studs and tighten securely using the supplied wrench or a 7/16" box wrench. Return the chair to the seated upright position by pressing the up arrow on the hand control.

**Step 5.** Attach the bottom of the outside back to the Velcro on the arm cross rail.

## MaxiComfort Back Installation:

**Models:** PR-756MC, PR-756L, PR-506, PR-505JP, PR-505S, PR-505M, PR-505L, PR-510

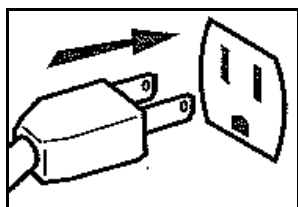

Step 1

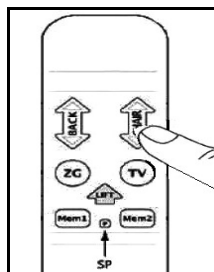

Step 2

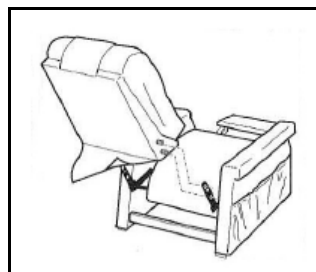

Step 3

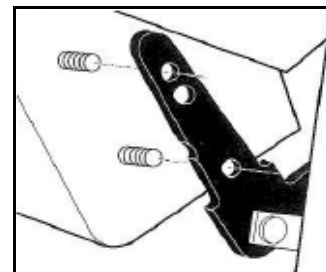

**Step 1.** Plug the lift chair into a standard (115-120VAC) wall outlet.

**Step 2.** Press the chair down arrow on the hand control until the footrest is about parallel to the floor. This will expose the back brackets at the rear of chair.

**Step 3.** Slide the back down between the brackets until the threaded studs on the back slip thru the holes in the brackets as shown.

Hair Pin

Back Recline Bar

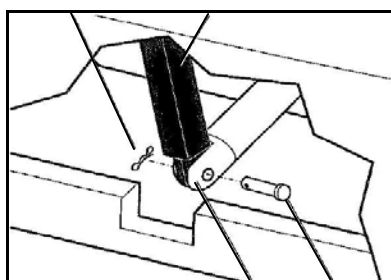

Step 4

Motor Tip Clevis Pin

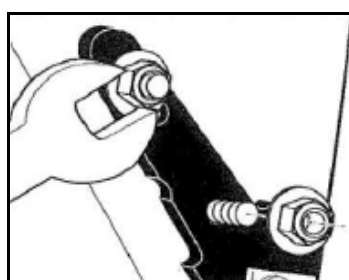

Step 5

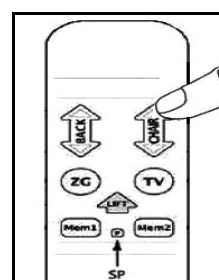

Step 6

**Step 4.** Thread the flange lock nuts onto the studs and tighten securely using the supplied wrench or a 7/16" box wrench.

**Step 5.** Remove the clevis pin from the back recline bar. Insert clevis pin through the hole in the tip and bar. Insert hair pin into the hole at the end of the clevis pin as shown.

**Step 6.** Return the chair to the seated upright position by pressing the chair up arrow on the hand control.

**Step 7.** Attach the bottom of the outside back to the Velcro on the arm cross rail.

## Hand Controls (Lift & Recline)

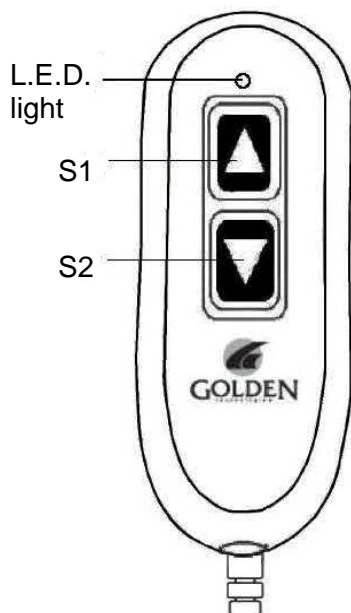

**\*Models:** PR-401, PR-401L, PR-747, PR-643, PR-410, PR-751TY, PR-752, PR-451, PR-906, PR501JP, PR-501S, PR-501M, PR-501L, P5-501T, PR-501S-23, PR-501M-26D, PR-501L-26D, PR-501T-28D, PR-502, PR-200, PR-355M, PR-355L, PR-359M, PR-359L

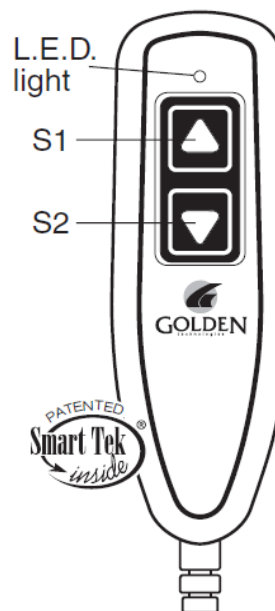

**Models:** PR-401, PR-401L, PR-747, PR-643, PR-410, PR-751TY, PR-752, PR-451, PR-906, PR501JP, PR-501S, PR-501M, PR-501L, P5-501T, PR-501S-23, PR-501M-26D, PR-501L-26D, PR-501T-28D, PR-502, PR-200, PR-355M, PR-355L, PR-359M, PR-359L

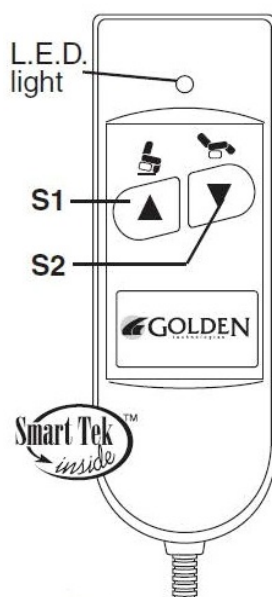

**Models:** PR-401, PR-401L, PR-747, PR-643, PR-410, PR-751TY, PR-752, PR-451, PR-906, PR501JP, PR-501S, PR-501M, PR-501L, P5-501T, PR-501S-23, PR-501M-26D, PR-501L-26D, PR-501T-28D, PR-502, PR-200, PR-355M, PR-355L, PR-359M, PR-359L

**\* Hand Control models currently being used.**

**Note:** For individual switch functions on each hand control, refer to the owner's manuals.

## Hand Controls (Lift & Recline) - Continued

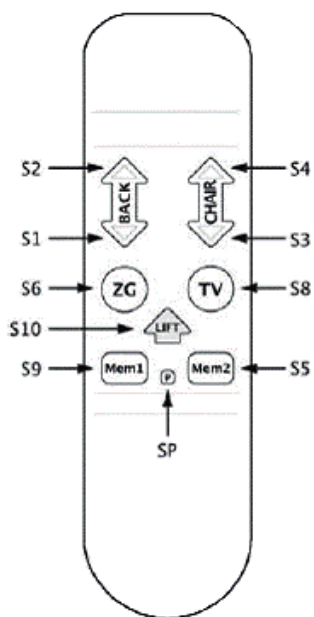

**\*Models:** PR-756MC, PR-756L, PR-505JP, PR-505S, PR-505M, PR-505L, PR-506, PR-510, PR-502

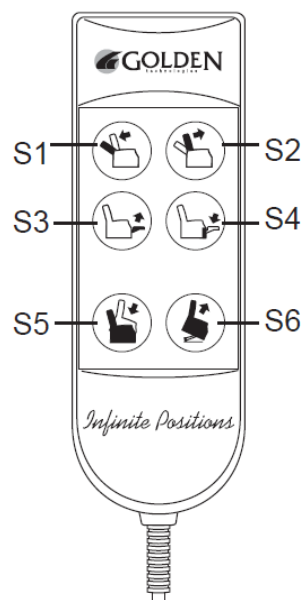

**Models:** PR-756MC, PR-756L, PR-505JP, PR-505S, PR-505M, PR-505L, PR-506, PR-510, PR-502

## Heat & Massage Only - Hand Control

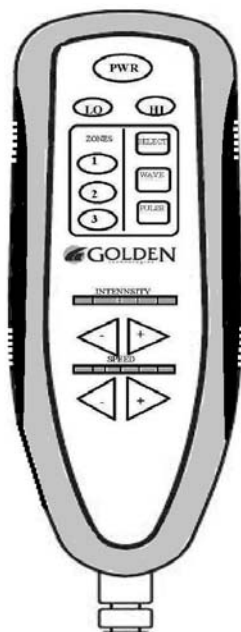

Press PWR to turn On or Off.  
15 Minute Timer: Single Press (**GREEN**)  
30 Minute Timer: Press & Hold (**ORANGE**)

Press LO or HI to turn HEAT ON or OFF.  
Independent 30 Minute Timer.

Press any or all ZONE keys to turn any ZONE On or Off.

Press SELECT, WAVE, or PULSE for desired operating mode.

Press – (Left) to decrease or + (Right) to increase INTENSITY and SPEED.

**\*Models:** All except Capri.



## Far Infrared Heat Only – Hand Control

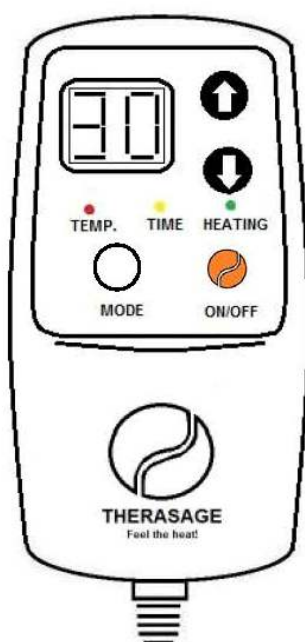

**\*Models:** All with Far Infrared Heat.

- Press ON and the temperature light will turn on. Controller is pre-set to a low/medium heat level and a 60 minute session.
- Once turned ON, it will display the session time and will count down from the pre-set 60 minutes.
- The temperature level can be adjusted by pressing the up or down arrows, up for more heat, down for less heat.
- The time can only be adjusted when the Controller is OFF.
- Use the MODE button to set the time setting.
- Adjust your time by using the up and down arrows press while the time light is on, up to increase time and down to set less time. Adjustments are in 15 minute increments.
- By pressing the MODE button a second time, the display will return to the temperature setting for any future adjustments.
- After setting the desired time and temperature, the system will be ready to use when you press the ON/OFF button. A heater light will indicate that the system is on and working. When your session is complete the light will go off and the controller will display your heat level.
- For your convenience, the controller will default to the previous setting upon your next use. While it is suggested that the preset temperature, the second grade, and 60 minutes' working time is the best choice, you can set the temperature and time in accordance with your own personal demands.
- Finally, the electrical power should be turned off after use.

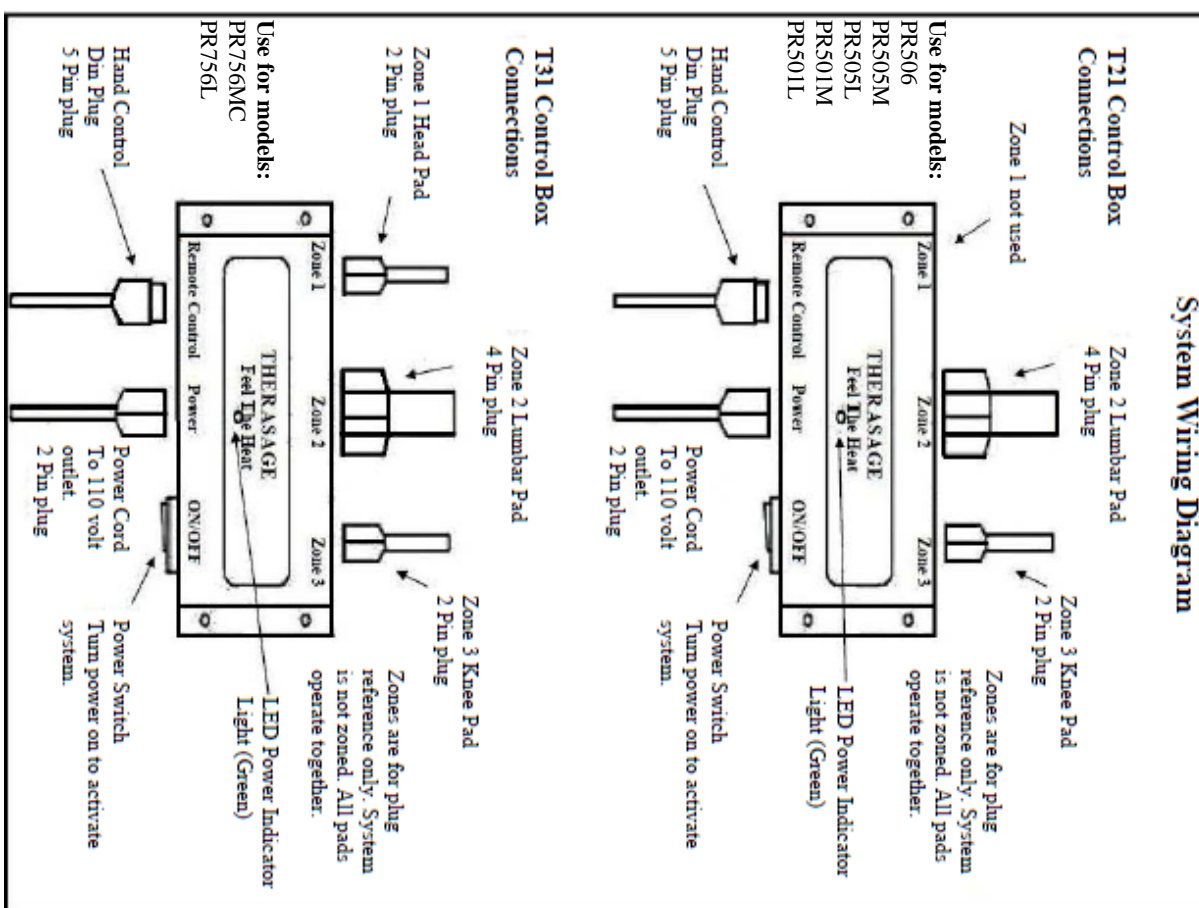

*\* Hand Control models currently being used.*



## Grease Points



**WARNING** Applying any type of lubricant as a routine maintenance procedure is not necessary. If lubricating the lift chair to alleviate excessive noise, only apply the specified lubricant at the locations shown below. Do not apply excessive lubricant. Excessive lubricant could leak onto the chair or the floor causing damage.

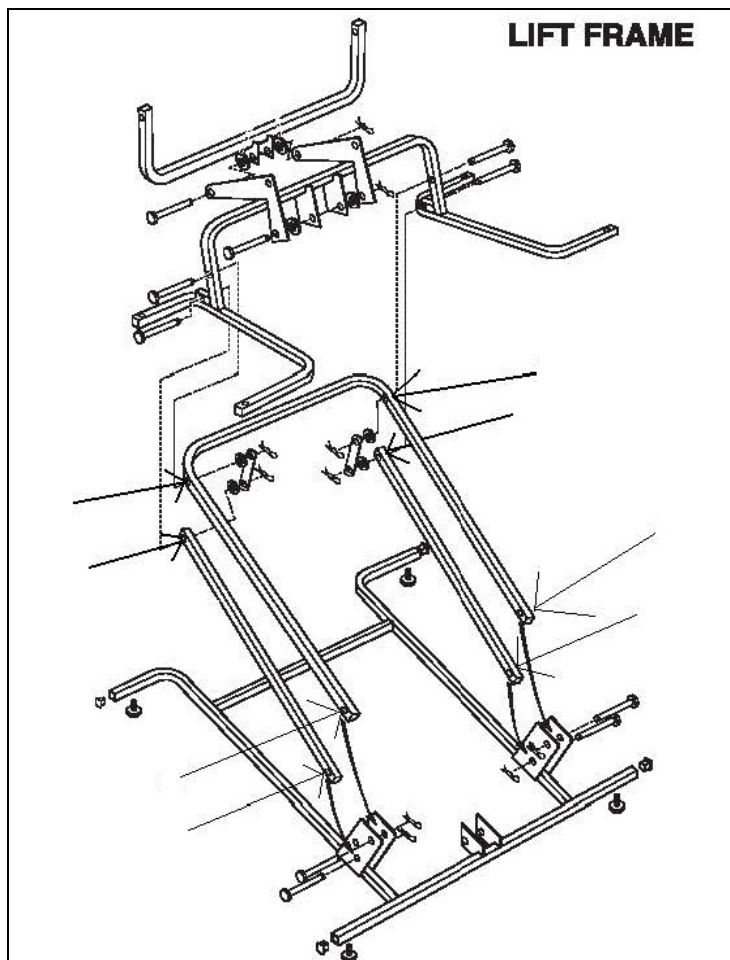

USE WHITE LITHIUM GREASE

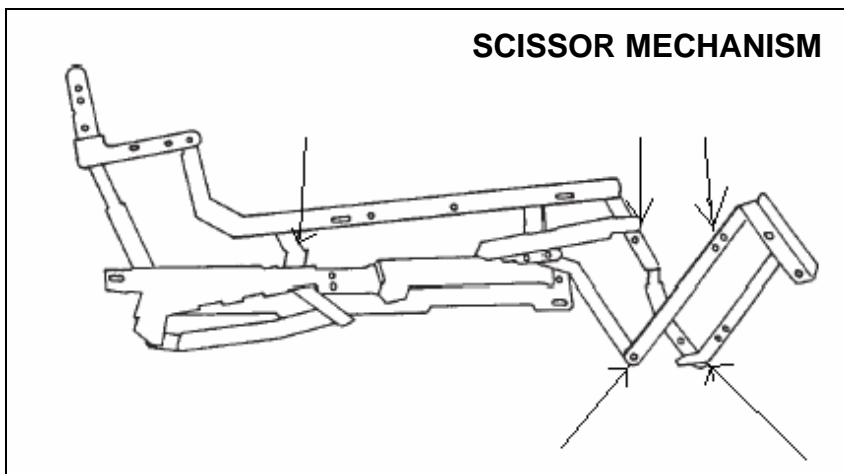

USE ZEP2000

## Lift Chair Cut Away

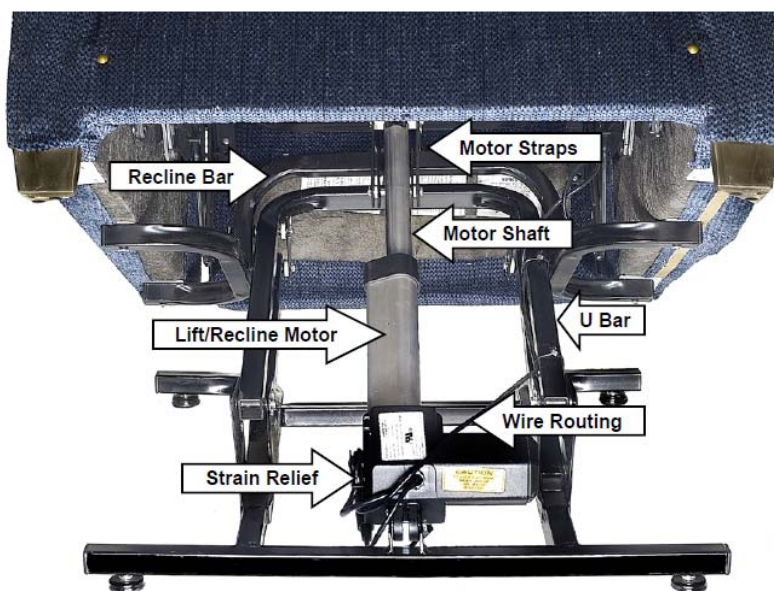

**Bottom View**

*Note: The above illustrations are intended as general information. They do not represent all models in this manual.*

# Assembled Lift Chair Boxing Instructions

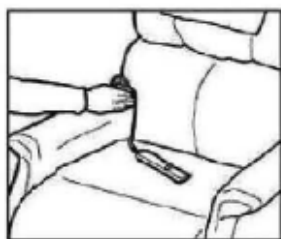

Tuck cord from hand control between arm & back of chair.

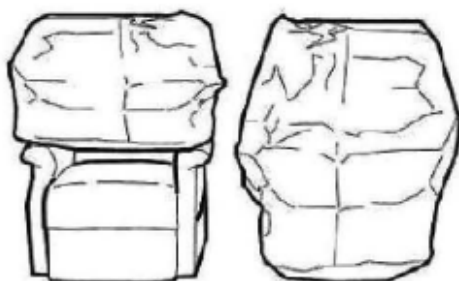

Place bag over chair.

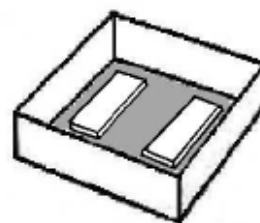

Place bottom tray on floor with foam in opening facing up.

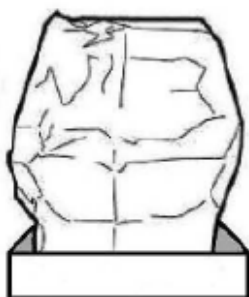

Place chair into bottom tray.

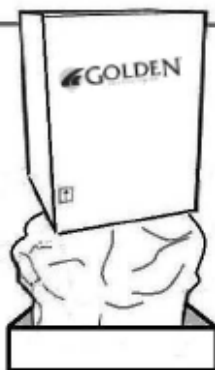

With the Golden Technologies name in the upright position, place the sleeve over the chair and into the bottom tray.



Note: Use approved 3" packaging tape.

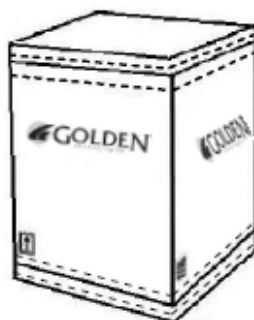

Note: Use approved 3" packaging tape.

Place top tray onto the sleeve with opening facing down, then tape along each edge, 360 degrees around the top and bottom trays as shown.

*Note: Banding can be used in place of tape if available.*

Place bands vertically around top and bottom trays and secure only after all packaging steps are complete.

## Lift Chair Boxing Instructions with Back Off

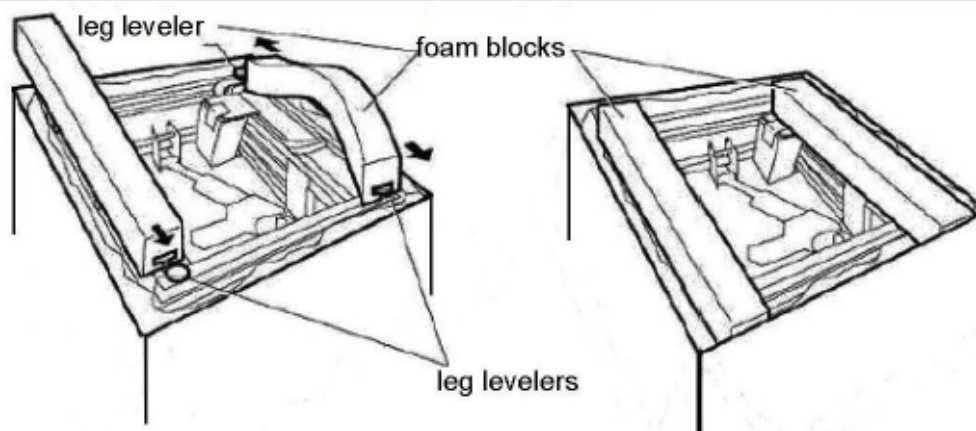
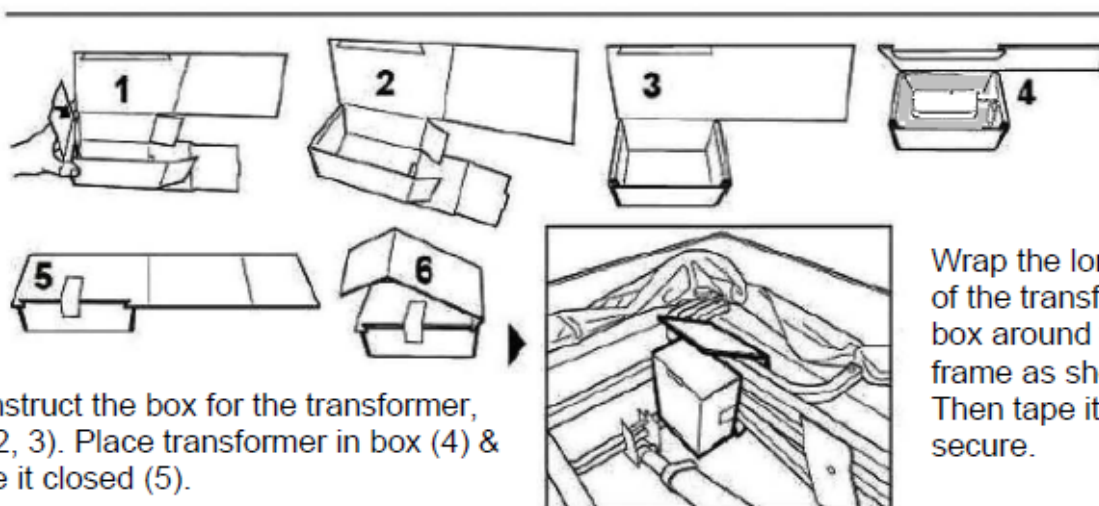

Slide the groove of the foam blocks onto the leg levelers, first onto one, then onto the opposite one, so that the foam is locked into place.

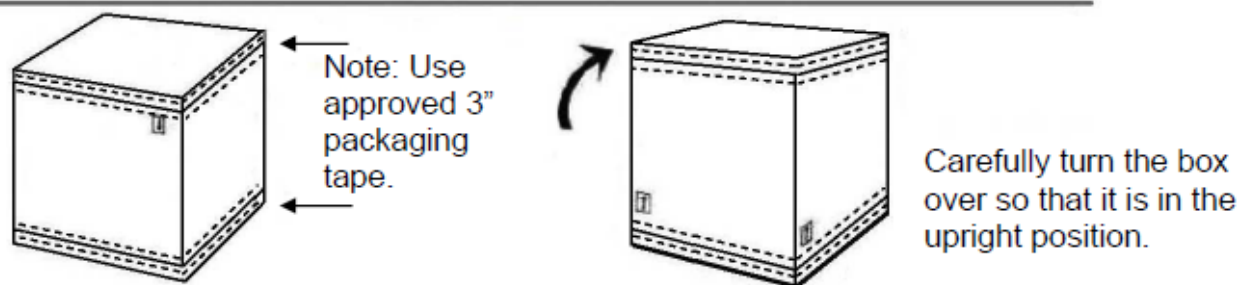

Place the bottom tray onto the sleeve with the opening facing down, then tape along each edge, 360 degrees around the top and bottom trays as shown.

*Note: Banding can be used in place of tape if available.*  
Place bands vertically around top and bottom trays and secure.







## **Lift Chair Service Guide**



Golden Technologies  
401 Bridge Street  
Old Forge, PA 18518  
[www.goldentech.com](http://www.goldentech.com)