

INSTALLATION AND OPERATING INSTRUCTIONS



RANGER™

ADA COMPLIANT POOL LIFT

300 LB. [136 kg] MAXIMUM CAPACITY
MANDATORY – LEAVE THIS MANUAL WITH LIFT OWNER

- READ CAREFULLY-

Check entire box and inside all packing materials for parts. Before beginning assembly, read the instructions and identify parts using the figures and parts listed in this document. It is critical that all parts be carefully inspected by the installer prior to installation to ensure that no damage occurred in transit and that a damaged part is not used. If any damage occurred in transit, Aqua Creek Products, LLC must be notified within three days of receipt of unit. Proper installation cannot be overstressed, as an improper installation voids Aqua Creek's warranty and may affect the safety of the user.



The Total Solution for Pool and Spa Access

9889 GARRYMORE LANE
MISSOULA, MT 59808
1-888-687-3552
FAX: 406-549-2602



WARNING

IMPORTANT SAFETY INSTRUCTIONS

- 1. READ AND FOLLOW ALL INSTRUCTIONS. LIFT SAFETY CAN ONLY BE ENSURED IF THE LIFT IS INSTALLED AND OPERATED PROPERLY – ACCORDING TO THESE INSTRUCTIONS.**
- 2. WARNING- TO REDUCE RISK OF INJURY, DO NOT PERMIT CHILDREN TO USE THIS PRODUCT UNLESS THEY ARE CLOSELY SUPERVISED AT ALL TIMES.**
- 3. WARNING- DO NOT PERMIT CHILDREN TO PLAY ON THIS PRODUCT.**
- 4. WARNING- NEVER APPLY DIRECT WATER PRESSURE TO ELECTRONIC COMPONENTS.**
- 5. DO NOT USE THE RANGER™ LIFT FOR WATER-DRAFTS OVER 12" (DECK TO WATERLINE).**
- 6. NEVER OPERATE THIS LIFT UNDER LOAD WITH NO WATER (DRY POOL).**
- 7. SAVE A COPY OF THESE INSTRUCTIONS.**

RANGER™ POOL LIFT

TABLE OF CONTENTS

<u>PAGE</u>	<u>DESCRIPTION</u>
3	PACKING LIST
4	SITE AND POOL DECK REQUIREMENTS
5-6	CORE-DRILL RETROFIT INSTRUCTIONS
7	SAW-CUT RETROFIT INSTRUCTIONS
8	NEW-CONSTRUCTION INSTRUCTIONS
9	RANGER™ LIFT ASSEMBLY INSTRUCTIONS
10	24V BATTERY OP & INSTALL INSTRUCTIONS
11	BATTERY MAINTENANCE
12	RANGER™ LIFT OPERATING INSTRUCTIONS
13-14	SAFETY & CARE FOR YOUR LIFT
15-17	TROUBLESHOOTING GUIDE
18	RANGER™ PARTS LIST
19	SEAT ASSEMBLY PARTS LIST
20	WARRANTY

THE RANGER™ POOL LIFT

1. RANGER™ POOL LIFT W/ FOOTREST
2. INTEGRATED CONTROL BOX/BATTERY
3. SAFETY BELT
4. HANDSET REMOTE
5. BATTERY CHARGER

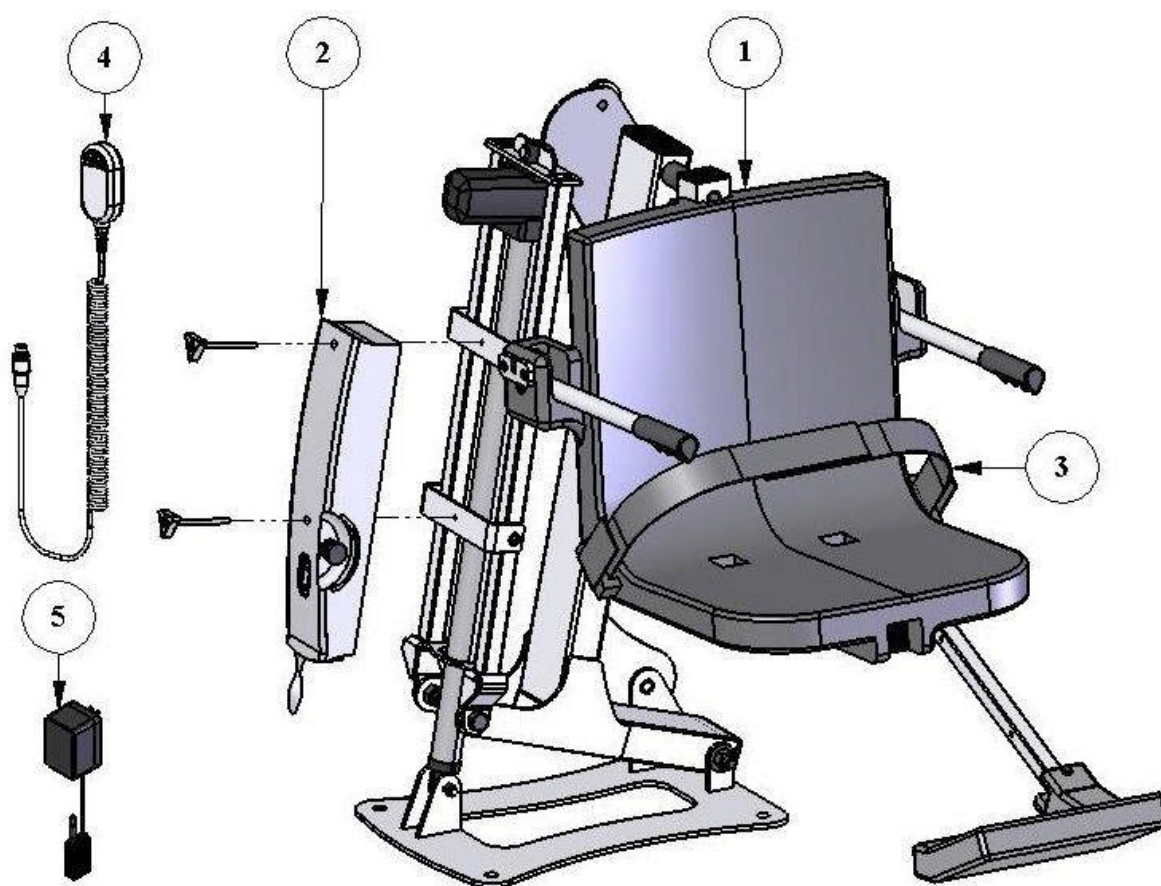

NOTE: The RANGER™ POOL LIFT requires either a concrete anchor system (item F-433PP4A) or an anchor system for wood decks (item F-40220) sold separately.

NOTE: These instructions outline the installation of a standard concrete anchor. Instructions specific to the WOOD DECK anchor are provided with that product.

SITE & POOL DECK REQUIREMENTS

This lift is designed for commercial or residential use on in ground pools and spas. This lift is not designed to clear a wall or obstacle. The lift should be installed on the pool deck where a straight linear section of the pool wall is at least six (6) feet long. The lift should be installed at a pool depth (pool deck to pool floor) of no less than 42" but not more than 48 inches. If the edge of the pool deck curves the anchor system will need to be anchored differently than what these instructions outline; contact Aqua Creek Products for assistance in this case. The front anchors of the lift need to be mounted a maximum of 14 inches and no closer than 4 inches from the inside pool wall. If your pool or spa has hand rails or other extensions on the inside of the pool wall, the set back distance must take these into account. Contact Aqua Creek Products for assistance in these types of applications.

In order to properly install this anchor system into an existing pool deck, your pool deck MUST be at least 3 feet long, by three feet wide and 6 inches thick. It must also be reinforced with #4 rebar on 10 inch centers in both directions. There may be instances where your existing pool deck may not be structurally sound enough or does not meet the minimum requirements outlined above for the safe installation of this anchor system. In those circumstances Aqua Creek recommends that you follow the Saw Cutting Retro-fit Instructions on page 7. If you are installing this lift in a new application where the pool deck has not been poured yet, then go to the New Construction instructions on page 8.

FIGURE 1

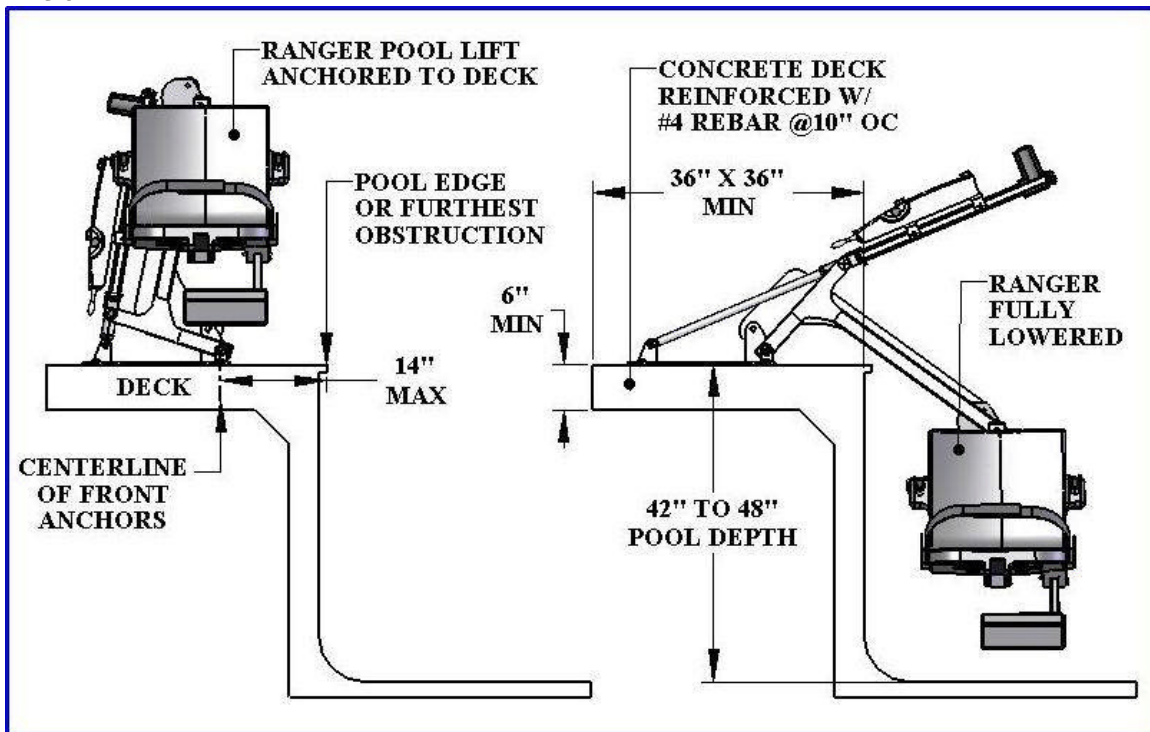

CORE DRILLING RETRO-FIT INSTRUCTIONS

Required Materials & Tools:

- Core drill and 1 1/4" core drill bit
- Tape Measure
- Marking Pen suitable for writing on concrete
- Hammer
- Cold Chisel
- Torpedo Level
- High Strength 2 part construction epoxy*
- Black electrical tape (Optional)
- Masking tape



*Aqua Creek recommends either Hilti™ Brand HIT HY-150 or Simpson™ brand ET22 Strong Tie or equivalent

- 1) Locate the anchor plate, four (4) anchor inserts with nuts and mounting hardware. (Sold separately, part number F-433PP4A - See picture).
- 2) Using the larger holes in the anchor plate as a template, mark the four hole locations with a marking pen on the pool deck. Verify that the **CENTER LINE** of the front anchors are no more than 14 inches from the pools edge. See **FIGURE 1, page 4**.
- 3) Using the core drill and the 1 1/4" core drill bit, drill out the four hole locations marked on the pool deck to a depth of about 4 1/2".
 - a. **NOTE:** You can use black electrical tape on the end of the drill bit as a visual marker to indicate the proper depth that you need to drill to.

FIGURE 2

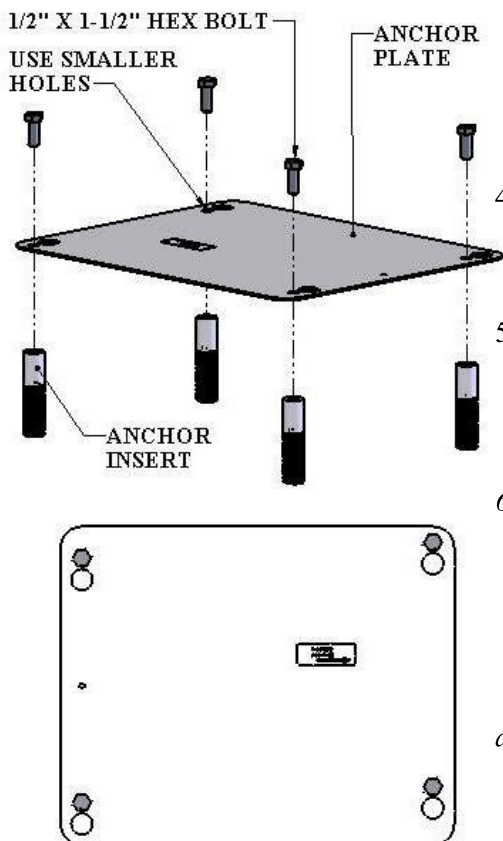

- b. **NOTE:** Depending on your local grounding requirements, you may need to drill one hole larger than the others so that you can ground at least one of the anchor inserts. In some cases saw cutting a portion of the deck out completely might be required. In this case, follow the "Saw Cutting Retro-Fit Instructions".
- 4) Remove the core from the holes using a hammer and chisel. The holes should be completely dry and clear of any debris before installing the anchors into them.
 - 5) Remove the nuts from the threaded anchor inserts and the black protective cover from the end of the anchor insert exposing the internal threads that will accept the mounting hardware.
 - 6) Using the smaller holes in the anchor plate, thread the mounting hardware through the anchor plate holes and into the ends of the four anchor inserts so that the tops of the inserts are flush with the **BOTTOM** of the plate (see diagram on left). **IMPORTANT:** Use the enclosed packet of anti seize on the threads of the hardware to prevent the hardware from seizing in the anchor inserts.
 - a. **NOTE:** It is recommended that you apply tape to the bottom of the anchor plate around the holes so that when and if the two part epoxy oozes out of the holes that it does not secure the anchor plate to the pool deck.

- 7) Allow for a way to ground at least one of the anchor inserts according to your local code requirements.
- 8) Before putting epoxy into the holes and setting the anchor inserts, you will want to test fit the anchor inserts in the pre-drilled holes first to make sure they line up properly. You can do this by picking up the anchor plate with the four (4) anchor inserts attached to the underside and carefully place them into the four holes drilled in the deck. Using a torpedo level on the plate, verify that you can level up the anchor system. If they do not line up you may have to enlarge your holes.
- 9) After verifying that the anchor inserts line up with the holes properly and you can level the anchor assembly, remove the anchor assembly and fill each hole in the pool deck at least half full of two part construction epoxy (not included). *Aqua Creek recommends either Hilti™ Brand HIT HY-150 or Simpson™ brand ET22 Strong Tie or equivalent.*
- 10) Pick up the anchor assembly with the four (4) anchor inserts attached to the underside and carefully place them into the four holes drilled in the deck. As you place the anchor inserts that are attached to the anchor plate, wiggle the anchor system a little to make sure the epoxy gets on all sides of the anchor inserts.
- 11) Once the anchor inserts are placed into the holes, use a small torpedo level on the anchor plate to make sure you are level and plumb.
- 12) Allow the epoxy to set up according to the manufacturers recommendations and remove the hardware and the anchor plate. You can now safely mount the lift to the anchor system using the same hardware you used to mount the anchor inserts to the underside of the anchor plate. The anchor plate can be recycled or used for installing a second set of anchors in another location.

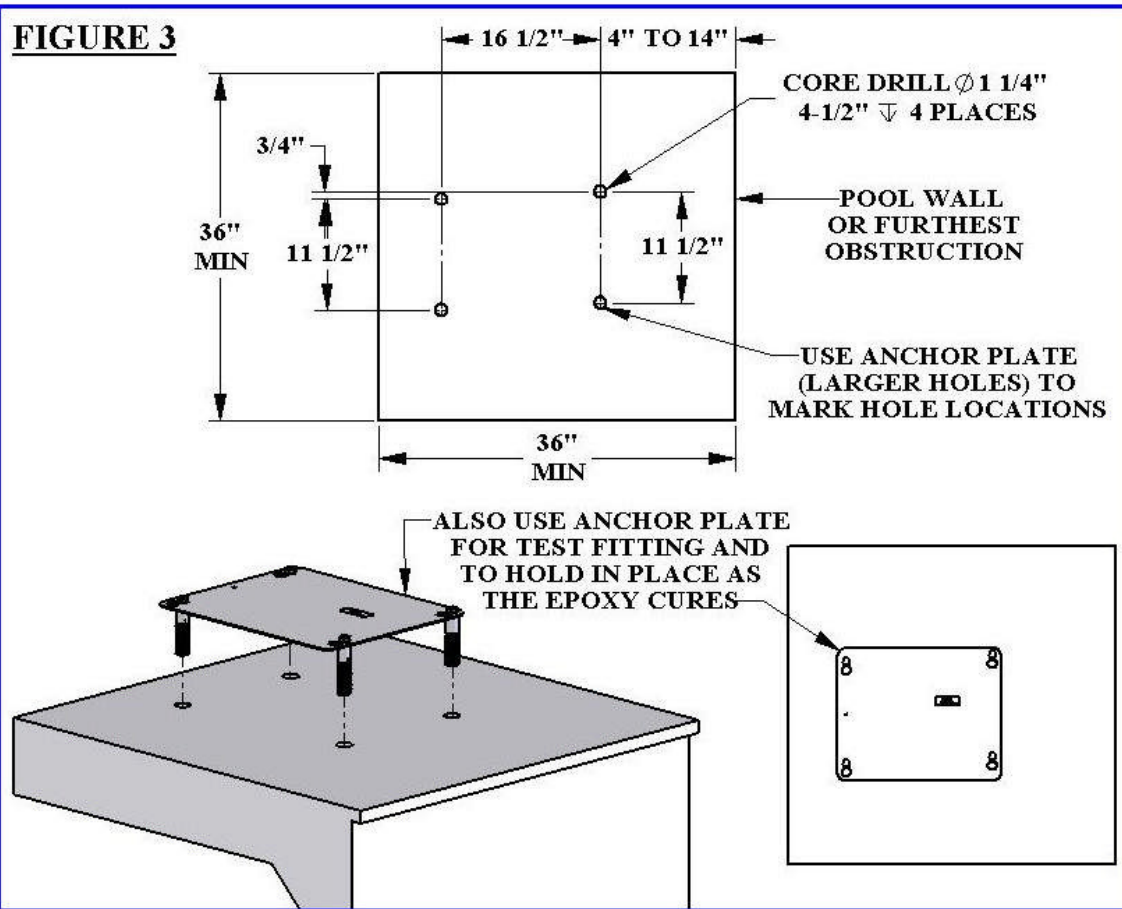

SAW-CUTTING RETRO-FIT INSTRUCTIONS

Required Materials & Tools:

- Concrete saw with Diamond blade
- Tape Measure
- 4' long Straight edge or chalk line
- Sledge Hammer
- Cold Chisel
- Torpedo Level
- Sting line
- Concrete & Concrete tools
- #4 Rebar

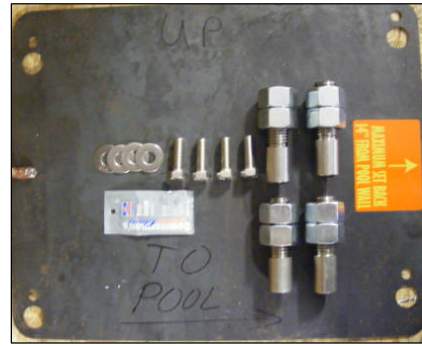

FIGURE 4

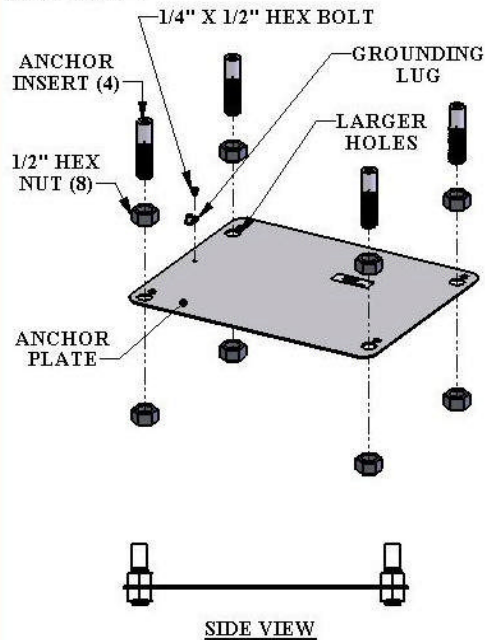
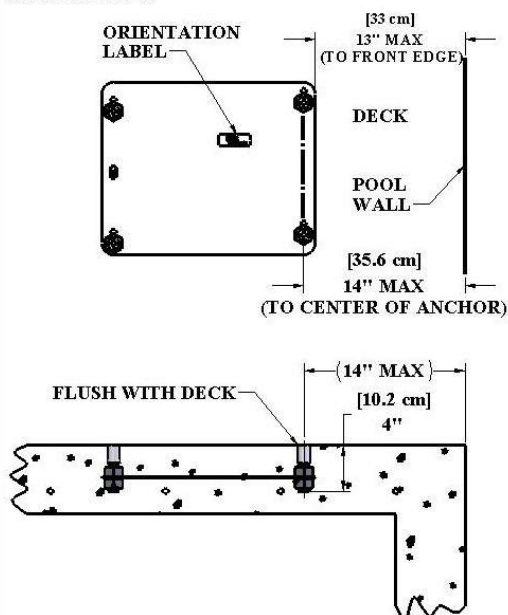

FIGURE 5



- 1) Locate the anchor plate, four (4) anchor inserts with nuts and mounting hardware). (Sold separately from lift, part number F-433PP4A - See picture).
- 2) Mark out a section of the pool deck that you are removing using a chalk line or straight edge and a marker. You should plan on removing at least a Three foot by three foot section.
- 3) Using the saw with the diamond blade, make your cuts along the lines that you marked.
- 4) Using the sledge hammer, break up the concrete within the area that you cut and remove the pieces.
- 5) After you have removed the portion of the deck, verify that your new deck will be able to be at least 6 inches deep.
- 6) Remove ONE of the nuts from each of the anchor inserts and place the anchor inserts through the larger holes in the anchor plate. Thread the nut back on the other side of the anchor insert so that the anchor plate is sandwiched between the nuts. (See diagram on left).
- 7) Install rebar in the open area of the deck. Tie the rebar into the existing deck if possible.
- 8) Set the anchor system in place making sure that the center line of the front anchor inserts are no more than 14 inches away from the pools edge.
- 9) Using the string line or a straight edge, make sure the top of each anchor body is level and flush with the **FINISHED** deck surface. Each anchor body can be adjusted individually by turning the nuts with a large wrench.
- 10) Ground the anchor system using the grounding lug on the anchor plate according to your local code requirements.
- 11) Pour your concrete and finish the pool deck surface.
- 12) Once the concrete has cured, install the lift by aligning the holes in the lifts base with the anchors installed in the deck. Secure the lift to the deck using the stainless steel hardware that comes with it. (See drawing below)
 - a. *NOTE: Use Anti Seize on the hardware to prevent the hardware from seizing in the anchor inserts.*

ANCHOR INSTALLATION: NEW CONSTRUCTION

For installations where a new deck is being poured, or where a dedicated pad is being poured just for the pool lift, the concrete must satisfy the requirements outlined on page 4. For convenience here are the requirements again;

YOUR POOL DECK MUST BE AT LEAST 3-FEET LONG BY 3-FEET WIDE BY 6-INCHES THICK. IT MUST BE REINFORCED WITH #4 REBAR ON 10-INCH CENTERS IN BOTH DIRECTIONS.

Obviously you may make the deck larger than this – which is almost always the case when putting in a deck that surrounds the pool. Note that the entire deck does not need to be 6" thick, but that the area around the installed lift, 3' by 3', should be 6" thick at a minimum. The rest of the deck may be thinner – 4" is typical – as long as it is 6" thick around the lift.

The entire deck should be reinforced with #4 rebar on 10" centers in both directions, which is also common for this type of structure. Our minimum requirement is that the 3' by 3' section be reinforced accordingly, but it is good practice to extend the rebar grid over the entire deck. Commonly, the rebar grid is used for grounding/bonding also. Grounding of the lift can usually be accomplished with a length of bare, solid, copper wire, 14 or 16GA, wrapped tightly around a piece of the rebar and then connected to the grounding lug on the anchor plate. Note that this is only effective when the rebar grid itself has been grounded.

CHECK YOUR LOCAL ELECTRICAL CODE: GROUNDING REQUIREMENTS FOR POOL EQUIPMENT. ALWAYS GROUND THE UNIT PER LOCAL ELECTRICAL CODES.

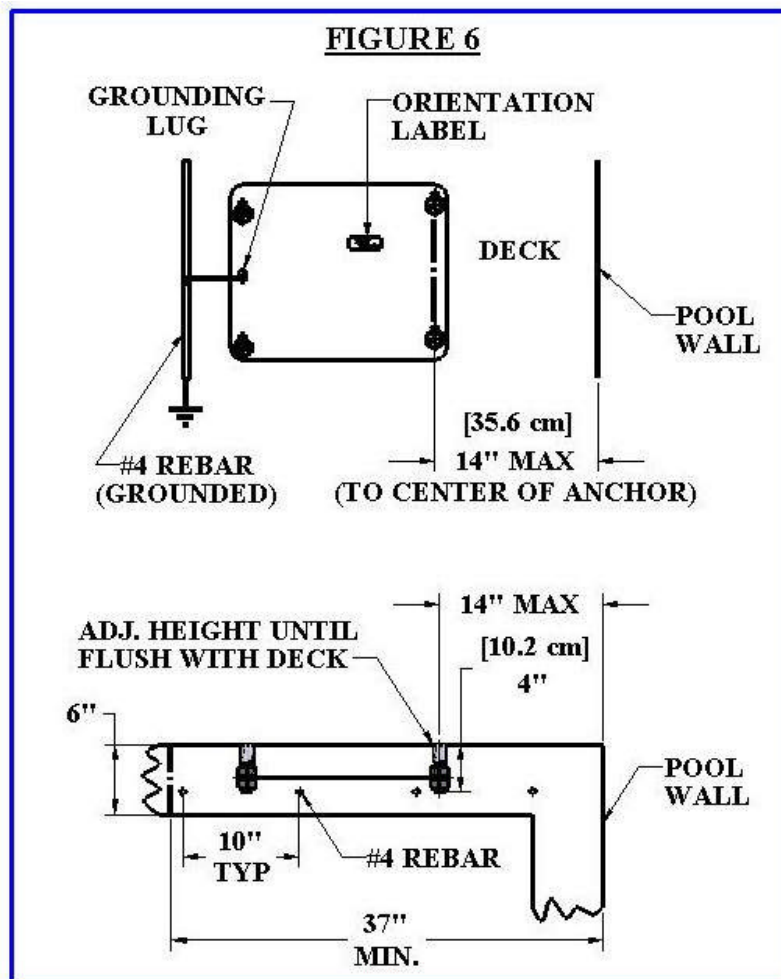

RANGER™ POOL LIFT - ASSEMBLY INSTRUCTIONS

1. Attach seat belt as shown in FIGURE 7.
2. Install the RANGER™ pool lift onto the four (4) anchors using 1/2 x 1-1/2" stainless steel hex-head bolts and 1/2" stainless steel flat washers. Make sure all bolts are tight before using the lift. (FIGURE 9)
3. Before installing the integrated unit, plug it into the charger and let it charge for 24 hours. Make sure the orange "charge" light illuminates when the battery is being charged.
4. Unplug the integrated unit from the charger and install it as shown in FIGURE 9. Tighten the wing-bolts until snug.
5. Plug the handset cable into the left socket on the bottom of the integrated control box. Also plug the actuator cable into CH1, as shown in FIGURE 8. Be sure you press the cord ends firmly into the sockets until you are sure they are all of the way into the sockets, or else the lift will not operate properly.

FIGURE 7

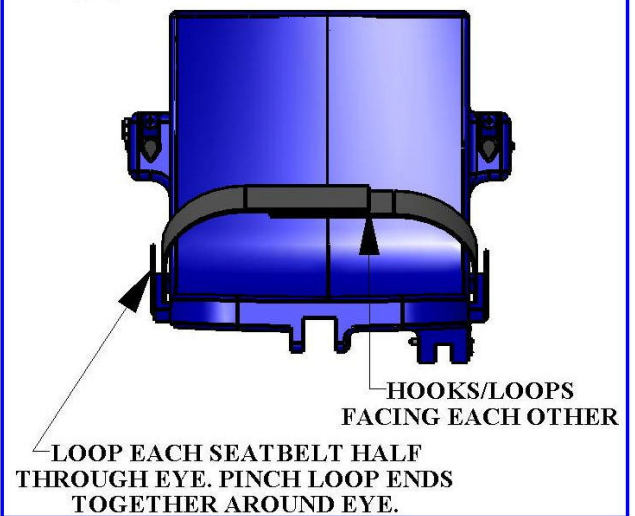

WHEN LIFT IS NOT IN USE REMOVE THE CONTROL UNIT AND PLUG IT INTO THE CHARGER. DO NOT LEAVE IT ON THE LIFT WHEN NOT IN USE!

FIGURE 8

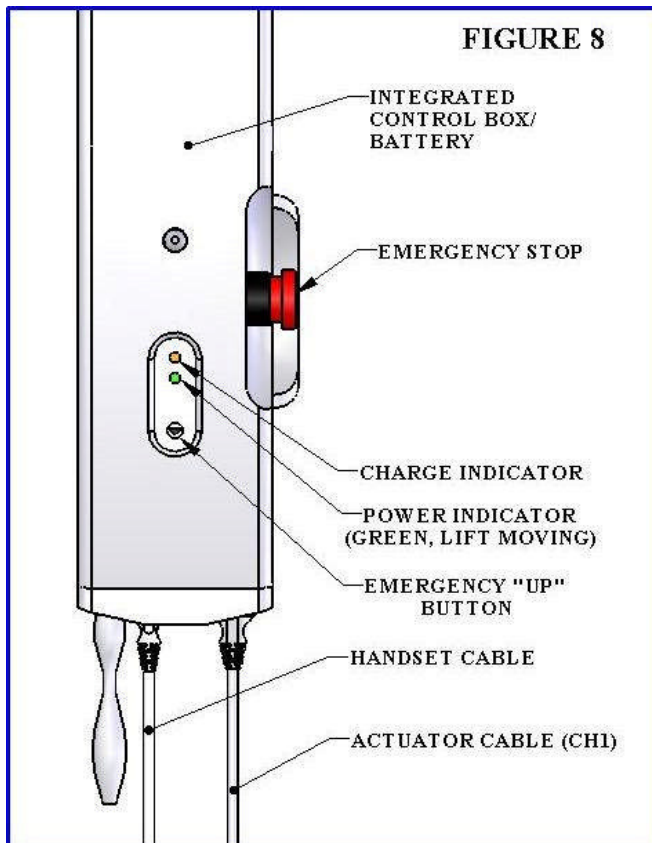
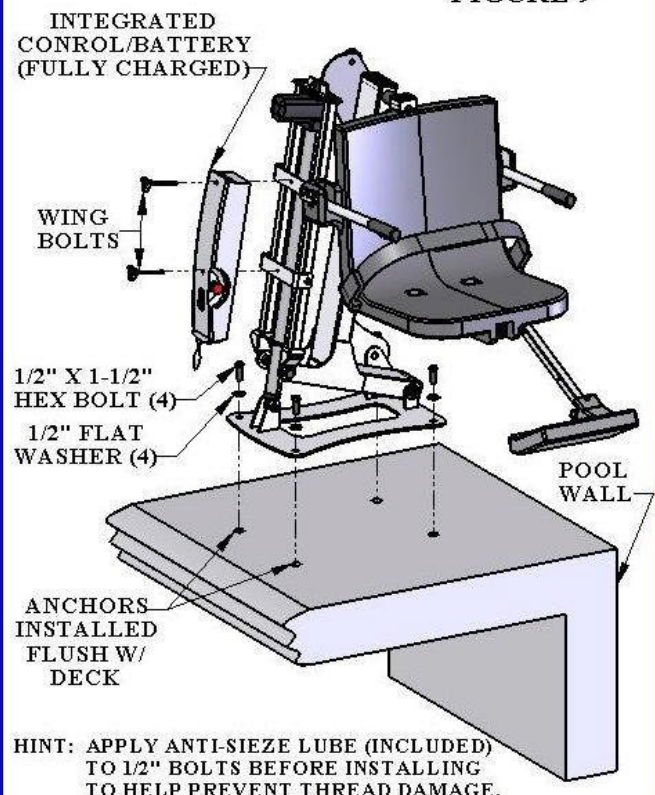

FIGURE 9



WARNING

MAKE SURE THE AREA AROUND THE RANGER™ LIFT IS CLEAR BEFORE OPERATING. NEVER OPERATE THE LIFT WITH ANY PERSON WITHIN THE OPERATING RANGE OF THE LIFT, INCLUDING ON THE DECK OR IN THE WATER. NEVER MOVE THE LIFT DOWN WHILE OVER THE DECK. IF THE LIFT COMES INTO CONTACT WITH THE DECK OR A WALL, RELEASE THE BUTTON IMMEDIATELY OR PRESS THE EMERGENCY STOP BUTTON. DO NOT ALLOW CHILDREN TO OPERATE THE LIFT WITHOUT SUPERVISION. DO NOT ALLOW CHILDREN TO PLAY ON OR AROUND THE LIFT AT ANY TIME.

CHECK ALL NUTS AND BOLTS FOR TIGHTNESS AND FOR WORN PARTS BEFORE EACH USE.

USING THE “EMERGENCY STOP BUTTON”

On the side of the integrated control box is a large red button. If you depress the “EMERGENCY STOP” button, this will bypass the handset and stop the lift. The button will lock in place until released. To release the EMERGENCY STOP button and resume operation, turn the button counter-clockwise until it pops out.



THE LIFT WILL NOT FUNCTION AGAIN UNTIL THE EMERGENCY STOP BUTTON IS RELEASED!!

CHARGING THE BATTERY:

Before using the RANGER™ Lift for the first time the 24V INTEGRATED CONTROL BOX must be fully charged. This will take about 24 hours on the charger. It is also recommended that the battery be fully charged before each use. **DO NOT LEAVE IT ON THE LIFT!!!**

To recharge the battery, unplug all cables and remove the INTEGRATED CONTROL BOX from the lift. Plug the INTEGRATED CONTROL BOX into the charger as shown. When the charger is plugged in the orange **CHARGE** light will flash. When the battery is fully charged, the **CHARGE** light will **stay on** and the device is ready to use.

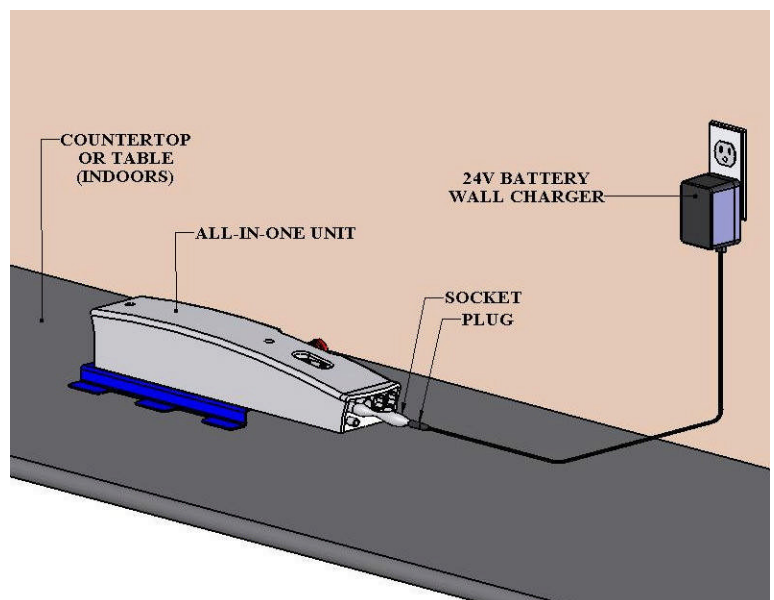

WARNING! MAKE SURE THE EMERGENCY STOP BUTTON IS NOT DEPRESSED OR THE UNIT WILL NOT CHARGE!